

COVERED BY

UNITED STATES
DEPARTMENT OF THE INTERIOR
GEOLOGICAL SURVEY

RUGBY NW QUADRANGLE
NORTH DAKOTA—PIERCE CO.
7.5 MINUTE SERIES (TOPOGRAPHIC)

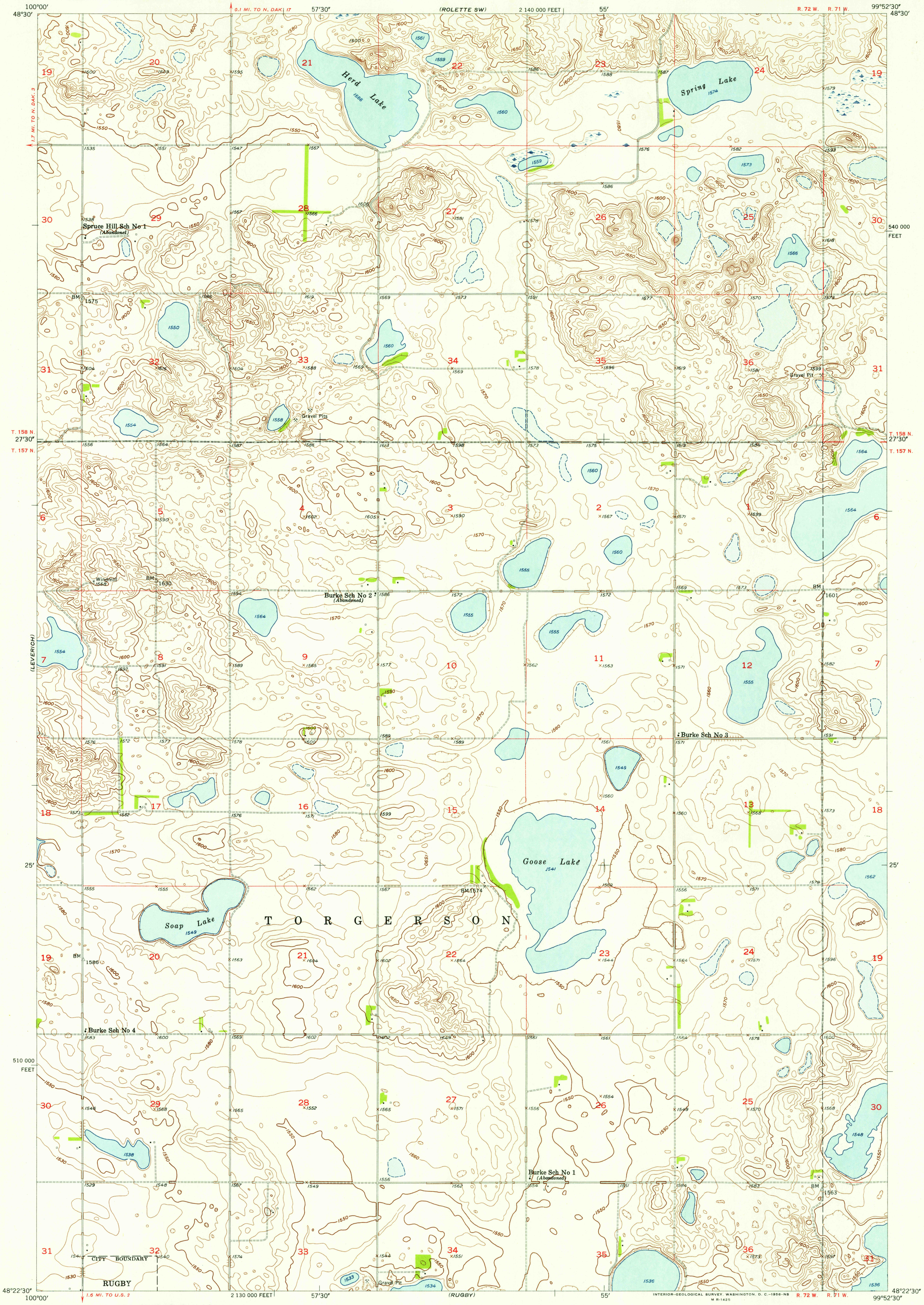

U.S.G.S.
FILE COPY
TOPOGRAPHIC DIVISION

TUNNIPIDGE

Mapped, edited, and published by the Geological Survey as part of the Department of the Interior program for the development of the Missouri River Basin. Control by USGS and USC&GS. Culture and drainage in part compiled from aerial photographs taken 1951. Topography by planetable surveys 1954. Polyconic projection. 1927 North American datum. 10,000-foot grid based on North Dakota coordinate system, north zone.

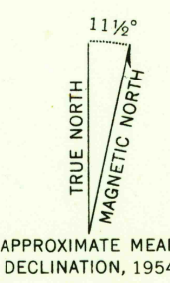

APPROXIMATE MEAN DECLINATION, 1954

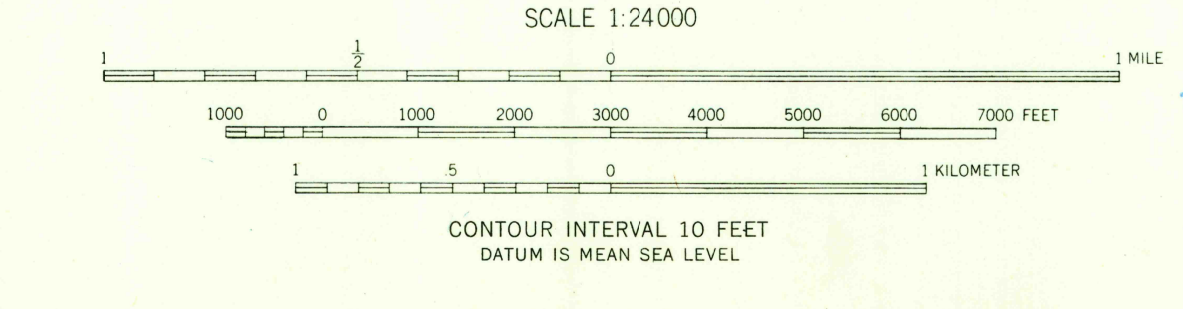

USGS
Historical File
Topographic Division

ROAD CLASSIFICATION

- heavy-duty
- Light-duty
- Medium-duty
- Unimproved dirt
- U. S. Route
- State Route

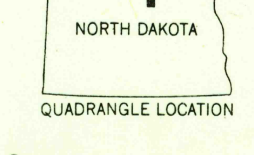

RUGBY NW, N. DAK.
N4822.5-W9952.5/7.5

U.S.G.S.
FILE COPY
TOPOGRAPHIC DIVISION

THIS MAP COMPLIES WITH NATIONAL MAP ACCURACY STANDARDS
FOR SALE BY U. S. GEOLOGICAL SURVEY, FEDERAL CENTER, DENVER COLORADO OR WASHINGTON 25, D. C.
AND BY THE STATE WATER CONSERVATION COMMISSION, BISMARCK, NORTH DAKOTA
A FOLDER DESCRIBING TOPOGRAPHIC MAPS AND SYMBOLS IS AVAILABLE ON REQUEST

1954

MAR 23 1956

2130