

6281 IV NE
(SARLES SE)

UNITED STATES
DEPARTMENT OF THE INTERIOR
GEOLOGICAL SURVEY

SARLES SE QUADRANGLE
NORTH DAKOTA—CAVALIER CO
7.5 MINUTE SERIES (TOPOGRAPHIC)

6281 IV NE
(SARLES SE)

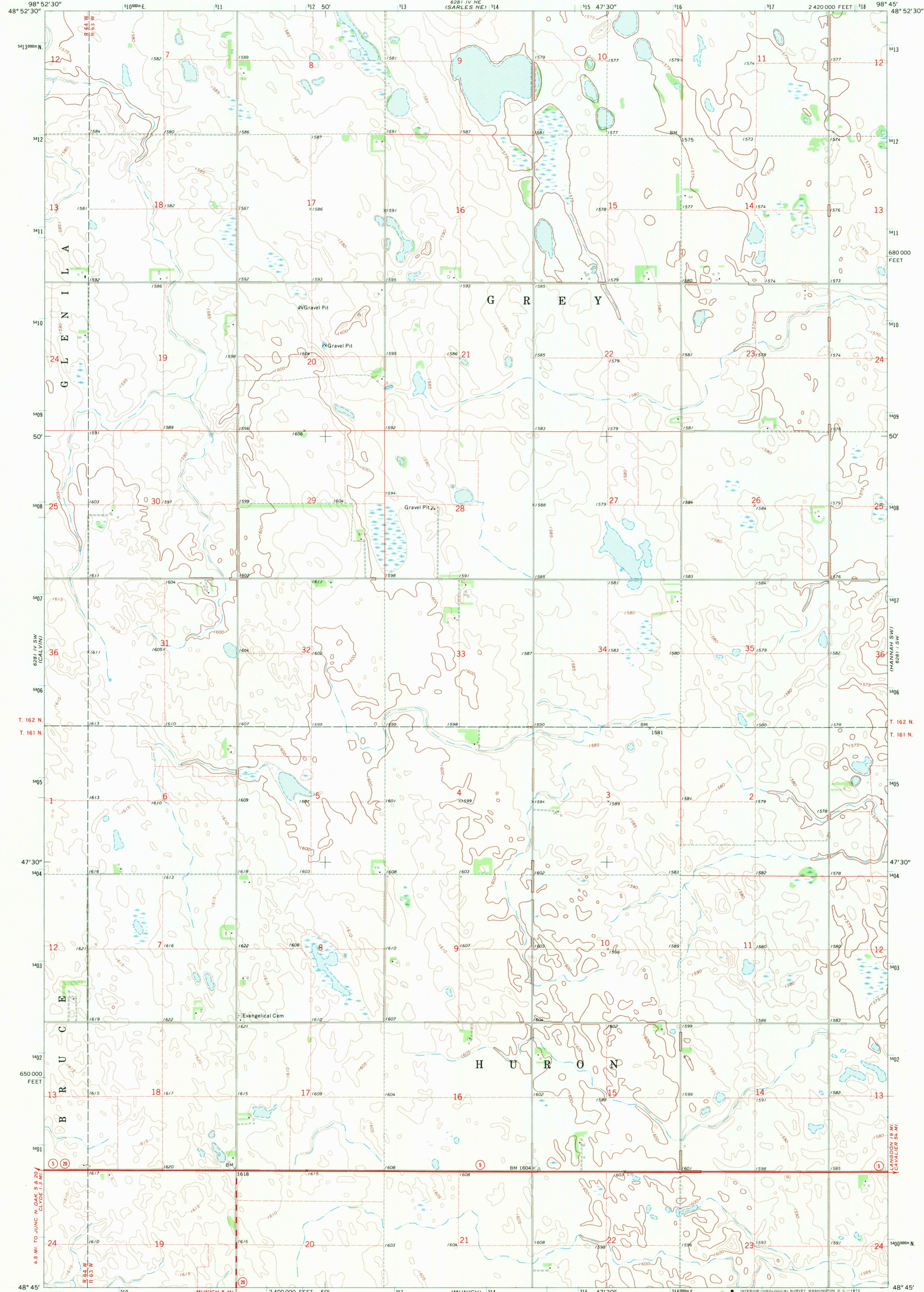

6281 IV SW
(SARLES SE)

Mapped, edited, and published by the Geological Survey

Control by USGS and USC&GS

Topography by photogrammetric methods from aerial photographs taken 1967. Field checked 1970

Polyconic projection. 1927 North American datum

10,000-foot grid based on North Dakota coordinate system, north zone

1000-meter Universal Transverse Mercator grid ticks, zone 14, shown in blue

Five red dashed lines indicate selected fence and field lines where generally visible on aerial photographs

This information is unchecked

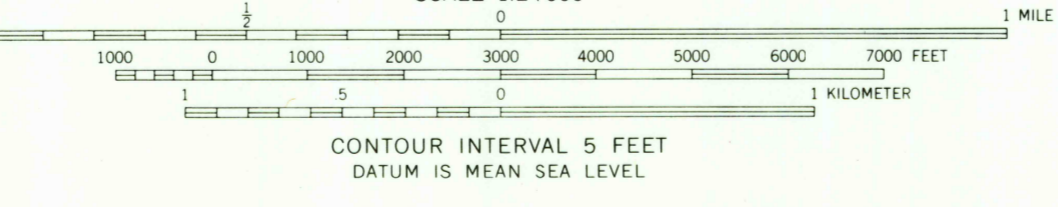
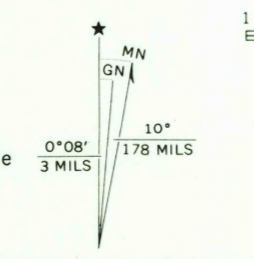

CONTOUR INTERVAL 5 FEET
DATUM IS MEAN SEA LEVEL



ROAD CLASSIFICATION

Primary highway, hard surface	Light-duty road, hard or improved surface
Secondary highway, hard surface	Unimproved road
Interstate Route	U. S. Route
	State Route

THIS MAP COMPLIES WITH NATIONAL MAP ACCURACY STANDARDS
FOR SALE BY U. S. GEOLOGICAL SURVEY, DENVER, COLORADO 80225, OR WASHINGTON, D. C. 20242
AND BY THE STATE WATER COMMISSION, BISMARCK, NORTH DAKOTA 58501
A FOLDER DESCRIBING TOPOGRAPHIC MAPS AND SYMBOLS IS AVAILABLE ON REQUEST

SARLES SE, N. DAK.
N4845—W9845/7.5
1970

USGS
HISTORICAL FILE
TOPOGRAPHIC DATA

JUL 14 1972

2070

AMS 6281 IV SE—SERIES V871