

5780 N.W. (SURREY)  
5780 N.W. (SURREY)  
5780 N.W. (SURREY)

UNITED STATES  
DEPARTMENT OF THE INTERIOR  
GEOLOGICAL SURVEY



SAWYER NE QUADRANGLE  
NORTH DAKOTA  
7.5 MINUTE SERIES (TOPOGRAPHIC)  
NE/4 SAWYER 15' QUADRANGLE

5780 N.W. (SURREY)  
5780 N.W. (SURREY)  
5780 N.W. (SURREY)

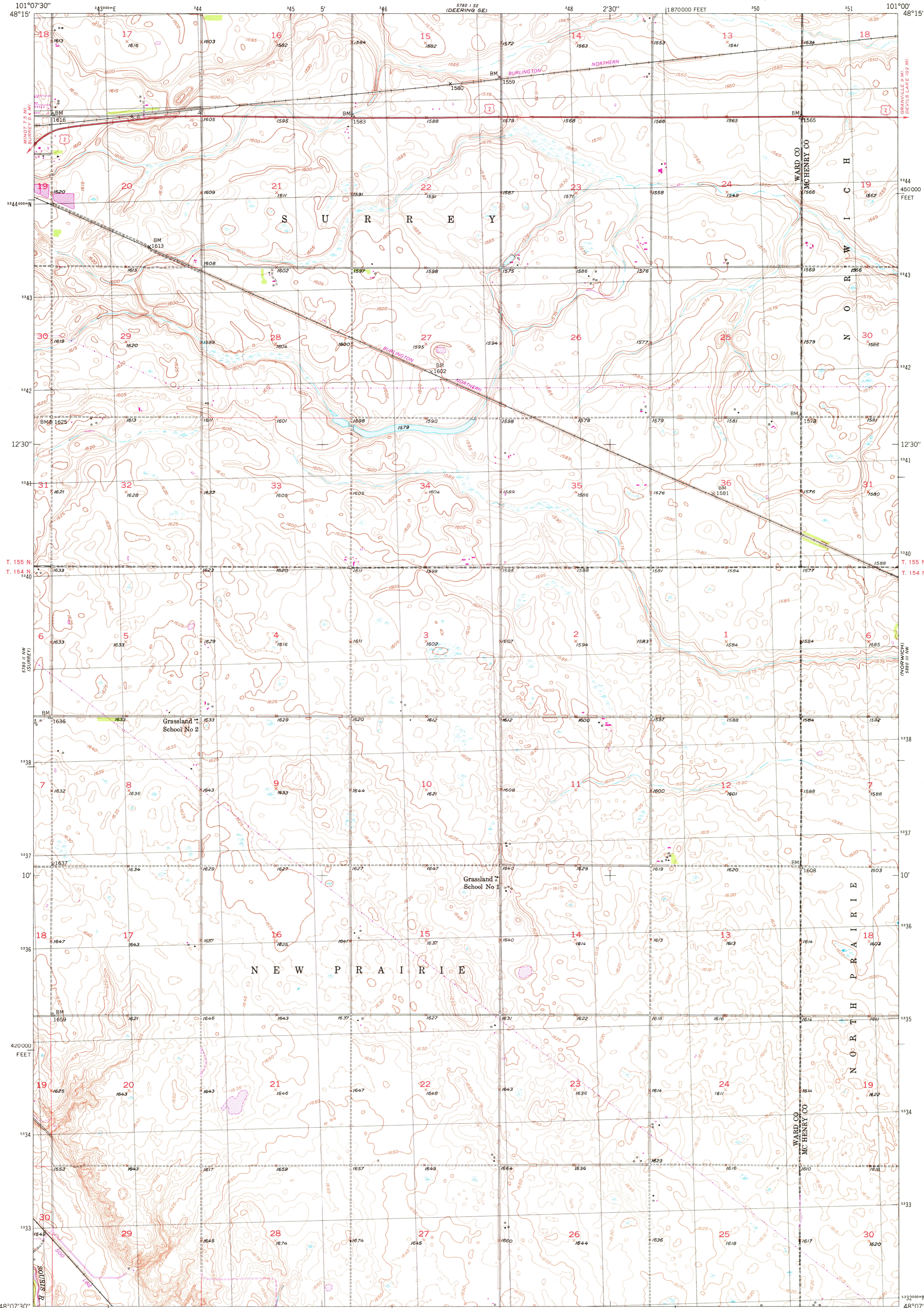

5780 N.W. (SURREY)  
5780 N.W. (SURREY)  
5780 N.W. (SURREY)

Mapped, edited, and published by the Geological Survey as part of the Department of the Interior program for the development of the Missouri River Basin Control by USGS and USC&GS  
Culture and drainage in part compiled from aerial photographs taken 1938  
Topography by plane-table methods 1948  
Polyconic projection. 1927 North American datum 10,000-foot grid based on North Dakota coordinate system, north zone  
1000 meter Universal Transverse Mercator grid, zone 14  
Revisions shown in purple and woodland compiled from aerial photographs taken 1977 and other source data  
This information not field checked. Map edited 1979

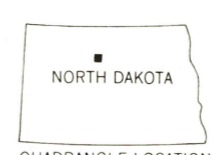
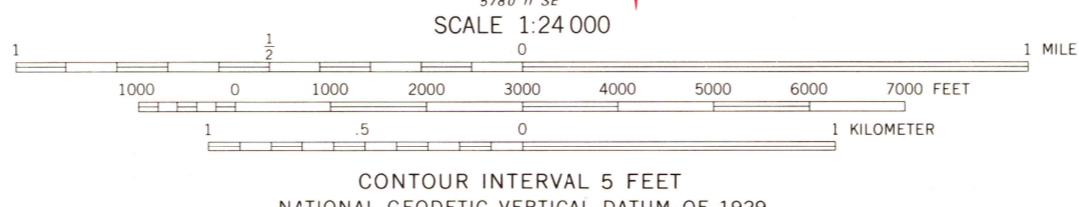
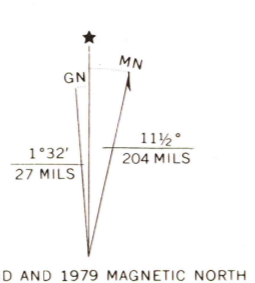

ROAD CLASSIFICATION

Primary highway, all weather, hard surface	Light-duty road, all weather, improved surface
Secondary highway, all weather, hard surface	Unimproved road, fair or dry weather

○ Interstate Route    □ U. S. Route    ○ State Route

SAWYER NE, N. DAK.  
NE/4 SAWYER 15' QUADRANGLE  
N4807.5-W10100/7.5

USGS  
Historical File  
Topographic Division  
EDITION OF 1949  
PHOTOREVISED 1979  
AMS 5780 II NE-SERIES V871

APR 16 1980

1100