

59° 18' 30" N  
100° 22' 30" W  
(WING SW)

59° 18' 30" N  
100° 15' 00" W  
(WING NE)

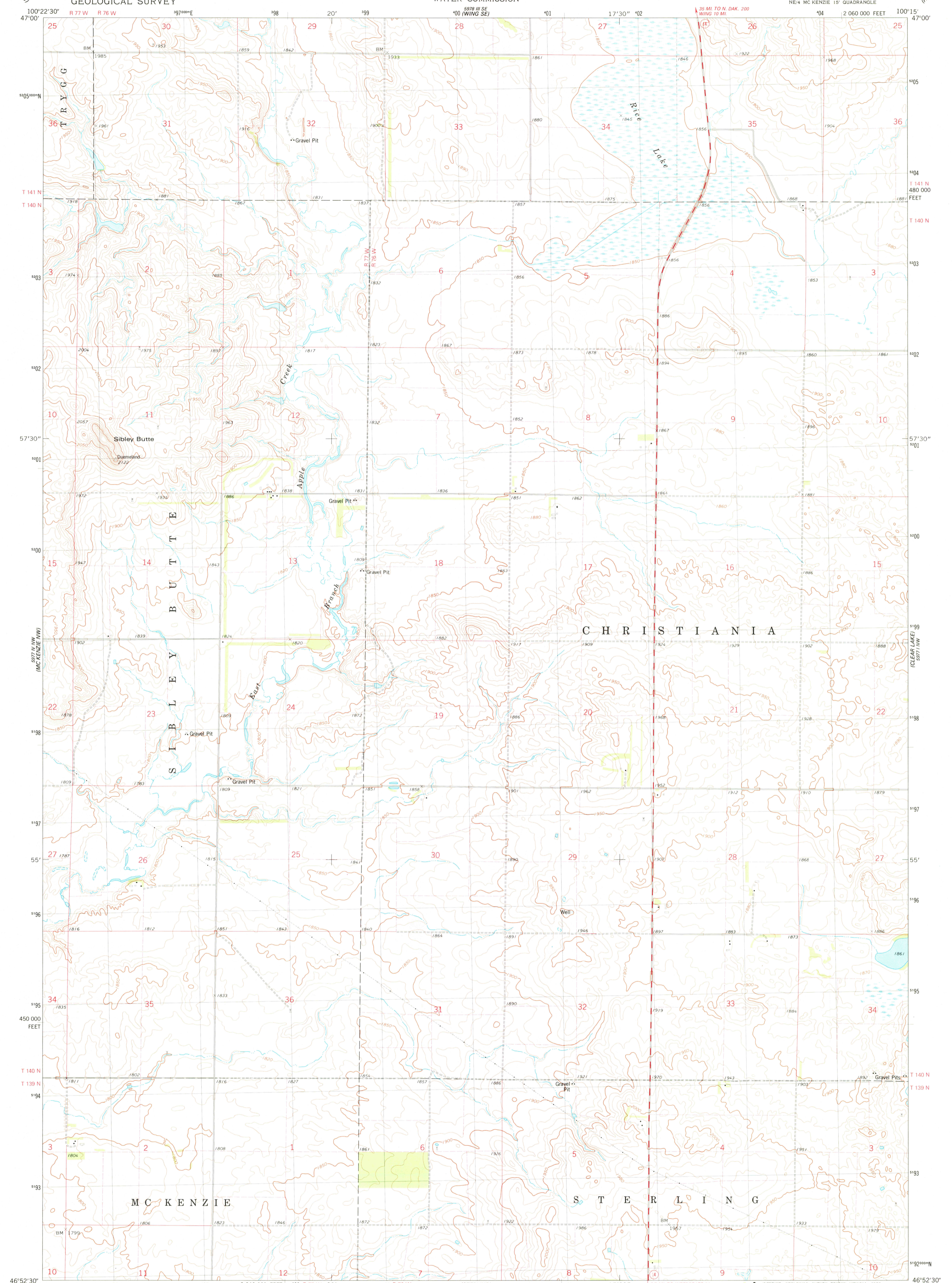

Mapped, edited, and published by the Geological Survey in cooperation with the North Dakota Water Commission. Control by USGS and NOS/NOAA. Topography by photogrammetric methods from aerial photographs taken 1974. Field checked 1975. Projection and 10,000-foot grid ticks: North Dakota coordinate system, south zone (Lambert conformal conic). 1000-metre Universal Transverse Mercator grid zone 14. 1927 North American datum. Fine red dashed lines indicate selected fence and field lines where generally visible on aerial photographs. This information is unchecked.

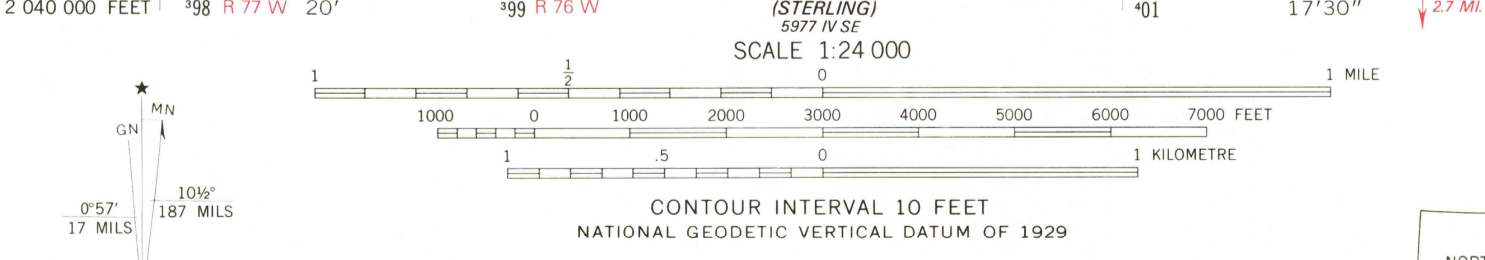

ROAD CLASSIFICATION

Primary highway, hard surface	Light-duty road, hard or improved surface
Secondary highway, hard surface	Unimproved road
Interstate Route	U. S. Route
	State Route

UTM GRID AND 1975 MAGNETIC NORTH DECLINATION AT CENTER OF SHEET

THIS MAP COMPLIES WITH NATIONAL MAP ACCURACY STANDARDS FOR SALE BY U. S. GEOLOGICAL SURVEY, DENVER, COLORADO 80225, OR RESTON, VIRGINIA 22092 AND BY THE STATE WATER COMMISSION, BISMARCK, NORTH DAKOTA 58501. A FOLDER DESCRIBING TOPOGRAPHIC MAPS AND SYMBOLS IS AVAILABLE ON REQUEST.

USGS  
Historical File  
Topographic Division

SIBLEY BUTTE, N. DAK.  
NE 1/4 MC KENZIE 15' QUADRANGLE  
N4652.5-W10015/7.5  
1975  
AMS 5977 IV NE—SERIES V871

2800  
OCT 18 1977