

(BENTON)

UNITED STATES  
DEPARTMENT OF THE INTERIOR  
GEOLOGICAL SURVEY

U. S. G. S.  
FILE COPY  
Inspection and Editing.

TOWNER QUADRANGLE  
NORTH DAKOTA-MC HENRY CO.  
7.5 MINUTE SERIES (TOPOGRAPHIC)

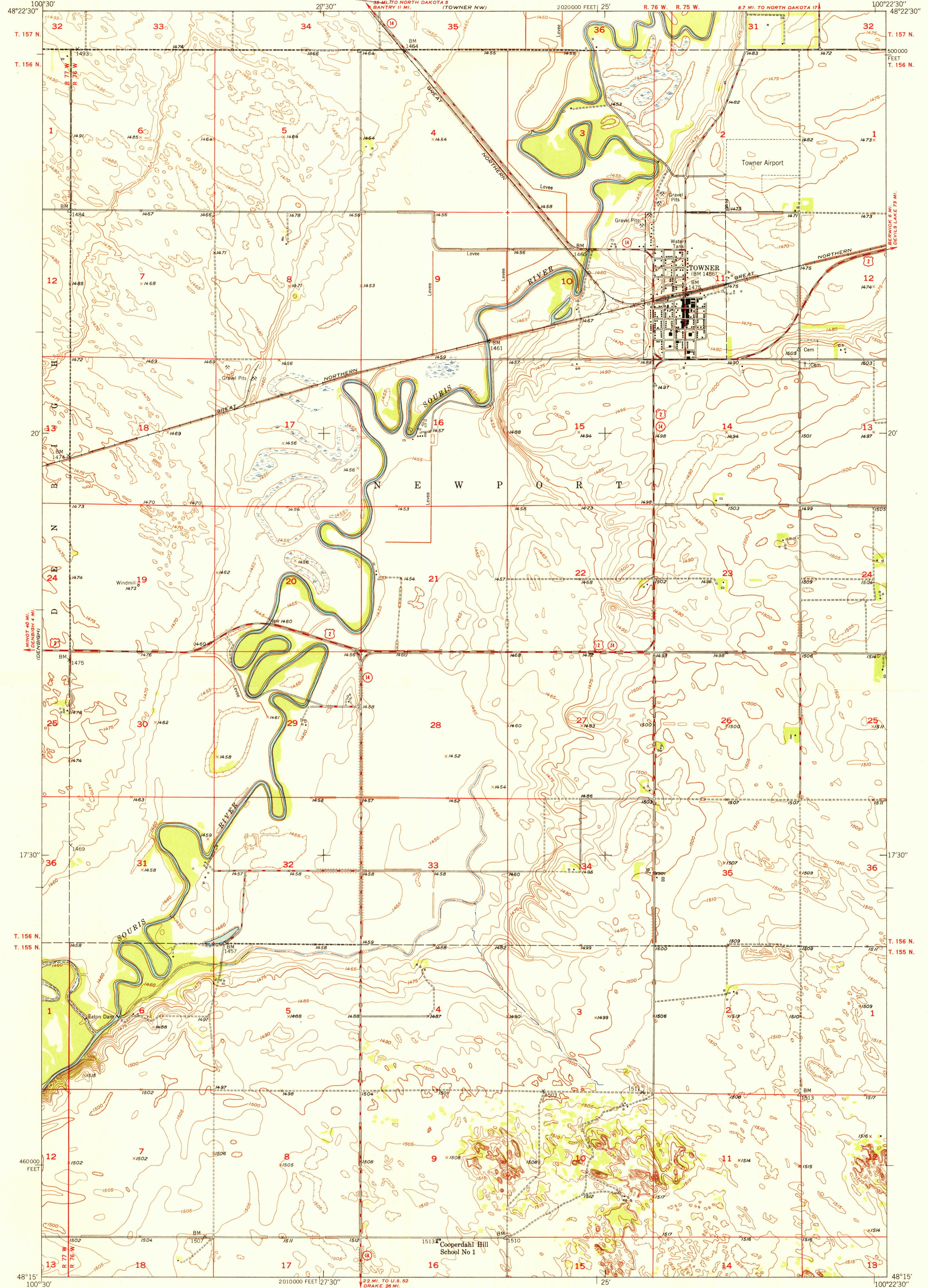

Maped, edited, and published by the Geological Survey as part of the Department of the Interior program for the development of the Missouri River Basin Control by USGS and USCGS  
Culture and drainages in part compiled from aerial photographs taken 1949  
Topography by plane-table methods 1949  
Polyconic projection. 1927 North American datum  
10,000-foot grid based on North Dakota coordinate system, north zone

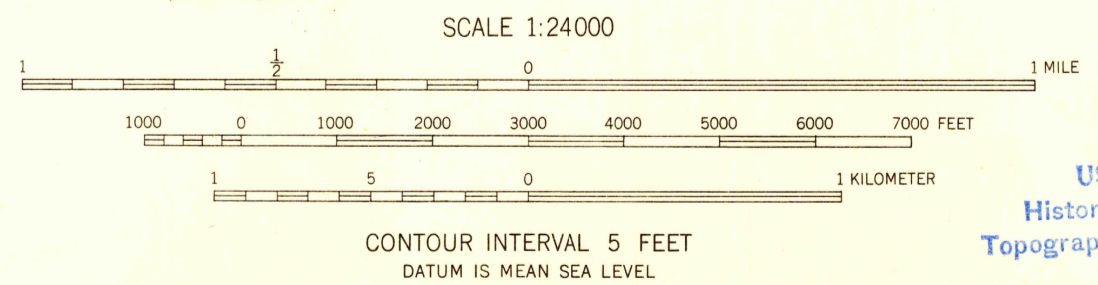
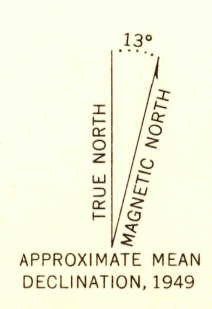

ROAD CLASSIFICATION

HARD-SURFACE ALL WEATHER ROADS	DRY WEATHER ROADS
Heavy-duty — 4 LANE LANE Improved dirt	Unimproved dirt
Medium-duty — 2 LANE LANE Unimproved dirt	Loose-surface, graded, or narrow hard-surface
U. S. Route	State Route

THIS MAP COMPLIES WITH NATIONAL MAP ACCURACY STANDARDS  
FOR SALE BY U. S. GEOLOGICAL SURVEY, FEDERAL CENTER, DENVER, COLORADO OR WASHINGTON 25, D. C.  
A FOLDER DESCRIBING TOPOGRAPHIC MAPS AND SYMBOLS IS AVAILABLE ON REQUEST

TOWNER, N. DAK.  
N4815-W10022.5/7.5  
EDITION OF 1950

U. S. G. S.  
FILE COPY  
Inspection and Editing.