

UNITED STATES
DEPARTMENT OF THE INTERIOR
GEOLOGICAL SURVEY

WESTHOPE SE QUADRANGLE
NORTH DAKOTA-BOTTINEAU CO.
7.5 MINUTE SERIES (TOPOGRAPHIC)

U. S. G. S.
FILE COPY
Inspection and Editing

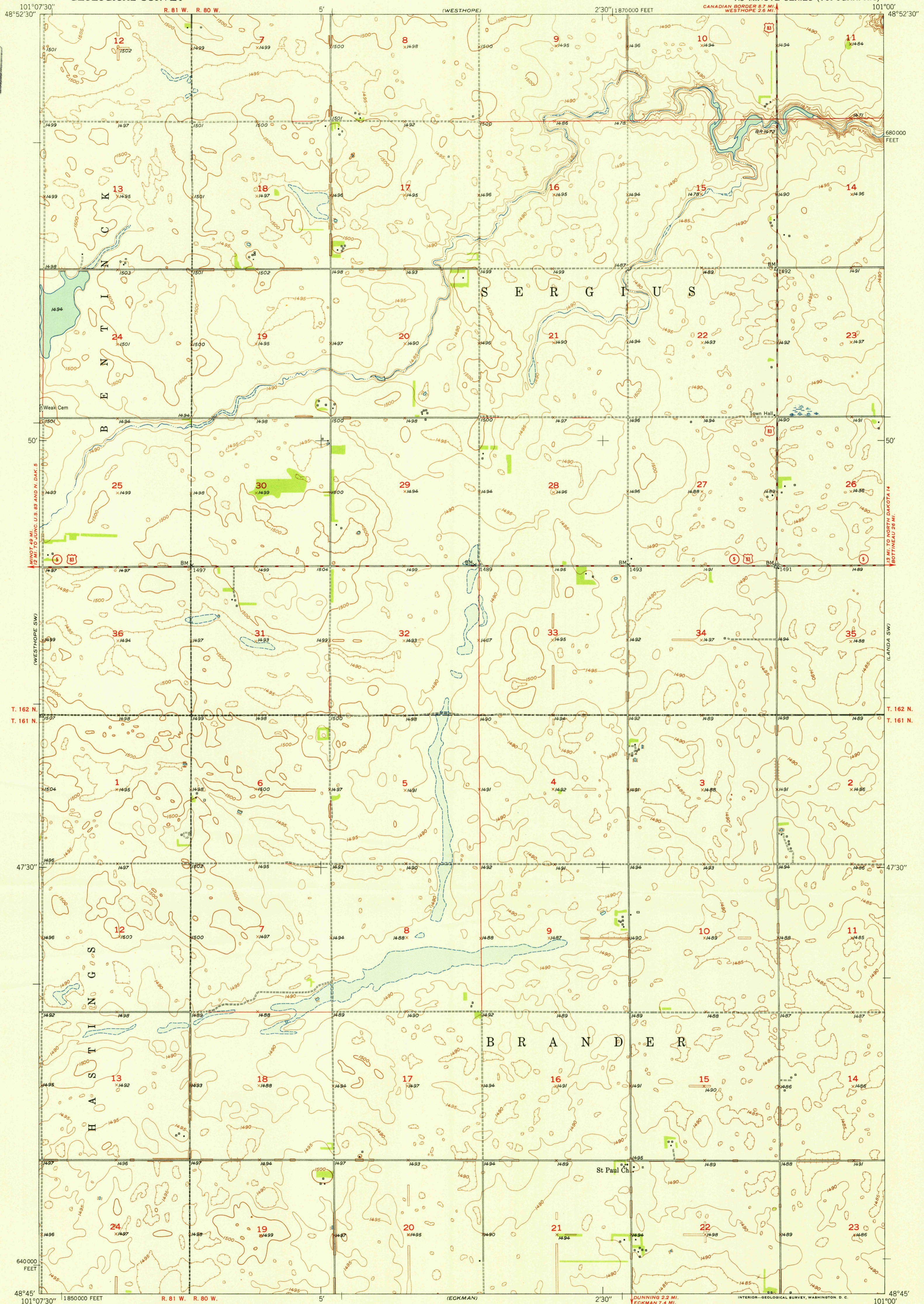

Mapped, edited, and published by the Geological Survey as part of the Department of the Interior program for the development of the Missouri River Basin
Control by USGS and USC&GS
Culture and drainage in part compiled from aerial photographs taken 1948
Topography by plane-table methods 1949
Polyconic projection. 1927 North American datum
10,000-foot grid based on North Dakota coordinate system, north zone

TRUE NORTH
MAGNETIC NORTH
APPROXIMATE MEAN DECLINATION, 1949

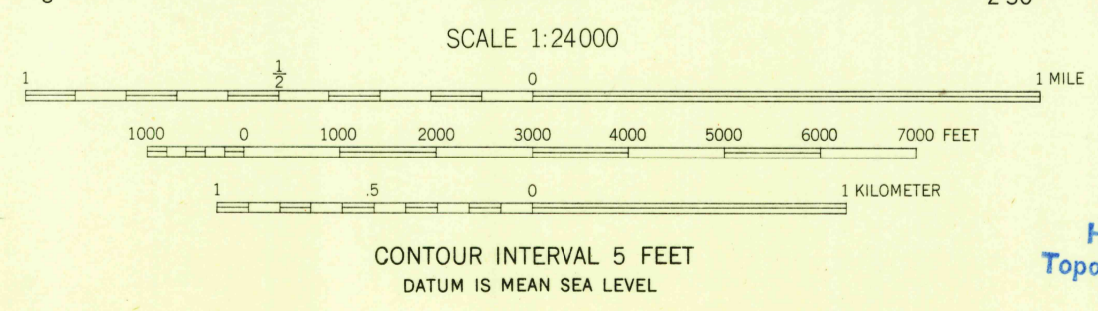

ROAD CLASSIFICATION
HARD-SURFACE ALL WEATHER ROADS DRY WEATHER ROADS
Heavy-duty **LAMEL LANE** Improved dirt
Medium-duty **LAMEL LANE** Unimproved dirt
Loose-surface, graded, or narrow hard-surface
U. S. Route State Route

U. S. G. S.
FILE COPY
Inspection and Editing

WESTHOPE SE, N. DAK.
N4845-W10100/7.5

THIS MAP COMPLIES WITH NATIONAL MAP ACCURACY STANDARDS
FOR SALE BY U. S. GEOLOGICAL SURVEY, FEDERAL CENTER, DENVER, COLORADO OR WASHINGTON 25, D. C.
A FOLDER DESCRIBING TOPOGRAPHIC MAPS AND SYMBOLS IS AVAILABLE ON REQUEST

EDITION OF 1951