

(MOHALL)

UNITED STATES DEPARTMENT OF THE INTERIOR GEOLOGICAL SURVEY

LANSFORD QUADRANGLE NORTH DAKOTA

(WESTHOPE SW) 1:24,000

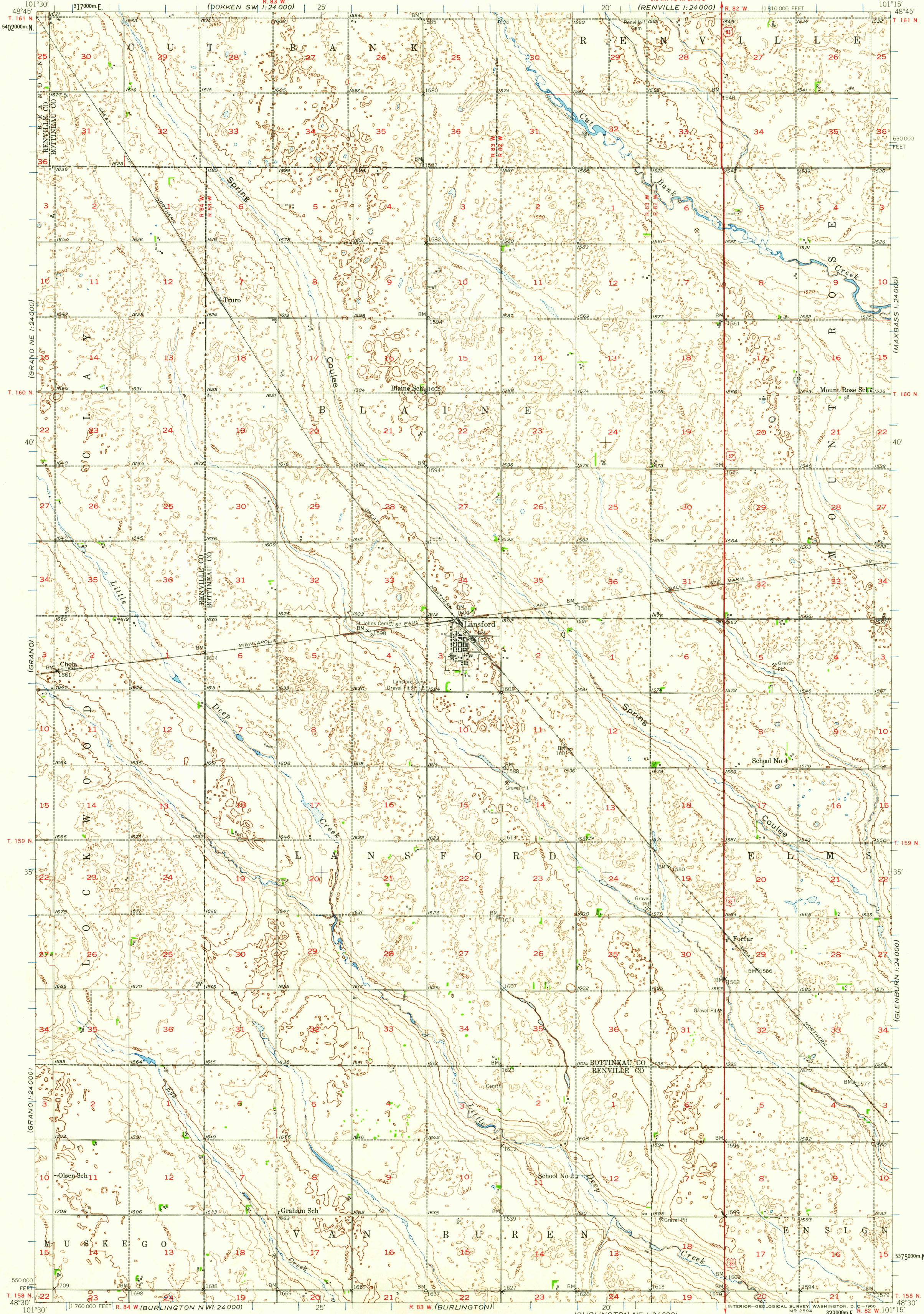

(CARPIO NE) 1:24,000

Mapped, edited, and published by the Geological Survey as part of the Department of the Interior program for the development of the Missouri River Basin. Control by USGS and USC&GS. Culture and drainage in part compiled from aerial photographs taken 1946. Topography by plane-table methods 1943. Polyconic projection. 1927 North American datum. 10,000-foot grid based on North Dakota coordinate system, north zone. 1000-meter Universal Transverse Mercator grid ticks, zone 14, shown in blue.

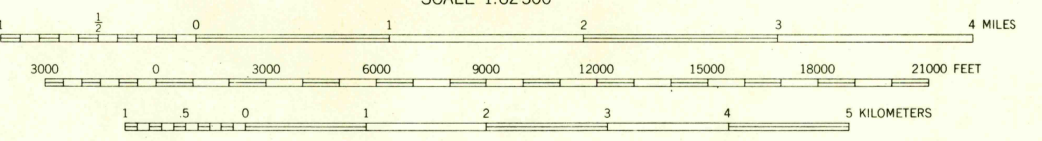
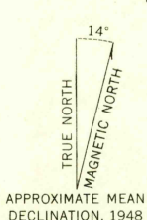

ROAD CLASSIFICATION: Heavy-duty, Light-duty, Unimproved dirt, U.S. Route.

FOR SALE BY U.S. GEOLOGICAL SURVEY, DENVER 25, COLORADO OR WASHINGTON 25, D. C. AND BY THE STATE WATER CONSERVATION COMMISSION, BISMARCK, NORTH DAKOTA. A FOLDER DESCRIBING TOPOGRAPHIC MAPS AND SYMBOLS IS AVAILABLE ON REQUEST.

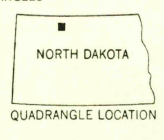

LANSFORD, N. DAK. N4830-W10115/15 1948

USGS Historical File Topographic Division

AUG 22 1960

4050