

(MOHALL)

UNITED STATES
DEPARTMENT OF THE INTERIOR
GEOLOGICAL SURVEY

LANSFORD QUADRANGLE
NORTH DAKOTA
15 MINUTE SERIES (TOPOGRAPHIC)

(WESTHOPE SW)
1:24,000

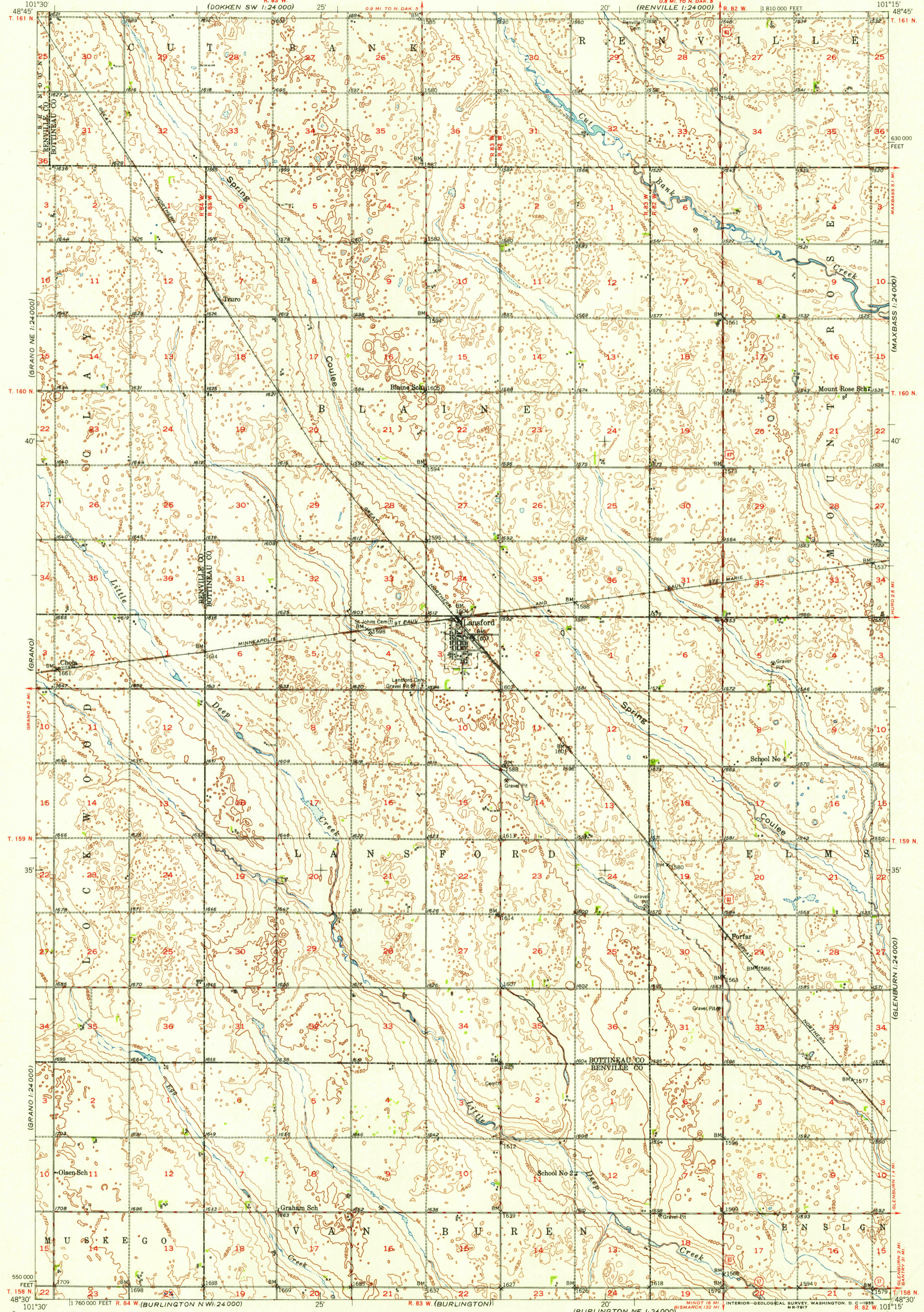

U.S.G.S.
FILE COPY
TOPOGRAPHIC DIVISION

(CARPIO NE)
1:24,000

Mapped, edited, and published by the Geological Survey as part of the Department of the Interior program for the development of the Missouri River Basin. Control by USGS and USC&GS. Culture and drainage in part compiled from aerial photographs taken 1946. Topography by plane-table methods 1948. Polyconic projection, 1927 North American datum 10,000-foot grid based on North Dakota coordinate system, north zone.

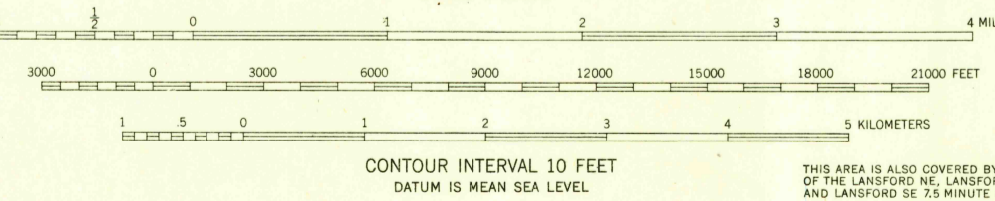
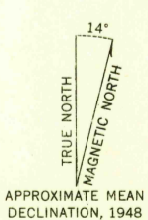

ROAD CLASSIFICATION

HARD-SURFACE ALL WEATHER ROADS	DRY WEATHER ROADS
Heavy-duty — 4 LANE 16 LANE	Improved dirt —
Medium-duty — 4 LANE 16 LANE	Unimproved dirt —
Loose-surface, graded, or narrow hard-surface —	
U. S. Route	State Route

LANSFORD, N. DAK.
N4830-W10115/15

1948

THIS MAP COMPLIES WITH NATIONAL MAP ACCURACY STANDARDS FOR SALE BY U. S. GEOLOGICAL SURVEY, FEDERAL CENTER, DENVER, COLORADO OR WASHINGTON 25, D. C. AND BY THE STATE WATER CONSERVATION COMMISSION, BISMARCK, NORTH DAKOTA. A FOLDER DESCRIBING TOPOGRAPHIC MAPS AND SYMBOLS IS AVAILABLE ON REQUEST.

USGS
Historical File
Topographic Division

U.S.G.S.
FILE COPY
TOPOGRAPHIC DIVISION

JUN 22 1955
2560