

ROSE, NEBRASKA

30 X 60 MINUTE SERIES (PLANIMETRIC)

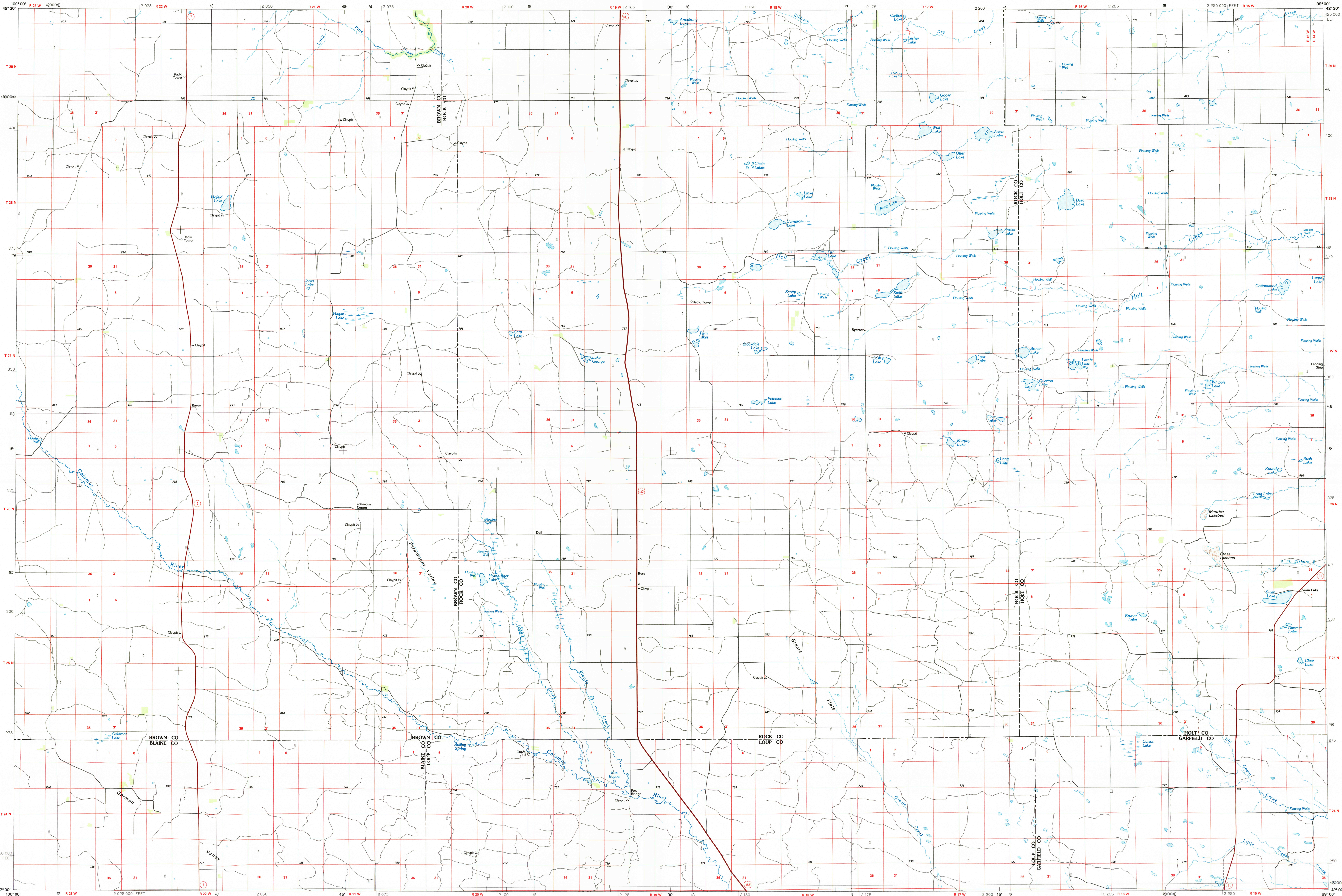

Rose NEBRASKA

1:100 000-scale planimetric map

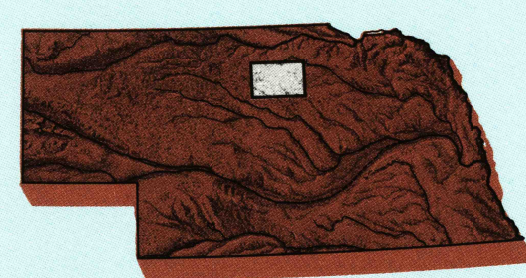

30 X 60 MINUTE QUADRANGLE SHOWING

- Elevations in meters
- Highways, roads and other manmade structures
- Water features
- Woodland areas
- Geographic names

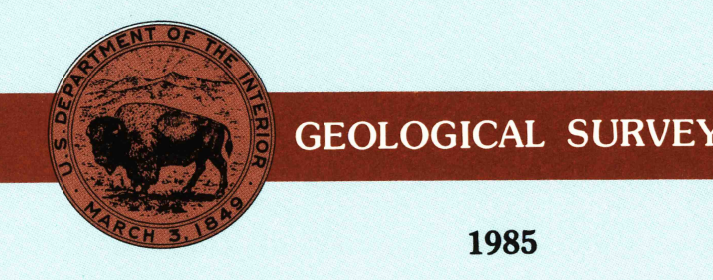

Produced by the United States Geological Survey  
 Compiled from USGS 1:24 000-scale topographic maps dated 1981-1982. Planimetry revised from aerial photographs taken 1982 and other source data. Revised information not field checked. Map edited 1985.  
 Projection and 10 000-meter grid, zone 14, Universal Transverse Mercator  
 25 000-foot grid ticks based on Nebraska coordinate system, north zone  
 1927 North American Datum  
 To place on the predicted North American Datum 1983, move the projection lines 5 meters north and 33 meters east

NATIONAL GEODETIC VERTICAL DATUM OF 1929 ELEVATIONS SHOWN TO THE NEAREST METER

THIS MAP COMPLES WITH NATIONAL MAP ACCURACY STANDARDS

Meters	Feet
1	3.2808
2	6.5617
3	9.8425
4	13.1234
5	16.4042
6	19.6850
7	22.9659
8	26.2467
9	29.5276
10	32.8084

To convert meters to feet multiply by 3.2808  
 To convert feet to meters multiply by 0.3048

DECLINATION DIAGRAM	ADJOINING MAPS									
<p>UTM grid convergence (GM) and 1983 magnetic declination (MN) at center of map            Diagram is approximate</p>	<table border="1"> <tr><td>1</td><td>2</td><td>3</td></tr> <tr><td>4</td><td>5</td><td>6</td></tr> <tr><td>7</td><td>8</td><td></td></tr> </table> <p>1 Valentine            2 Alsworth            3 Adkins            4 Goose Creek            5 O'Neill            6 Dismal River            7 Burwell            8 Oak</p>	1	2	3	4	5	6	7	8	
1	2	3								
4	5	6								
7	8									

FOR SALE BY U.S. GEOLOGICAL SURVEY DENVER, COLORADO 80225, OR RESTON, VIRGINIA 22092

Topographic Map Symbols

- Primary highway, hard surface
- Secondary highway, hard surface
- Light duty road, principal street, hard or improved surface
- Other road or street, trail
- Route marker: Interstate, U.S. State
- Railroad: standard gage, narrow gage
- Bridge: overpass, underpass
- Tunnel: road, railroad
- Built up area, locality: elevation
- Airport, landing field, landing strip
- National boundary
- State boundary
- County boundary
- National or State reservation boundary
- Land grant boundary
- U.S. public lands survey: range, township, section
- Range, township, section line: protracted
- Power transmission line: pipeline
- Dam; dam with lock
- Cemetery; building
- Windmill; water well; spring
- Mine shaft; adit or cave; mine, quarry; gravel pit
- Campground, picnic area; U.S. location monument
- Radar; cliff dwelling
- Distorted surface: strip mine, lava, sand
- Contours: index, intermediate, supplementary
- Bathymetric contours: index, intermediate
- Stream, lake, perennial, intermittent
- Basin; large and small; lake, large and small
- Area to be submerged; marsh, swamp
- Land subject to controlled inundation; woodland
- Scrub; mangrove
- Orchard; vineyard

A pamphlet describing topographic maps is available on request

