

UNITED STATES  
DEPARTMENT OF THE INTERIOR  
GEOLOGICAL SURVEY

MEADVILLE QUADRANGLE  
NEBRASKA  
7.5 MINUTE SERIES (TOPOGRAPHIC)

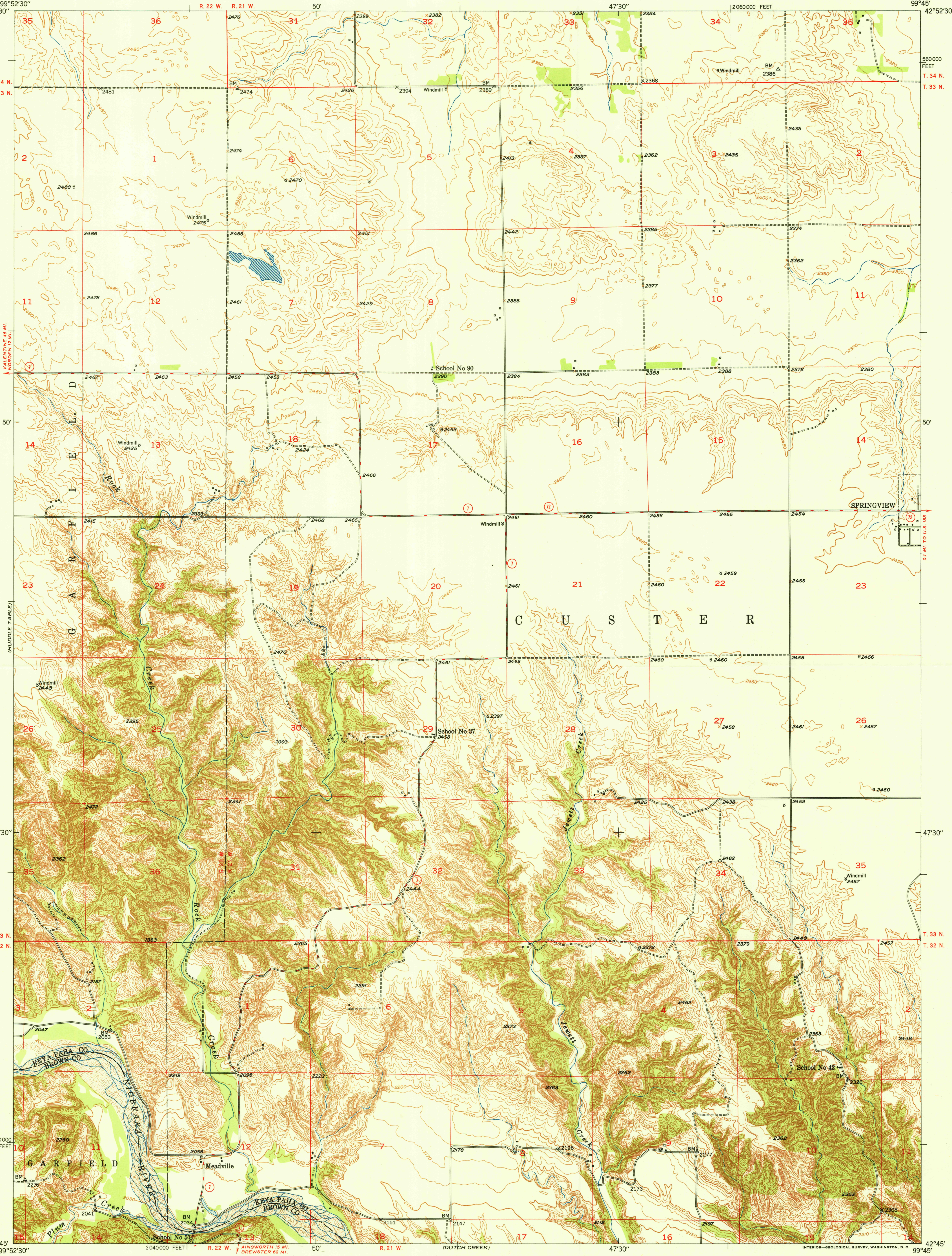

Mapped, edited, and published by the Geological Survey as part of the Department of the Interior program for the development of the Missouri River Basin. Control by USGS and USC&GS. Topography by multiplex methods from aerial photographs taken 1946, and by plane-table surveys 1948. Field check 1948. Polyconic projection. 1927 North American datum. 10,000-foot grid based on Nebraska coordinate system, north zone.

TRUE NORTH  
MAGNETIC NORTH  
APPROXIMATE MEAN DECLINATION, 1948

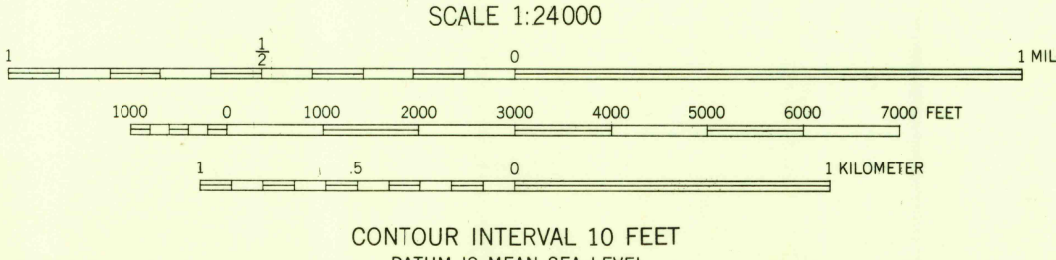

ROAD CLASSIFICATION  
HARD-SURFACE ALL WEATHER ROADS DRY WEATHER ROADS  
Heavy-duty ——— 4-LANE 6-LANE Improved dirt ———  
Medium-duty ——— 4-LANE 6-LANE Unimproved dirt ———  
Loose-surface, graded, or narrow hard-surface ———  
U. S. Route State Route

THIS MAP COMPLIES WITH NATIONAL MAP ACCURACY STANDARDS  
FOR SALE BY U. S. GEOLOGICAL SURVEY, FEDERAL CENTER, DENVER, COLORADO OR WASHINGTON 25, D. C.  
A FOLDER DESCRIBING TOPOGRAPHIC MAPS AND SYMBOLS IS AVAILABLE ON REQUEST

U. S. G. S.  
FILE COPY  
Inspection and Editing

MEADVILLE, NEBR.  
N4245-W9945/7.5

EDITION OF 1950

USGS  
Historical File  
Topographic Division