

UNITED STATES
DEPARTMENT OF THE INTERIOR
GEOLOGICAL SURVEY

NORTH PLATTE 2 SW QUADRANGLE
NEBRASKA—LINCOLN CO.
7.5 MINUTE SERIES (TOPOGRAPHIC)

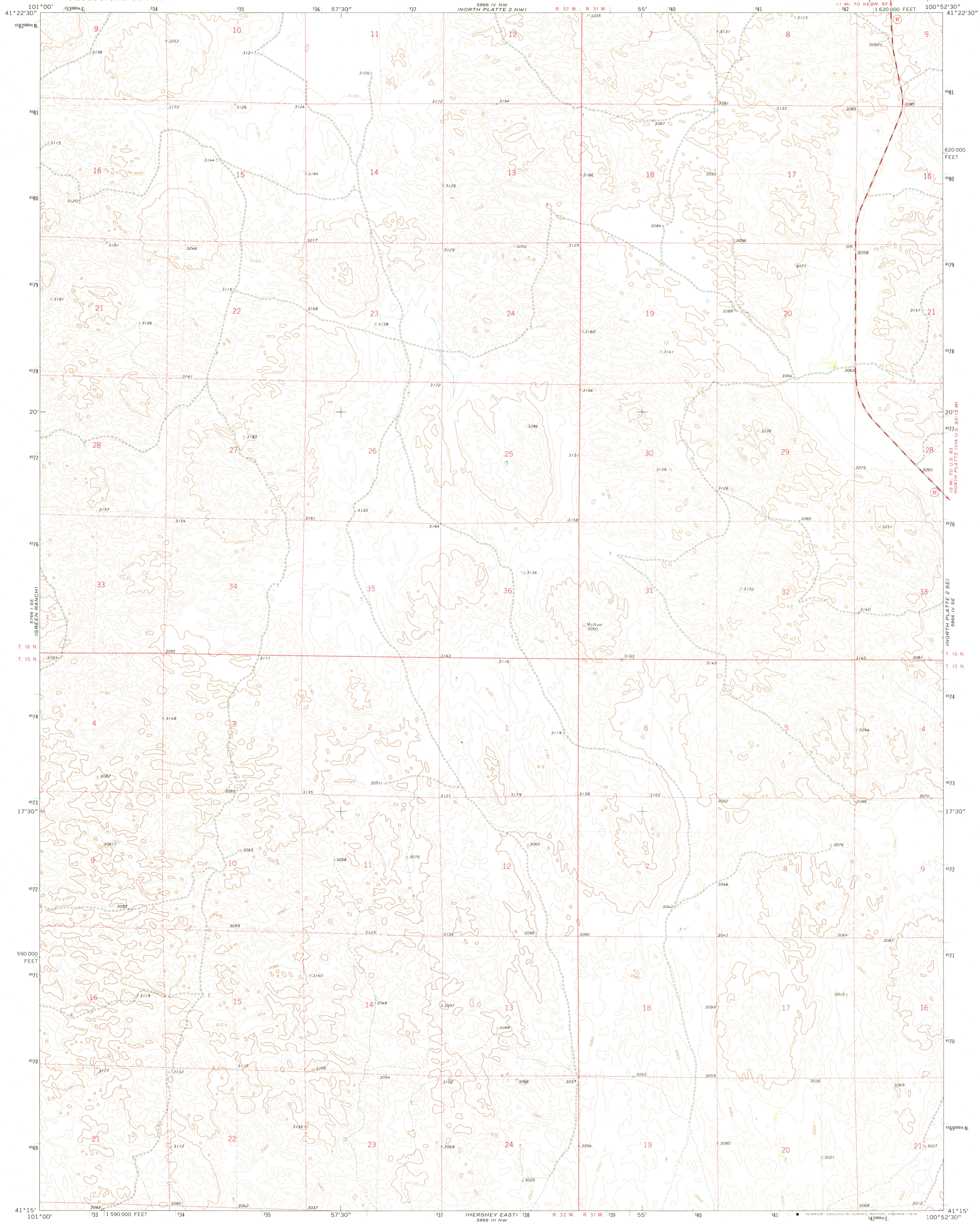

Mapped, edited, and published by the Geological Survey

Control by USGS and USC&GS

Topography by photogrammetric methods from aerial photographs taken 1972. Field checked 1972

Projection and 10,000-foot grid ticks: Nebraska coordinate system, south zone (Lambert conformal conic)

1000-meter Universal Transverse Mercator grid ticks, zone 14, shown in blue. 1927 North American datum

Fine red dashed lines indicate selected fence and field lines where generally visible on aerial photographs. This information is unchecked

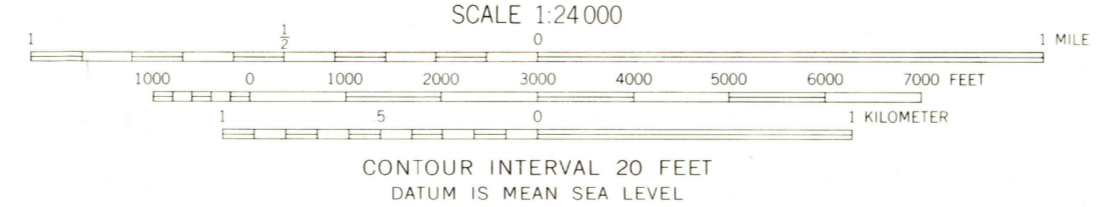
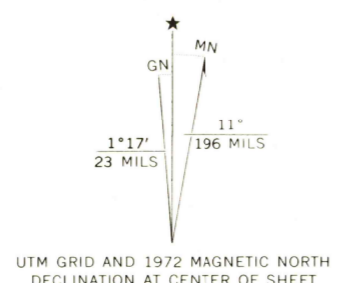

ROAD CLASSIFICATION

Primary highway, hard surface	Light-duty road, hard or improved surface
Secondary highway, hard surface	Unimproved road

 Interstate Route
 U.S. Route
 State Route

USCS Historical File
Topographic Division

NORTH PLATTE 2 SW, NEBR.
N4115-W10052.5/7.5

1972

AMG 5866 IV SW—SERIES V875