

(Nonoverlaid)

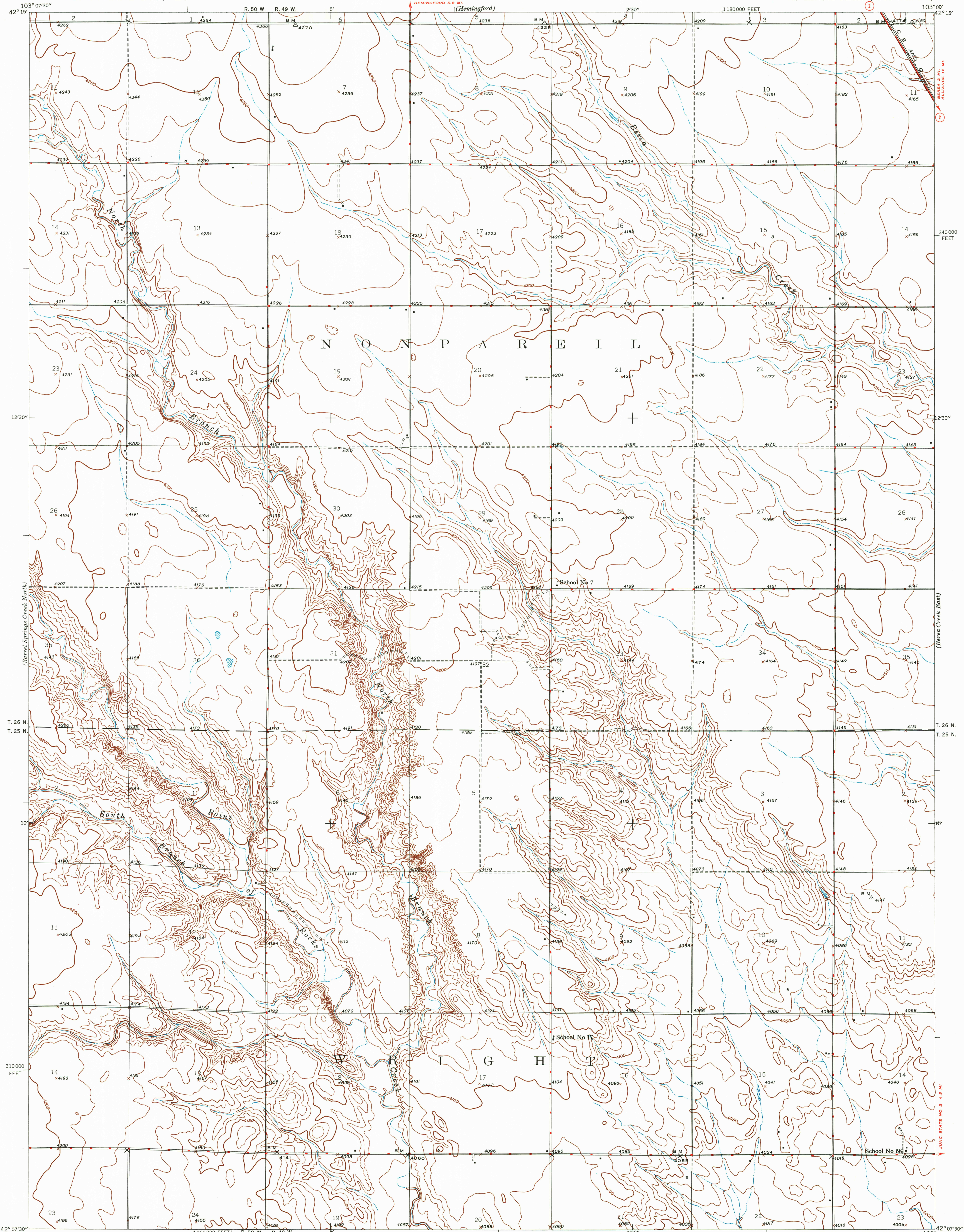

Mapped by the Geological Survey  
1946

ROAD CLASSIFICATION		U.S. Route
Dependable hard surface	Dry weather roads	U.S. Route (1)
Fairly dry road	Loose surface graded	
Secondary hard surface	Unimproved graded	
All weather road	Dirt road	State Route (2)
More than two lanes indicated along road with tick at point of change	Scale 1/4 mile	

134°  
TRUE NORTH  
MAGNETIC NORTH  
APPROXIMATE MEAN  
DECLINATION, 1946

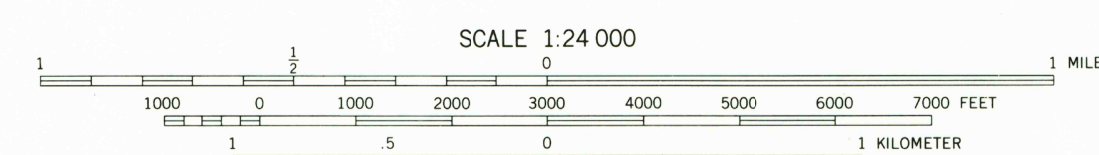

CONTOUR INTERVAL 10 FEET  
NATIONAL GEODETIC VERTICAL DATUM OF 1929

• INTERIOR-GEOLOGICAL SURVEY, RESTON, VIRGINIA-1983  
Polyconic projection, 1927 North American datum  
10,000 foot grid based on Nebraska (North)  
rectangular coordinate system

SCHOOL NO. 7, NEBR.  
(FORMERLY HEMINGFORD 4 NE)  
42103-B1-TF-024

1948

DMA 5368 II NE-SERIES V875

