

(Nonpart)

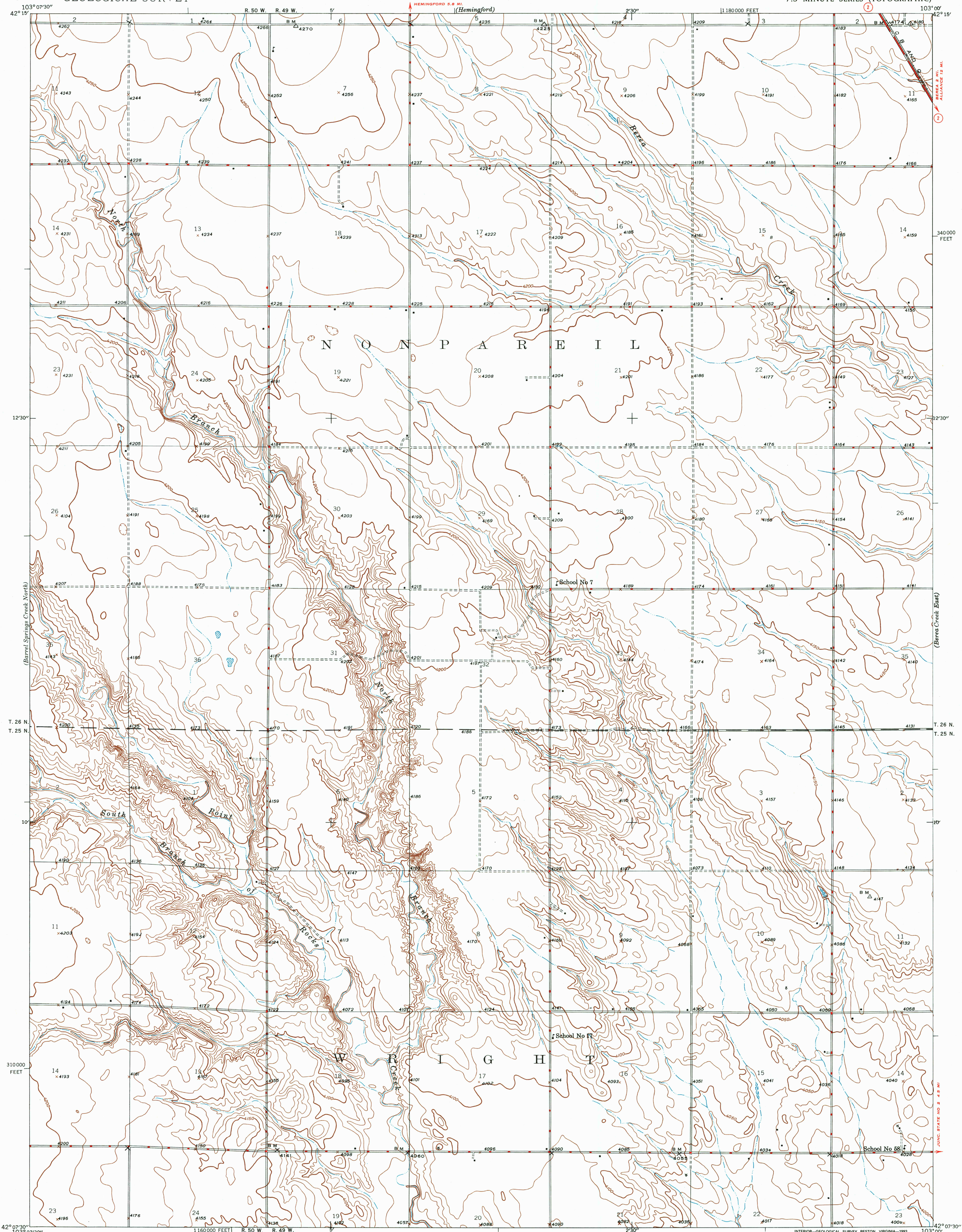

Mapped by the Geological Survey
1946

ROAD CLASSIFICATION
Dependable hard surface
Heavy-duty road
Secondary hard surface
All-weather road
Dirt road
U.S. Route
Dry weather roads
Unsurfaced gravel
Unsurfaced
Dotted road
State Route

TRUE NORTH
MAGNETIC NORTH
APPROXIMATE MEAN
DECLINATION, 1946

SCALE 1:24 000
1 MILE
1000 0 1000 2000 3000 4000 5000 6000 7000 FEET
1 KILOMETER

CONTOUR INTERVAL 10 FEET
NATIONAL GEODETIC VERTICAL DATUM OF 1929

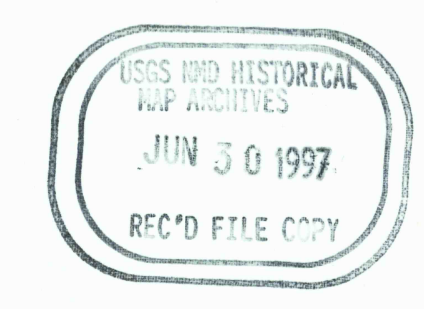

INTERIOR-GEOLOGICAL SURVEY, RESTON, VIRGINIA-1993
Polyconic projection, 1927 North American datum
10000 foot grid based on Nebraska (North)
rectangular coordinate system

SCHOOL NO. 7, NEBR.
(FORMERLY HEMINGFORD 4 NE)
42103-B1-TF-024
1948
DMA 5368 II NE-SERIES V875

