

(SIMEON)

UNITED STATES  
DEPARTMENT OF THE INTERIOR  
GEOLOGICAL SURVEY

LONG LAKE QUADRANGLE  
NEBRASKA-CHERRY CO.  
15 MINUTE SERIES (TOPOGRAPHIC)

(WOOD LAKE)

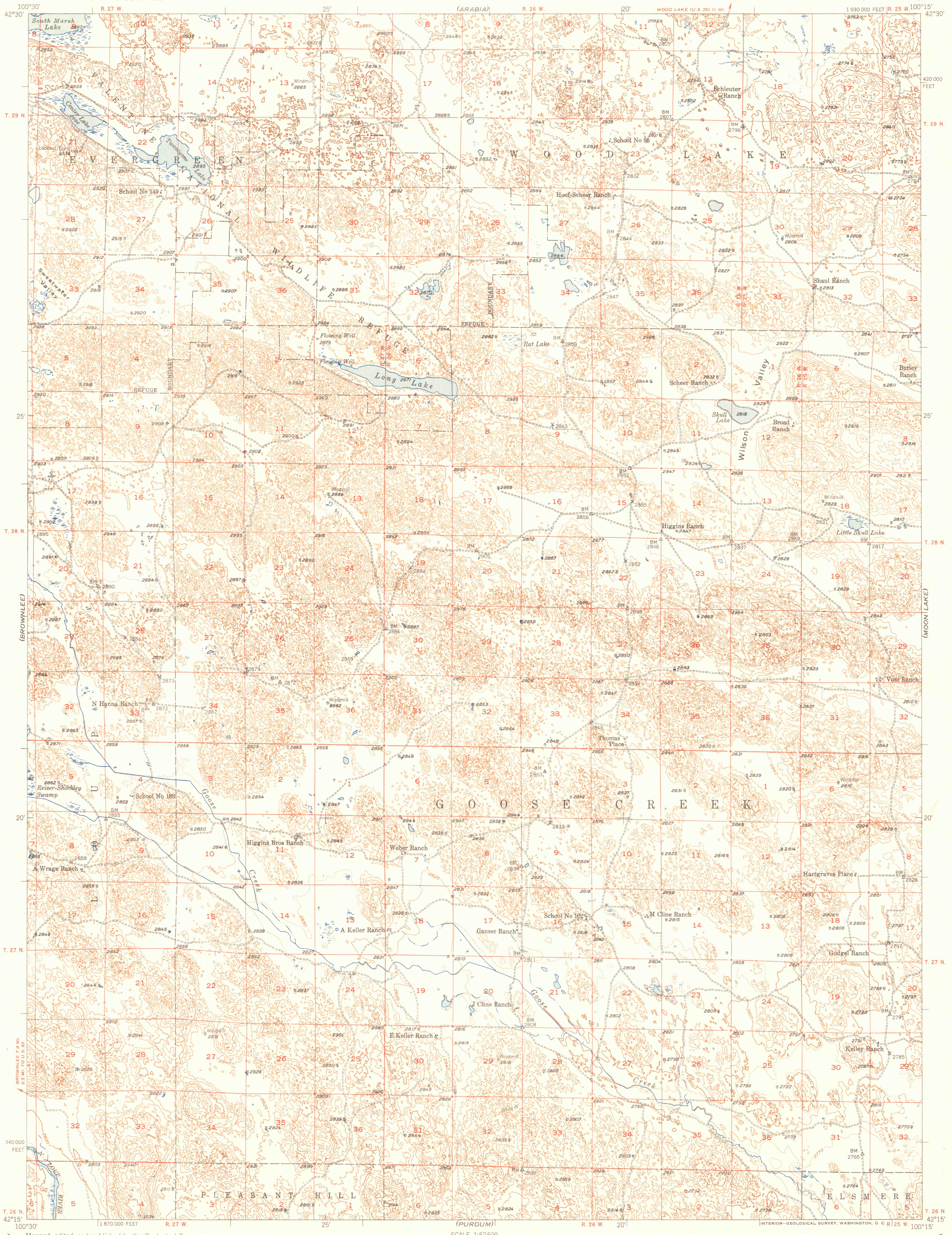

Maped, edited, and published by the Geological Survey as part of the Department of the Interior program for the development of the Missouri River Basin Control by USGS and USC&GS  
Topography from aerial photographs by multiplex methods Aerial photographs taken 1946. Field check 1949  
Polyconic projection. 1927 North American datum 10,000-foot grid based on Nebraska coordinate system, north zone  
Dashed land lines indicate approximate location

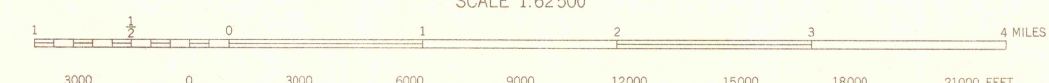
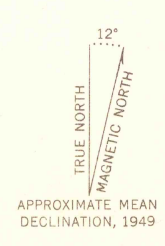

CONTOUR INTERVAL 20 FEET  
DOTTED LINES REPRESENT HALF-INTERVAL CONTOURS  
DATUM IS MEAN SEA LEVEL

ROAD CLASSIFICATION

HARD-SURFACE ALL WEATHER ROADS	DRY WEATHER ROADS
Heavy-duty	Improved dirt
Medium-duty	Unimproved dirt
Loose-surface, graded, or narrow hard-surface	
U. S. Route	State Route

THIS MAP COMPLIES WITH NATIONAL MAP ACCURACY STANDARDS  
FOR SALE BY U. S. GEOLOGICAL SURVEY, FEDERAL CENTER, DENVER, COLORADO OR WASHINGTON 25, D. C.  
A FOLDER DESCRIBING TOPOGRAPHIC MAPS AND SYMBOLS IS AVAILABLE ON REQUEST

LONG LAKE, NEBR.  
N4215-W10015/15  
EDITION OF 1951

BELOIT COLLEGE LIBRARIES  
BELOIT, WISCONSIN