

MAPPED BY U.S.G.S. IN 1885-1886

Little Egg Harbor

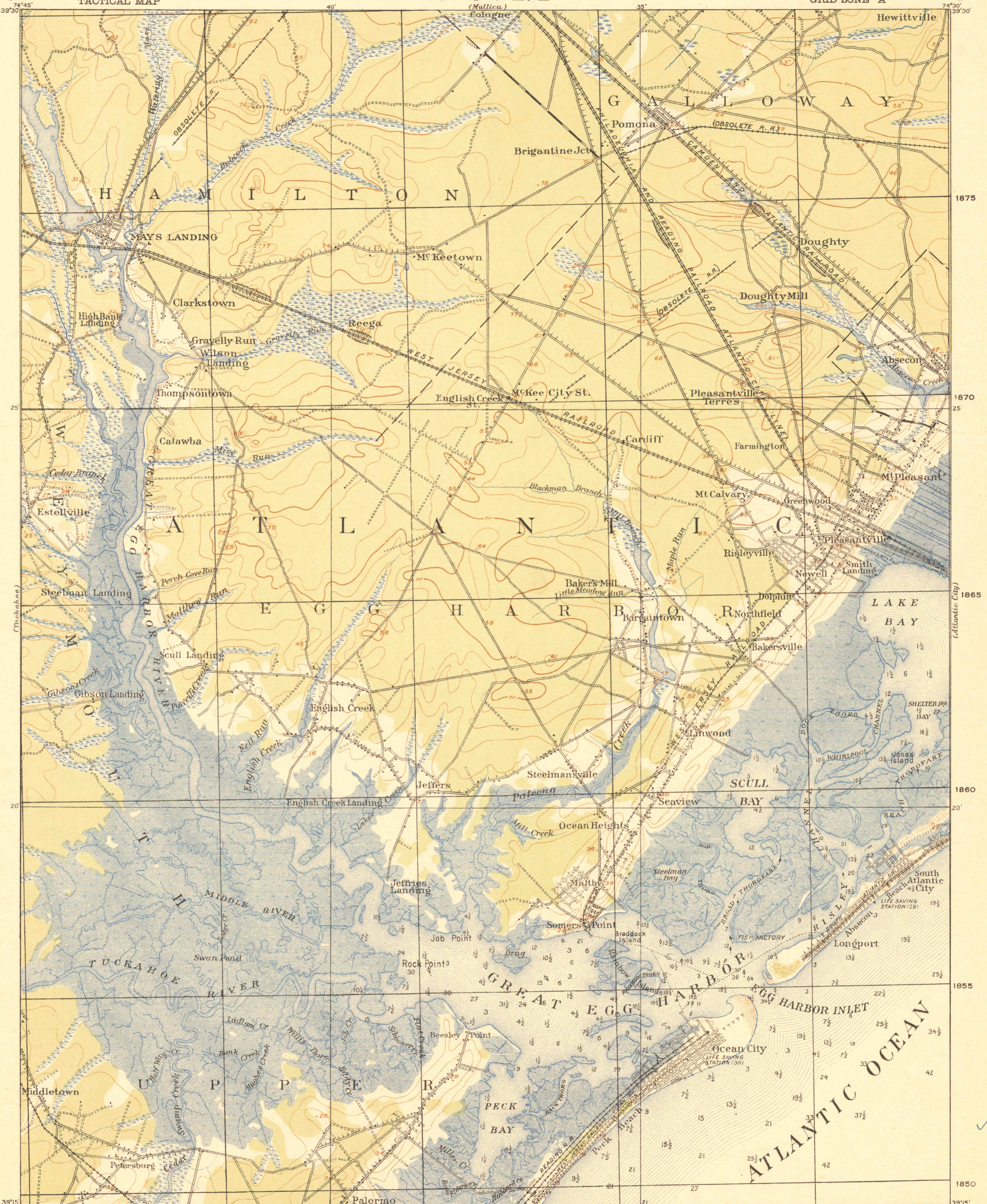

Base map from U. S. G. S. engravings, surveyed in 1885 - 6.
Additional field work and compilation under the direction of
Colonel Amos Stickney, Corps of Engineers, U. S. Army,
Department Engineer, Atlantic Division,
May 11, 1906.
Additional field work under the immediate supervision of
2nd. Lieut. C. S. Blakely, Artillery Corps, U. S. Army.
Soundings expressed in feet and referred to mean low
water are from U. S. C. & G. S. Chart. No. 1217.

Reprint E. R. P. 1921

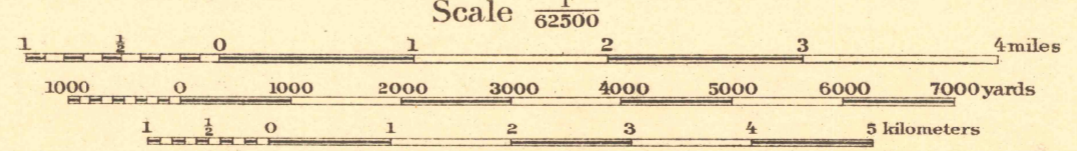

FIVE THOUSAND YARD GRID COMPUTED FROM "GRID SYSTEM FOR PROGRESSIVE MAPS
IN THE U. S." ZONE A, U. S. C. & G. S. SPECIAL PUBLICATION NO. 59.
(THE LAST THREE DIGITS OF THE GRID NUMBERS ARE OMITTED)

NOTE: OFFICERS USING THIS MAP WILL MARK HEREON CORRECTIONS AND ADDITIONS WHICH COME
TO THEIR ATTENTION AND MAIL DIRECT TO "THE CHIEF OF ENGINEERS, WASHINGTON, D. C."

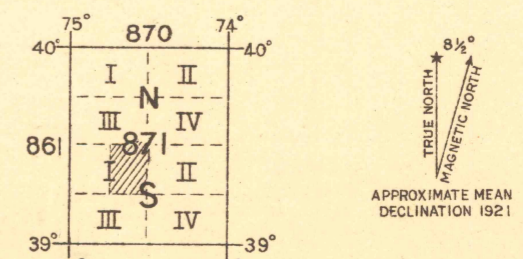

GREAT EGG HARBOR

N. J.