

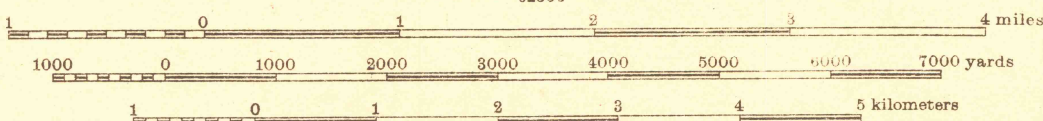

Base map from U. S. G. S. engravings.
Corrections and additions by
Department Engineer, Eastern Department.
Additional field work and compilation under the direction
of Col. Amos Stickney, Corps of Engineers, U. S. A.,
Chief Engineer Office, Atlantic Division.
Jan. 21, 1906
Additional field work under the immediate supervision of
2nd. Lieut. C. S. Blakely, Artillery Corps, U. S. A.



Contour Interval 10 feet
Datum is mean sea level

NOTE: OFFICERS USING THIS MAP WILL MARK HEREON CORRECTIONS AND ADDITIONS WHICH COME
TO THEIR ATTENTION AND MAIL DIRECT TO THE CHIEF OF ENGINEERS, WASHINGTON, D. C.

Reprint E. R. P. 1921

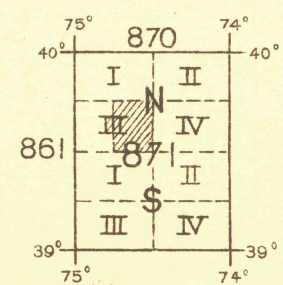

APPROXIMATE MEAN
DECLINATION 1921



MULLICA

Board of Survey & Maps
FILE COPY
Map Information Office