

RETAINED COPY
This sheet must not be taken from
the files without an order from the
Chief Topographic Engineer.

DEC 3 1924

NEW MEXICO
BROOM MOUNTAIN QUADRANGLE

283-N-1 AND III
(Mt Taylor 230500)

DEPARTMENT OF THE INTERIOR
U. S. GEOLOGICAL SURVEY

Advance sheet
Subject to correction

Wingate
230500

(Mt Taylor)
230500



Topography: Rapid reconnaissance by N.H. Darton
1915-1917

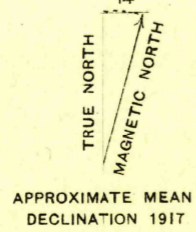

Burley

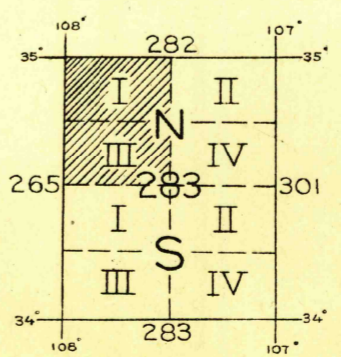

BROOM MOUNTAIN, N.M.

pub as adv sheet