

(Sheet 267 N)
II & III

ADVANCE SHEET

DEPARTMENT OF THE INTERIOR
FRANKLIN K. LANE, SECRETARY
U.S. GEOLOGICAL SURVEY
GEORGE OTIS SMITH, DIRECTOR

PROGRESSIVE MILITARY MAP OF THE UNITED STATES SOUTHERN DEPARTMENT TOPOGRAPHY

NEW MEXICO
(LUNA COUNTY)
SHEET 285 S. I & III DEMING QUADRANGLE

(Sheet 285 N)

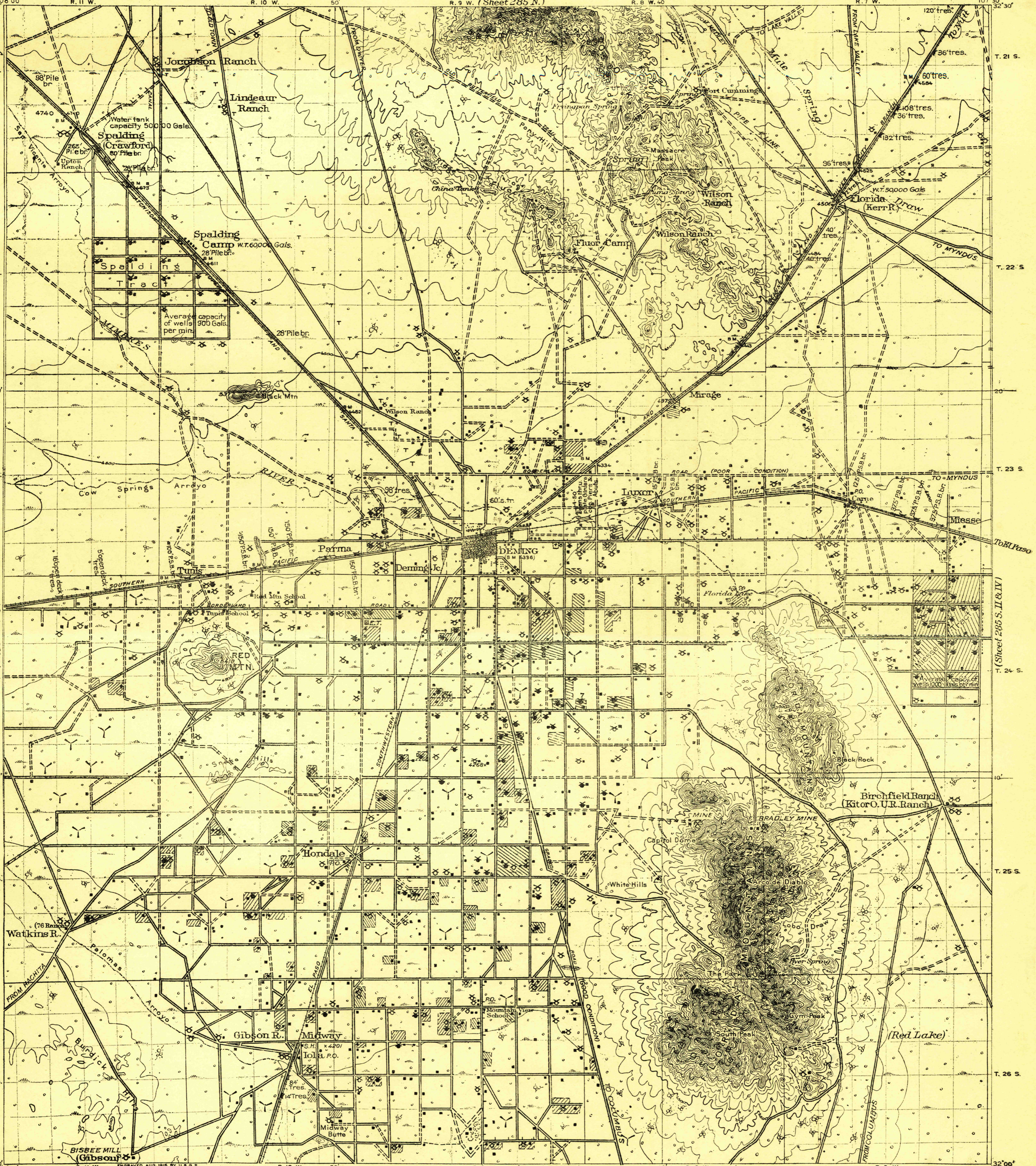

From Lordsburg
(Sheet 267 S)

(Sheet 268 N)

(Sheet 285 S. I & IV)

(Sheet 286 N)

A.H. Thompson, Geographer.
R. U. Goode, Topographer in charge.
Triangulation by Wheeler Survey.
Topography by R. O. Gordon.
Surveyed in 1892.
Culture revised by E. P. Davis, 1914.
R. B. Marshall, Chief Geographer.

DIAGRAM OF TOWNSHIP

6	5	4	3	2	1
7	8	9	10	11	12
13	14	15	16	17	18
19	20	21	22	23	24
25	26	27	28	29	30
31	32	33	34	35	36

Figures under power pumps denote capacity of flow in 100 gals. per minute.

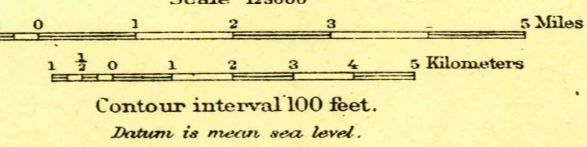

Revised and military information added by reconnaissance methods under direction of Department Engineer, So. Dept., by Wm. N. Hensley, Jr., 1st Lt., 14th Cav., C. de B. Hunt, 2nd Lt., 13th Cav. and John A. Roberson, 2nd Lt., 9th Cav. 1914.
Henry H. Robert, Major Corps of Engineers, Department Engineer
R. C. Kuldell, Captain, Corps of Engineers, Asst. Department Engineer
F. J. Nixon and H. M. Matthews, Draftsmen.
Revised, redrawn and reprinted Sept. 1916

- Good unimproved road
- Fair road
- Electric Power Transmission Line
- Lt. Roberson reports; very few roads improved; most of them are very good natural roads, easily passable for heavily loaded escort wagons.
- ⊗ Windmill
- ⊕ Power pump
- ⊙ earth tank
- ⊠ Mesquite

Note: For description of area covered by this map and for detailed information as to certain military features thereof apply to Department Engineer, Southern Dept., for copy of file No. 528 D.E., S.D.

Notations as to sheet and number in parentheses on margin indicate designations of adjoining sheets.
⊕ indicate certain good aeroplane landing places reported by Lt. Roberson.

All railroads are fenced and have telegraph lines paralleling them unless otherwise noted.

Engineer Reproduction Plant, U. S. Army, Washington Barracks, D. C. 1919

2830 USGS 2830
Historical File
Topographic Division

Deming N.M.