

U.S.G.S.
FILE COPY

TOPOGRAPHY

NEW MEXICO
SILVER CITY QUADRANGLE

U.S. GEOLOGICAL SURVEY
GEORGE OTIS SMITH, DIRECTOR

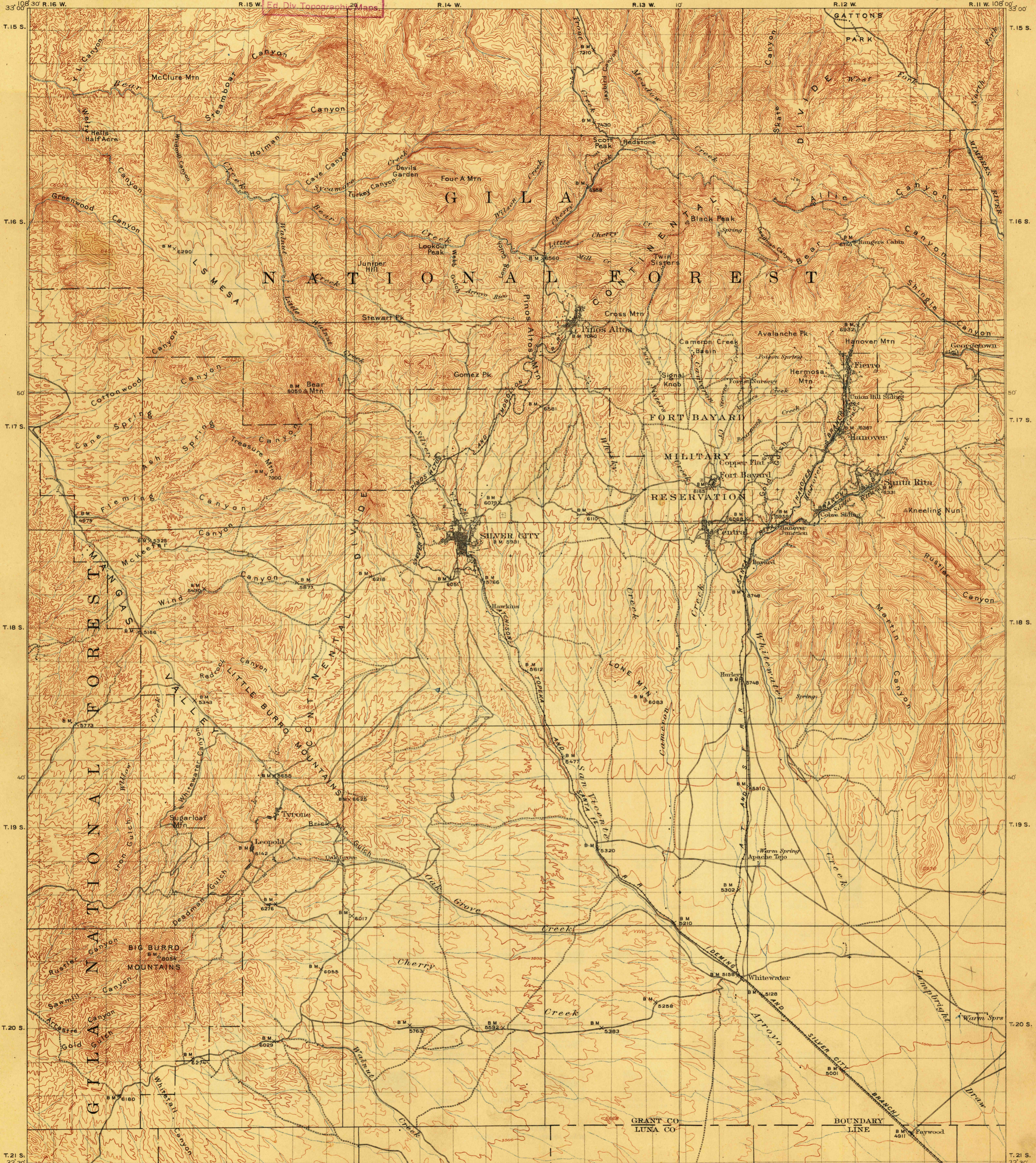

E. C. Barnard, Geographer in charge
Topography by A. B. Searle, J. H. Sinclair,
Gilbert Young and Chas. Hartmann, Jr.
Control by Fred. McLaughlin.
Surveyed in 1907.

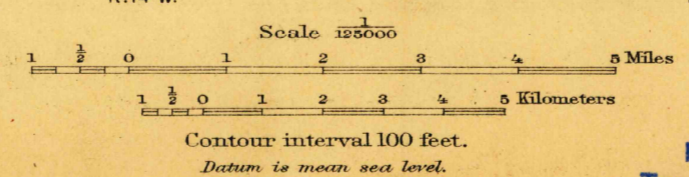
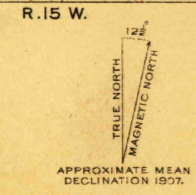

Diagram of townships

6	5	4	3	2	1
7	8	9	10	11	12
13	14	15	16	17	18
19	20	21	22	23	24
25	26	27	28	29	30
31	32	33	34	35	36

Ed. of June 1909.

U.S.G.S.
FILE COPY
Ed. Div. Topographic Maps.

AUG 31 1909
3548
SILVER CITY, N.M.

USGS
Historical File
Topographic Division