

UNITED STATES
DEPARTMENT OF THE INTERIOR
GEOLOGICAL SURVEY

ALSTON RANCH QUADRANGLE
NEW MEXICO—LEA CO.
7.5 MINUTE SERIES (TOPOGRAPHIC)

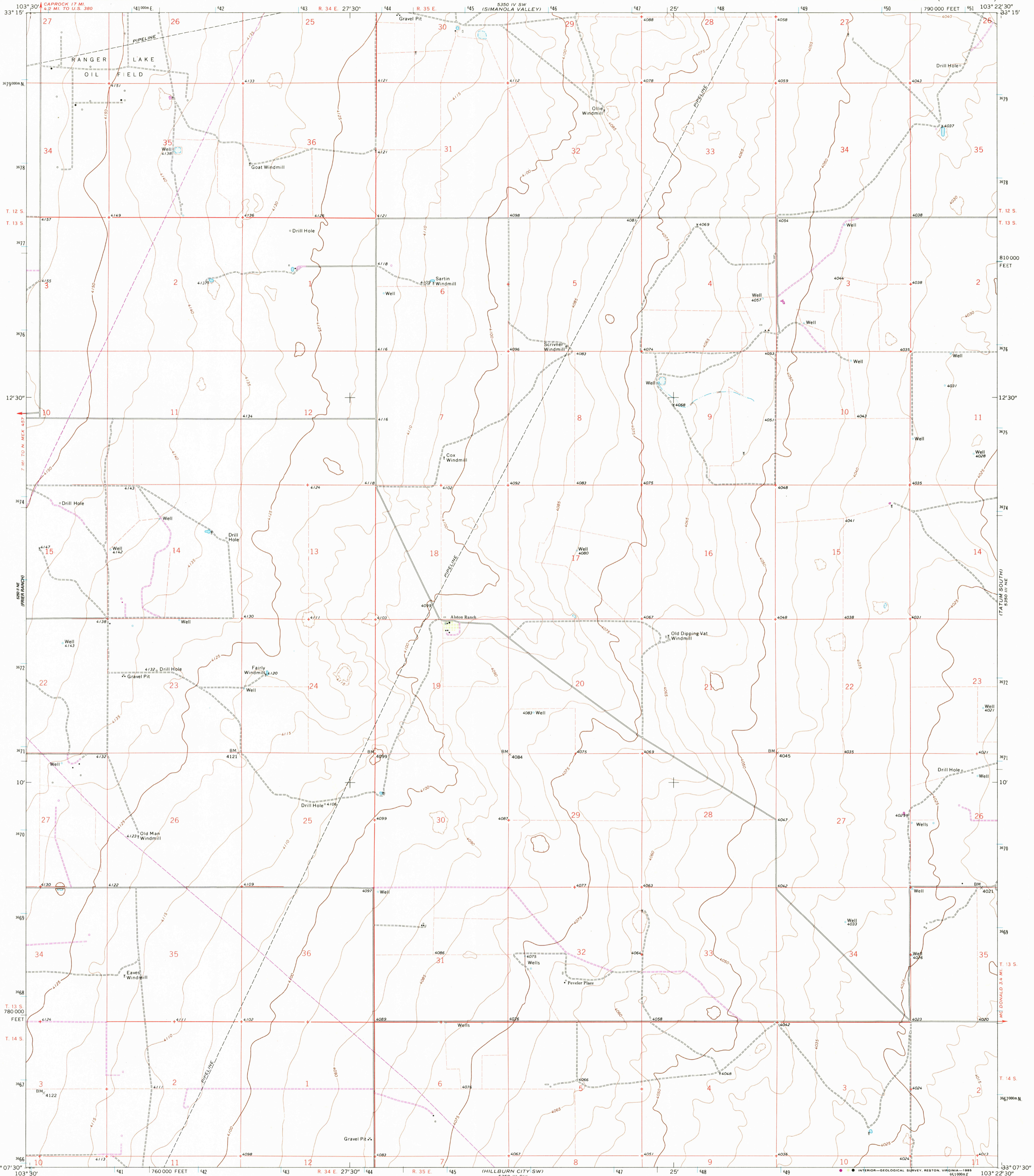

Mapped, edited, and published by the Geological Survey

Control by USGS and NOS/NOAA

Planimetry by photogrammetric methods from aerial photographs taken 1968. Topography by planetable surveys 1970

Polycyclic projection. 10,000-foot grid ticks based on New Mexico coordinate system, east zone
1000-meter Universal Transverse Mercator grid ticks, zone 13, shown in blue
1927 North American Datum
To place on the predicted North American Datum 1983 move the projection lines 8 meters south and 46 meters east as shown by dashed corner ticks

Fine red dashed lines indicate selected fence lines

Revisions shown in purple and woodland compiled from aerial photographs taken 1982 and other sources. This information not field checked. Map edited 1984

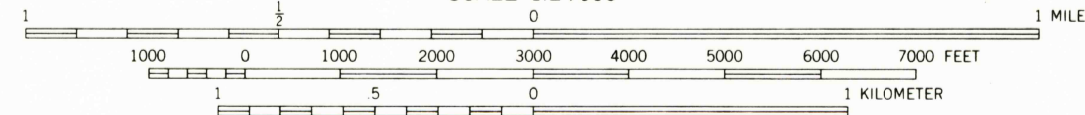
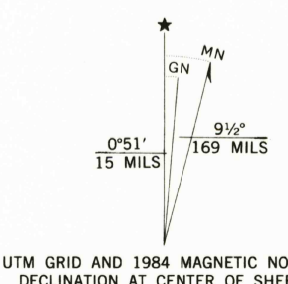

CONTOUR INTERVAL 5 FEET
NATIONAL GEODETIC VERTICAL DATUM OF 1929



ROAD CLASSIFICATION
Light-duty road, all weather, Unimproved road, fair or dry improved surface weather

ALSTON RANCH, N. MEX.
33103-B4-TF-024

1970
PHOTOREVISED 1984
DMA 5350 III NW—SERIES V881

THIS MAP COMPLIES WITH NATIONAL MAP ACCURACY STANDARDS
FOR SALE BY U. S. GEOLOGICAL SURVEY, DENVER, COLORADO 80225, OR RESTON, VIRGINIA 22092
A FOLDER DESCRIBING TOPOGRAPHIC MAPS AND SYMBOLS IS AVAILABLE ON REQUEST

RETURN TO:
USGS AND HISTORICAL MAP ARCHIVES