

U.S.G.S.
FILE COPY
Topographic and Historical

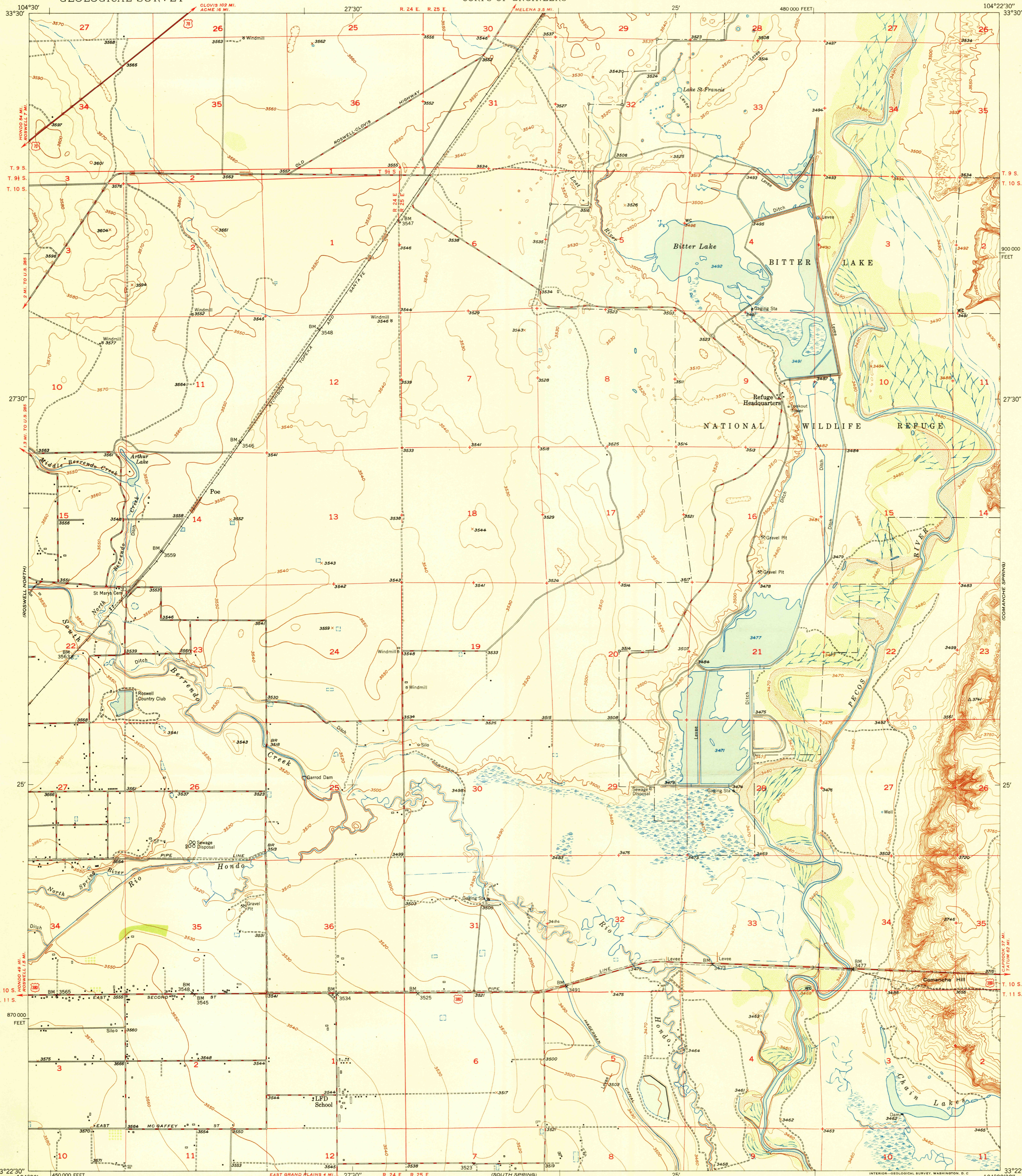

Mapped, edited, and published by the Geological Survey
Control by USGS and USC&GS
Culture and drainage in part compiled from
aerial photographs taken October 1947
Topography by plane-table methods 1949-1950
Polyconic projection. 1927 North American datum
10,000-foot grid based on New Mexico coordinate system,
east zone
Unchecked elevations are shown in brown

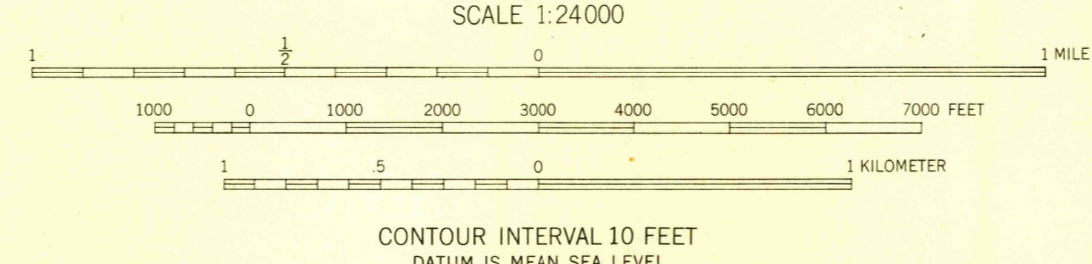
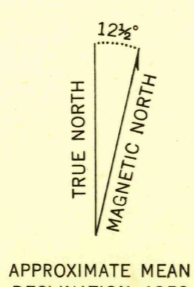

ROAD CLASSIFICATION

HARD-SURFACE ALL WEATHER ROADS	DRY WEATHER ROADS
Heavy-duty 4 LANE LANE	Improved dirt 2 LANE LANE
Medium-duty 2 LANE LANE	Unimproved dirt 1 LANE LANE
Loose-surface, graded, or narrow hard-surface	
U. S. Route	State Route

USGS
Historical File
Topographic Division
Topographic and Historical

BITTER LAKE, N. MEX.
N3322.5-W10422.5/7.5

FOR SALE BY U. S. GEOLOGICAL SURVEY, FEDERAL CENTER, DENVER, COLORADO OR WASHINGTON 25, D. C.
A FOLDER DESCRIBING TOPOGRAPHIC MAPS AND SYMBOLS IS AVAILABLE ON REQUEST

EDITION OF 1950

DEC 12 1950 3180