

PORTALES 5352 (11) (see 5000)

ARCH 1:62 5001

UNITED STATES DEPARTMENT OF THE INTERIOR GEOLOGICAL SURVEY

CAUSEY WEST QUADRANGLE NEW MEXICO—ROOSEVELT CO. 7.5 MINUTE SERIES (TOPOGRAPHIC)

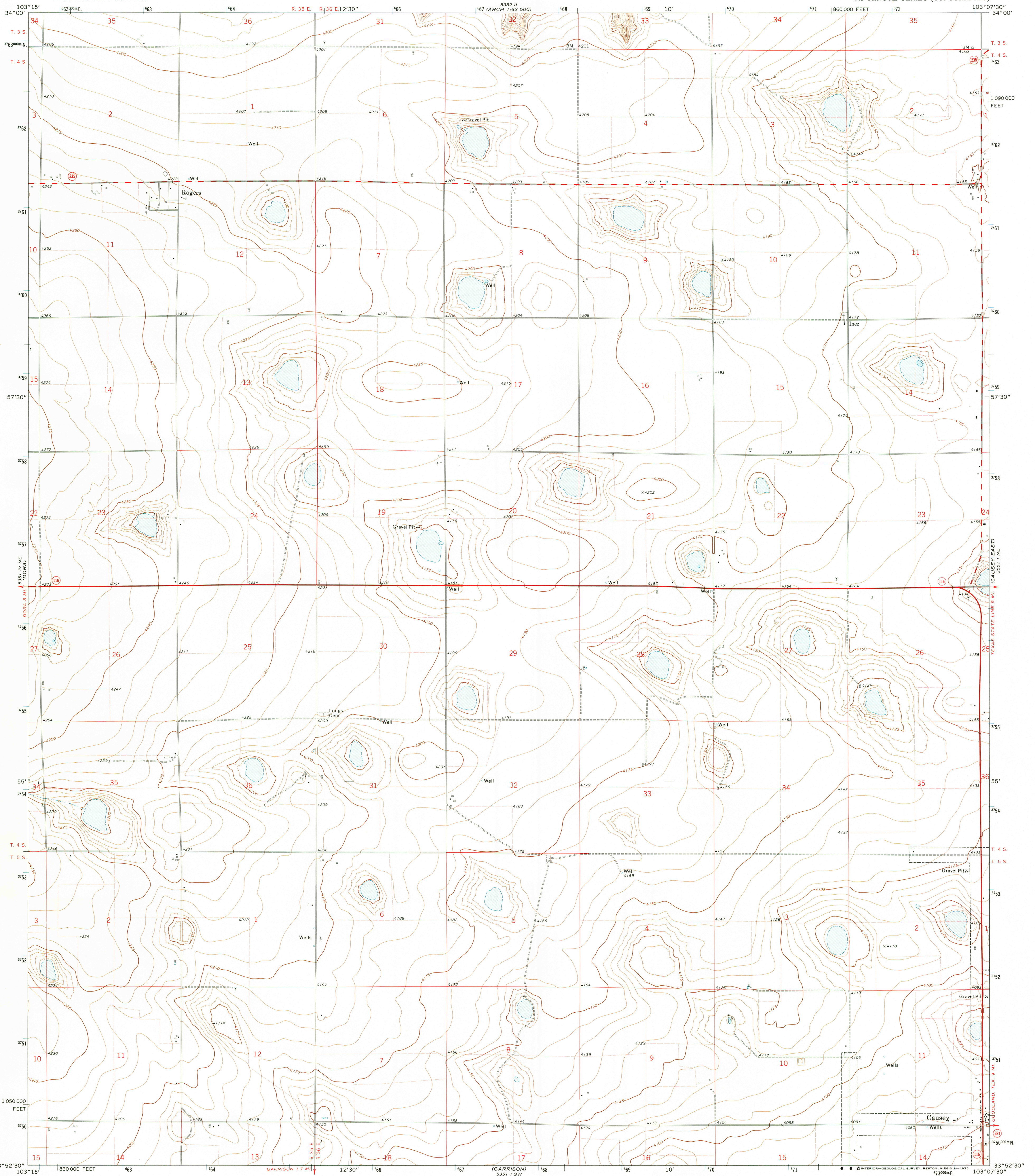

Mapped, edited, and published by the Geological Survey Control by USGS and USC&GS Topography by photogrammetric methods from aerial photographs taken 1971. Field checked 1972 Projection and 10,000-foot grid ticks: New Mexico coordinate system, east zone (transverse Mercator) 1000-meter Universal Transverse Mercator grid ticks, zone 13, shown in blue. 1927 North American datum Fine red dashed lines indicate selected fence lines

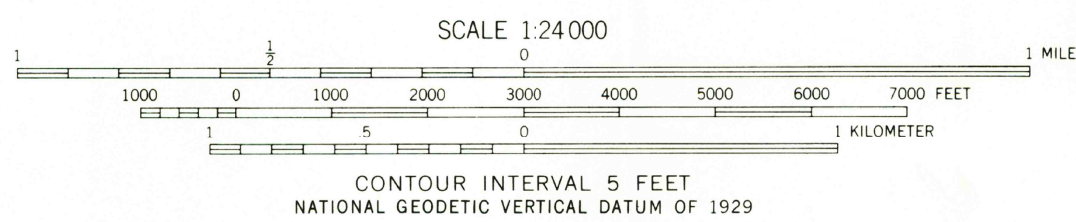
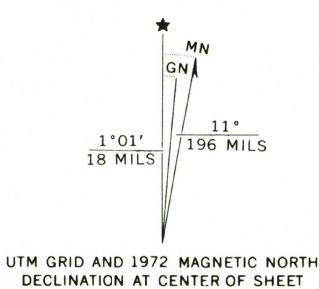

ROAD CLASSIFICATION table with symbols for primary, secondary, and unimproved roads, and various route types (Interstate, U.S., State).

THIS MAP COMPLIES WITH NATIONAL MAP ACCURACY STANDARDS FOR SALE BY U.S. GEOLOGICAL SURVEY, DENVER, COLORADO 80225 OR RESTON, VIRGINIA 22092 A FOLDER DESCRIBING TOPOGRAPHIC MAPS AND SYMBOLS IS AVAILABLE ON REQUEST

USGS Historical File Topographic Division

CAUSEY WEST, N. MEX. N3352.5-W10307.5/7.5

1972

AMS 5351 1 NW—SERIES V681

Handwritten notes: APR 8 1975 and 2450