

(ROSWELL SOUTH)

UNITED STATES
DEPARTMENT OF THE INTERIOR
GEOLOGICAL SURVEY

U.S.G.S.
FILE COPY
Inspection and Editing

UNITED STATES
DEPARTMENT OF THE ARMY
CORPS OF ENGINEERS

DEXTER WEST QUADRANGLE
NEW MEXICO-CHAVES CO.
7.5 MINUTE SERIES (TOPOGRAPHIC)

(BOTTOMLESS LAKE)

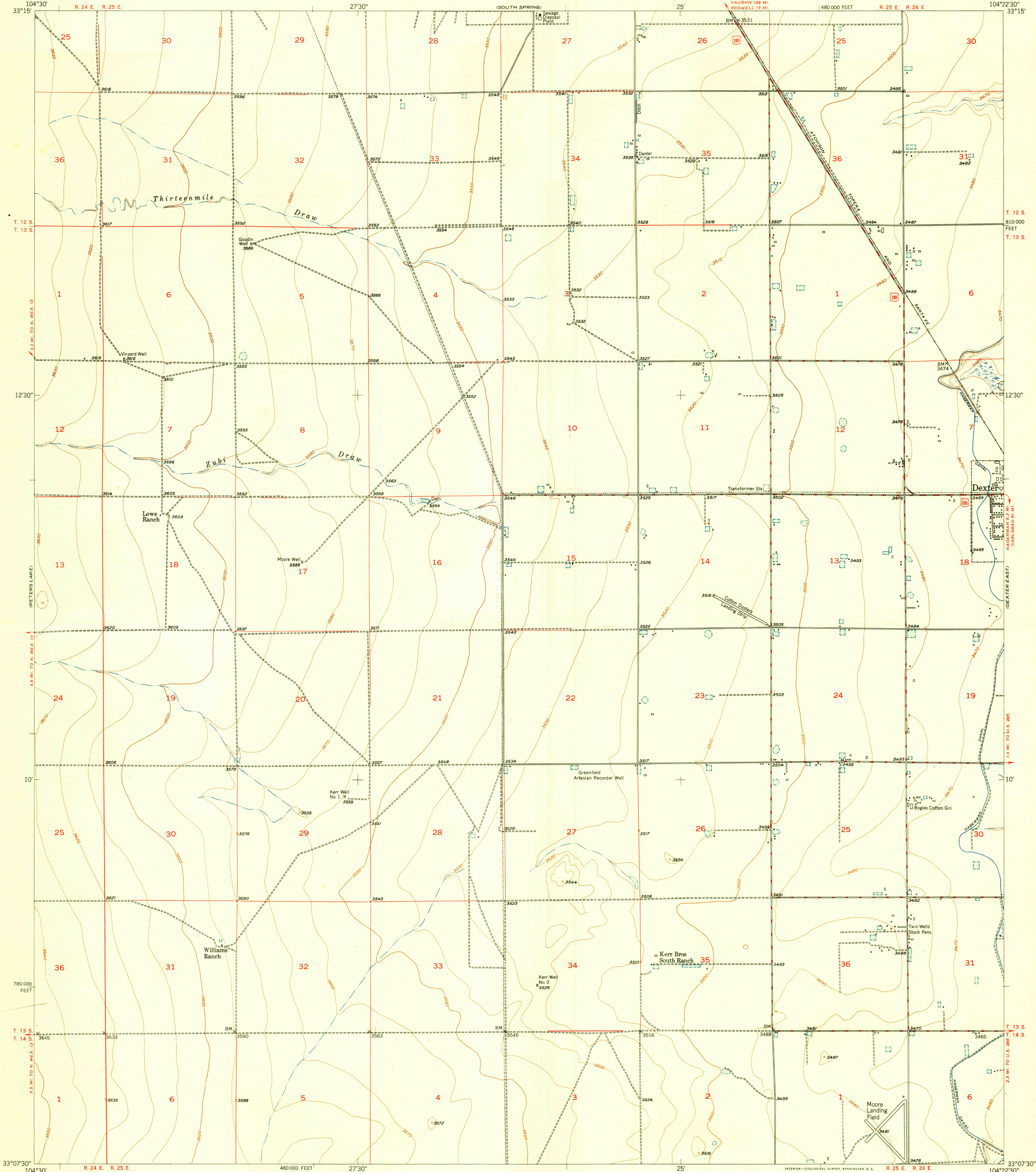

Maped, edited, and published by the Geological Survey
Control by USGS and USC&GS

Culture and drainage in part compiled from
aerial photographs taken October 1947
Topography by plane-table methods, 1949-1950
Polyconic projection. 1927 North American datum
10,000-foot grid based on New Mexico coordinate system,
east zone

TRUE NORTH
MAGNETIC NORTH
APPROXIMATE MEAN
DECLINATION, 1950

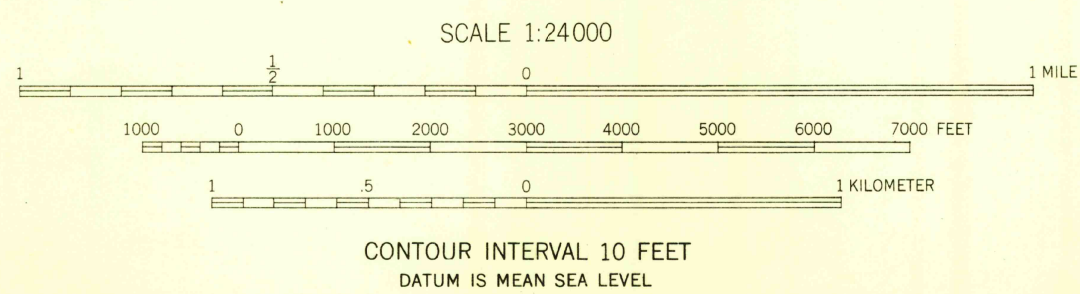

THIS MAP COMPLIES WITH NATIONAL MAP ACCURACY STANDARDS
FOR SALE BY U. S. GEOLOGICAL SURVEY, FEDERAL CENTER, DENVER, COLORADO OR WASHINGTON 25, D. C.
A FOLDER DESCRIBING TOPOGRAPHIC MAPS AND SYMBOLS IS AVAILABLE ON REQUEST

USGS
Historical File
Topographic Division

ROAD CLASSIFICATION
HARD-SURFACE ALL WEATHER ROADS DRY WEATHER ROADS
Heavy-duty 1 LANE 16 LANE Improved dirt
Medium-duty 1 LANE 16 LANE Unimproved dirt
Loose-surface, graded, or narrow hard-surface
U. S. Route State Route

U.S.G.S.
FILE COPY
Inspection and Editing

DEXTER WEST, N. MEX.
N3307.5-W10422.5/7.5

EDITION OF 1950