

U.S.G.S.
FILE COPY
Inspection and Rating.

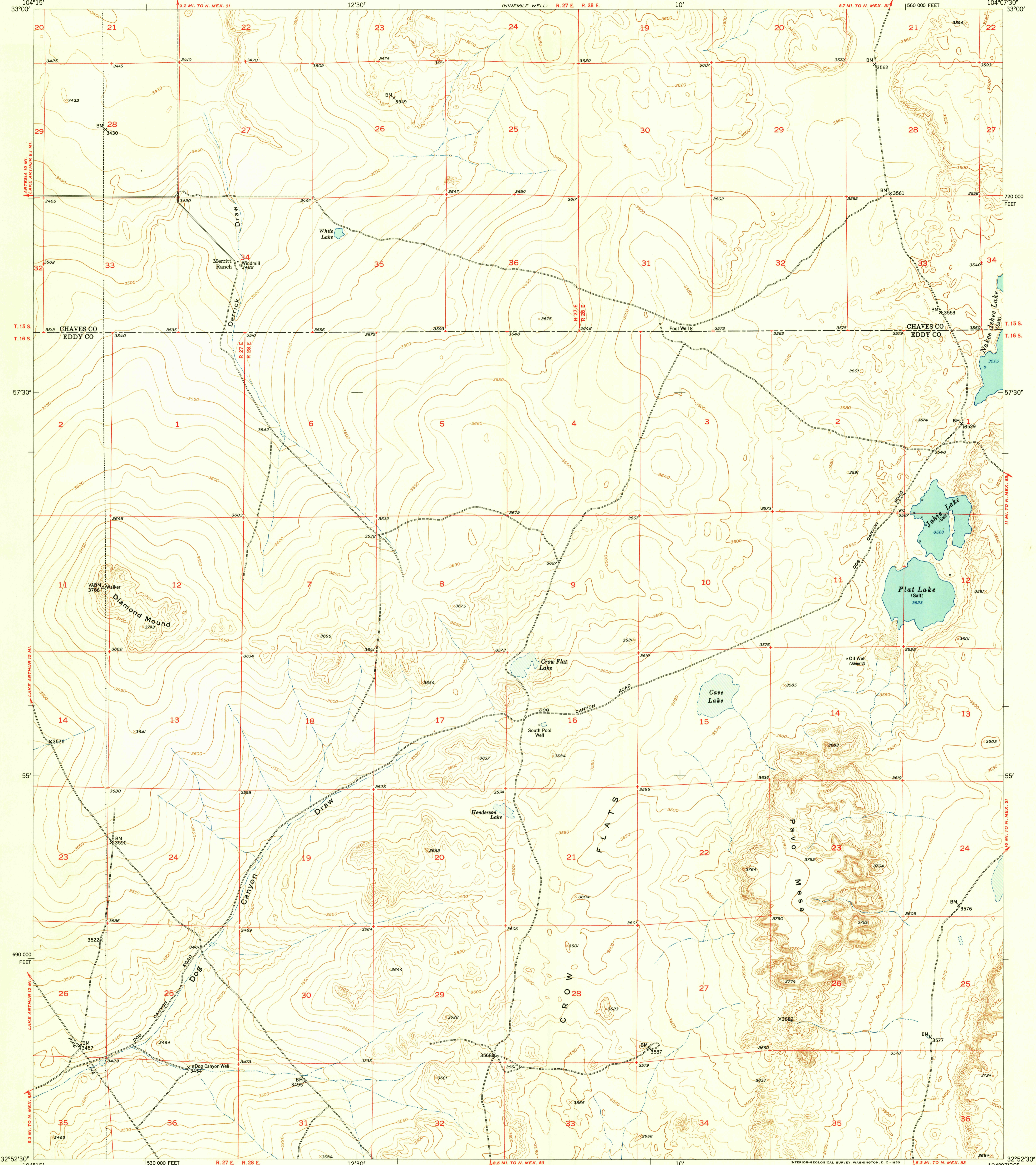

Mapped, edited, and published by the Geological Survey
Control by USGS and USC&GS

Culture and drainage in part compiled from
aerial photographs taken 1947
Topography by plane-table surveys 1951

Polyconic projection. 1927 North American datum
10,000-foot grid based on New Mexico coordinate system,
east zone

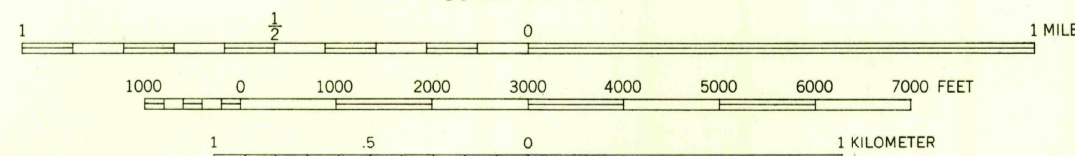
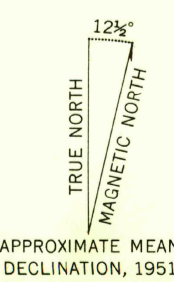

CONTOUR INTERVAL 10 FEET
DATUM IS MEAN SEA LEVEL

USCS
Historical File
Topographic Division

ROAD CLASSIFICATION	
Heavy-duty	4 LANE 16 LANE Light-duty
Medium-duty	4 LANE 16 LANE Unimproved dirt
U.S. Route	State Route

NEW MEXICO
QUADRANGLE LOCATION
U.S.G.S.
FILE COPY
Inspection and Rating.

DIAMOND MOUND, N. MEX.
N3252.5-W10407.5/7.5
1951

THIS MAP COMPLIES WITH NATIONAL MAP ACCURACY STANDARDS
FOR SALE BY U. S. GEOLOGICAL SURVEY, FEDERAL CENTER, DENVER, COLORADO OR WASHINGTON 25, D. C.
A FOLDER DESCRIBING TOPOGRAPHIC MAPS AND SYMBOLS IS AVAILABLE ON REQUEST