

4749 II SE OF THE
1982

UNITED STATES
DEPARTMENT OF THE INTERIOR
GEOLOGICAL SURVEY

FOSTER LAKE QUADRANGLE
NEW MEXICO-OTERO CO.
7.5 MINUTE SERIES (TOPOGRAPHIC)
NW/4 TRES HERMANOS 15' QUADRANGLE

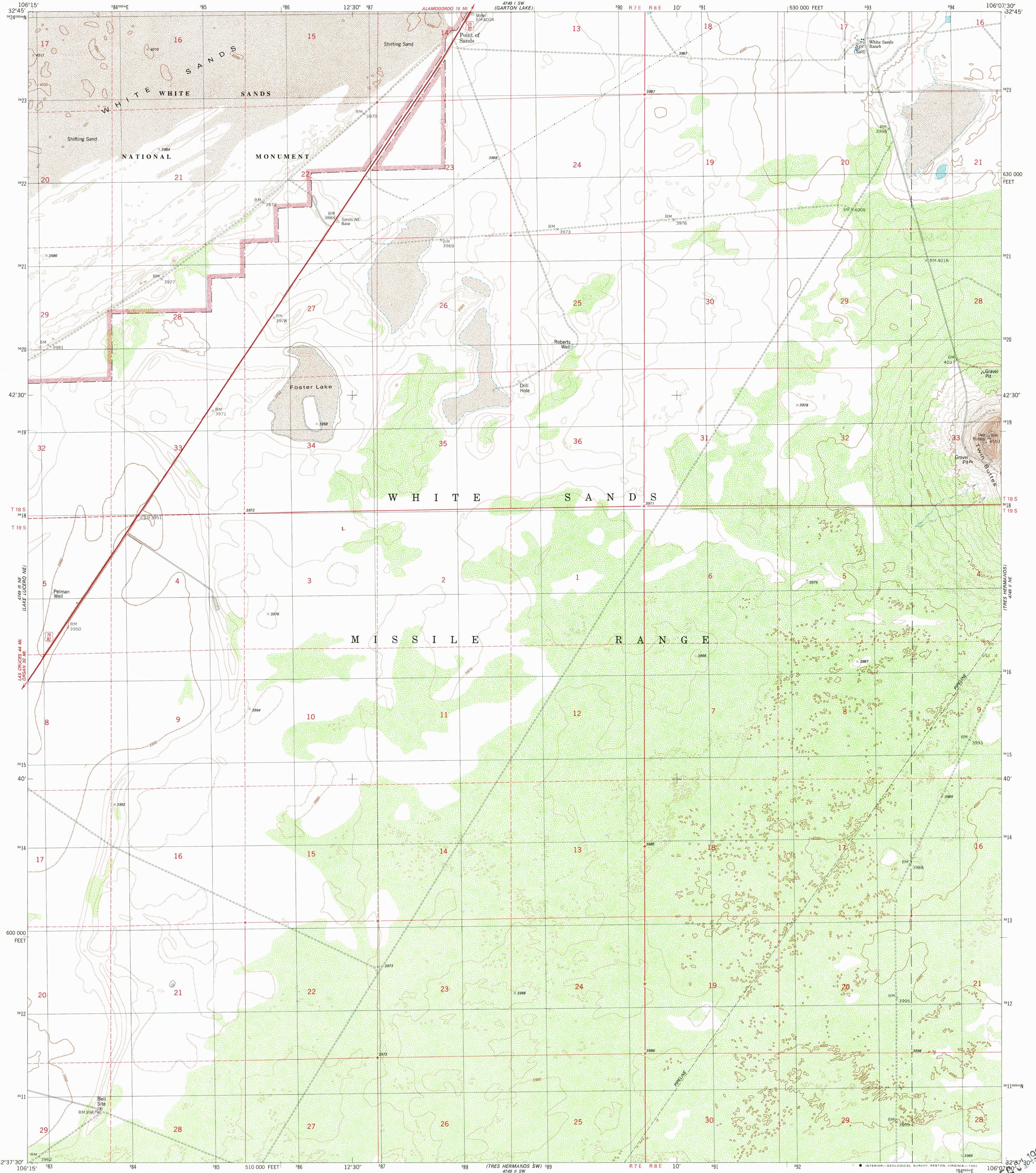

Mapped, edited, and published by the Geological Survey
Control by USGS and NOS/NOAA
Topography by photogrammetric methods from aerial photographs
taken 1972. Field checked 1975. Map edited 1982
Projection and 10,000-foot grid ticks: New Mexico
coordinate system, central zone (transverse Mercator)
1000-meter Universal Transverse Mercator grid, zone 13
1927 North American datum
To place on the predicted North American Datum 1983
move the projection lines 6 meters south and
51 meters east as shown by dashed corner ticks
Fine red dashed lines indicate selected fence lines
There may be private inholdings within the boundaries of
the National or State reservations shown on this map

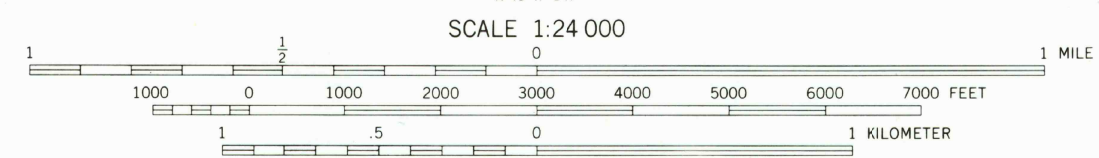
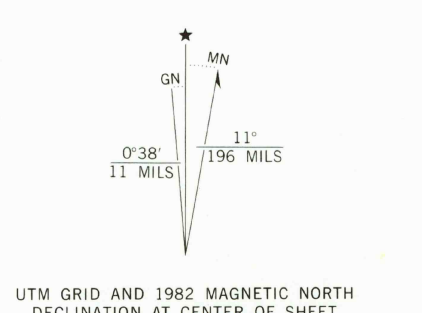

ROAD CLASSIFICATION

Primary highway, hard surface	Light-duty road, hard or improved surface
Secondary highway, hard surface	Unimproved road
Interstate Route	U. S. Route
	State Route

SCALE 1:24 000
CONTOUR INTERVAL 10 FEET
50-FOOT CONTOURS SHOWN IN SHIFTING SAND AREAS
NATIONAL GEODETIC VERTICAL DATUM OF 1929

FOSTER LAKE, N. MEX.
NW/4 TRES HERMANOS 15' QUADRANGLE
N3237.5-W10607.5/7.5
1982
DMA 4749 II NW-SERIES V881

RETURN TO:
USGS AND HISTORICAL MAP ARCHIVES

4749 II SE OF THE
1982