

POINT OF SANDS
1:25000

UNITED STATES
DEPARTMENT OF THE INTERIOR
GEOLOGICAL SURVEY

U.S.G.S.
FILE COPY
Inspection and Editing

UNITED STATES
DEPARTMENT OF THE ARMY
CORPS OF ENGINEERS
(POINT OF SANDS 1:25000)

LAKE LUCERO NE QUADRANGLE
NEW MEXICO-OTERO CO.
7.5 MINUTE SERIES (TOPOGRAPHIC)

POINT OF SANDS
1:25000

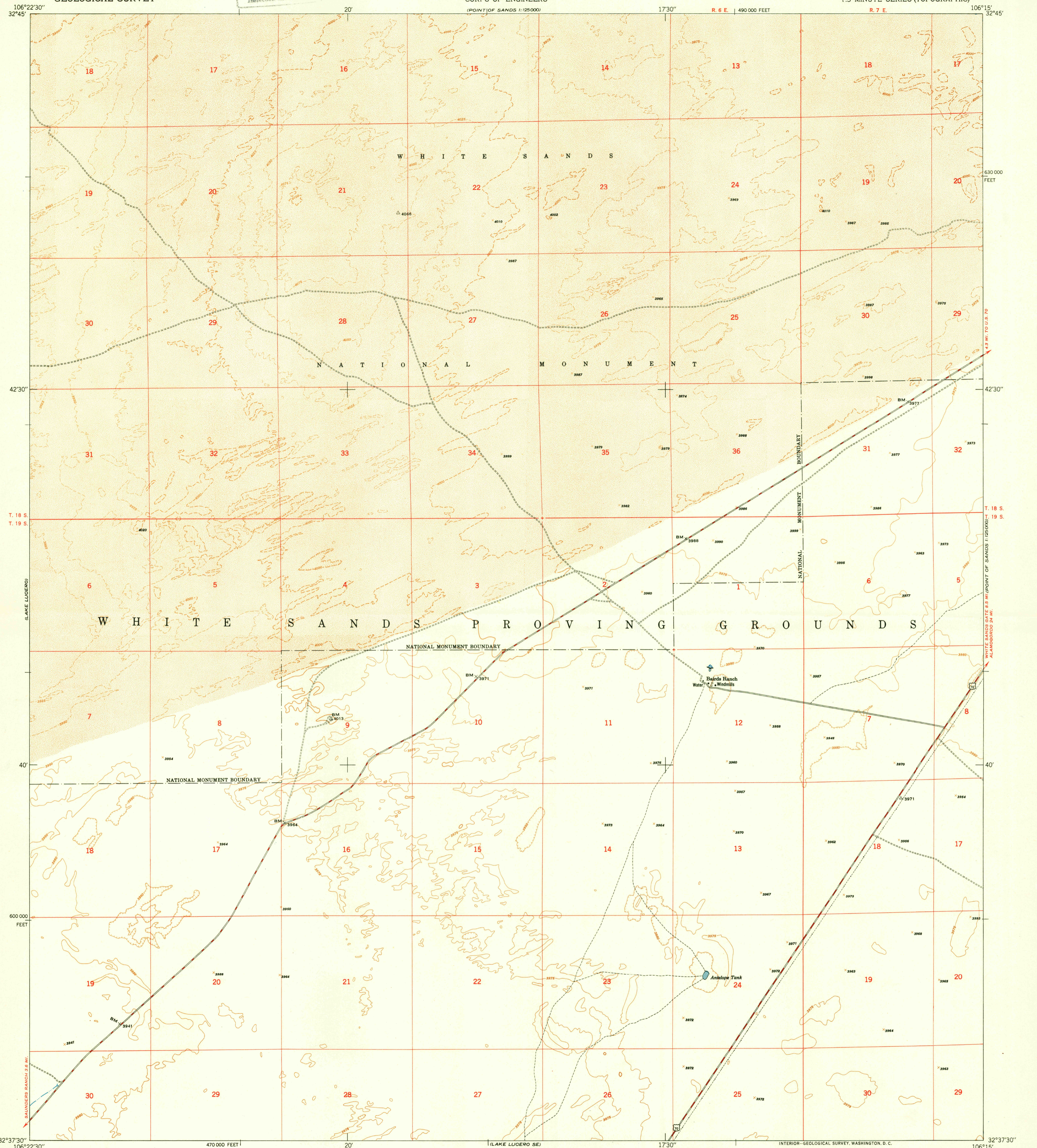

Mapped by the U. S. Forest Service
 Control by USGS, USC&GS, and AMS
 Topography from aerial photographs by photogrammetric methods
 Aerial photographs taken 1946 and 1948. Field check 1948
 Polyconic projection. 1927 North American datum
 10,000-foot grid based on New Mexico coordinate system,
 central zone

TRUE NORTH
 MAGNETIC NORTH
 APPROXIMATE MEAN
 DECLINATION, 1948

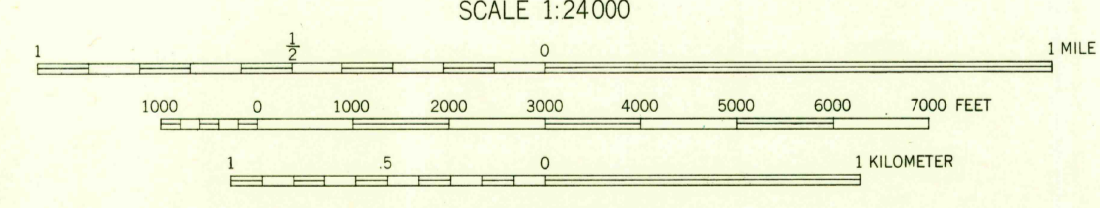

CONTOUR INTERVAL 25 FEET
 DASHED LINES REPRESENT HALF-INTERVAL CONTOURS
 DATUM IS MEAN SEA LEVEL

THIS MAP COMPLIES WITH NATIONAL MAP ACCURACY STANDARDS
 FOR SALE BY U. S. GEOLOGICAL SURVEY, FEDERAL CENTER, DENVER, COLORADO OR WASHINGTON 25, D. C.
 A FOLDER DESCRIBING TOPOGRAPHIC MAPS AND SYMBOLS IS AVAILABLE ON REQUEST

USGS
 Historical File
 Topographic Division

ROAD CLASSIFICATION
 HARD-SURFACE ALL WEATHER ROADS DRY WEATHER ROADS
 Heavy-duty ——— 2 LANE 2 LANE Improved dirt ———
 Medium-duty ——— 4 LANE 2 LANE Unimproved dirt ———
 Loose-surface, graded, or narrow hard-surface ———
 U. S. Route State Route

LAKE LUCERO NE, N. MEX.
 N3237.5—W10615/7.5

U.S.G.S.
 FILE COPY
 Inspection and Editing

EDITION OF 1950