

UNITED STATES  
DEPARTMENT OF THE INTERIOR  
GEOLOGICAL SURVEY

MELROSE EAST QUADRANGLE  
NEW MEXICO—CURRY CO.  
7.5 MINUTE SERIES (TOPOGRAPHIC)  
NE 1/4 MELROSE 15' QUADRANGLE

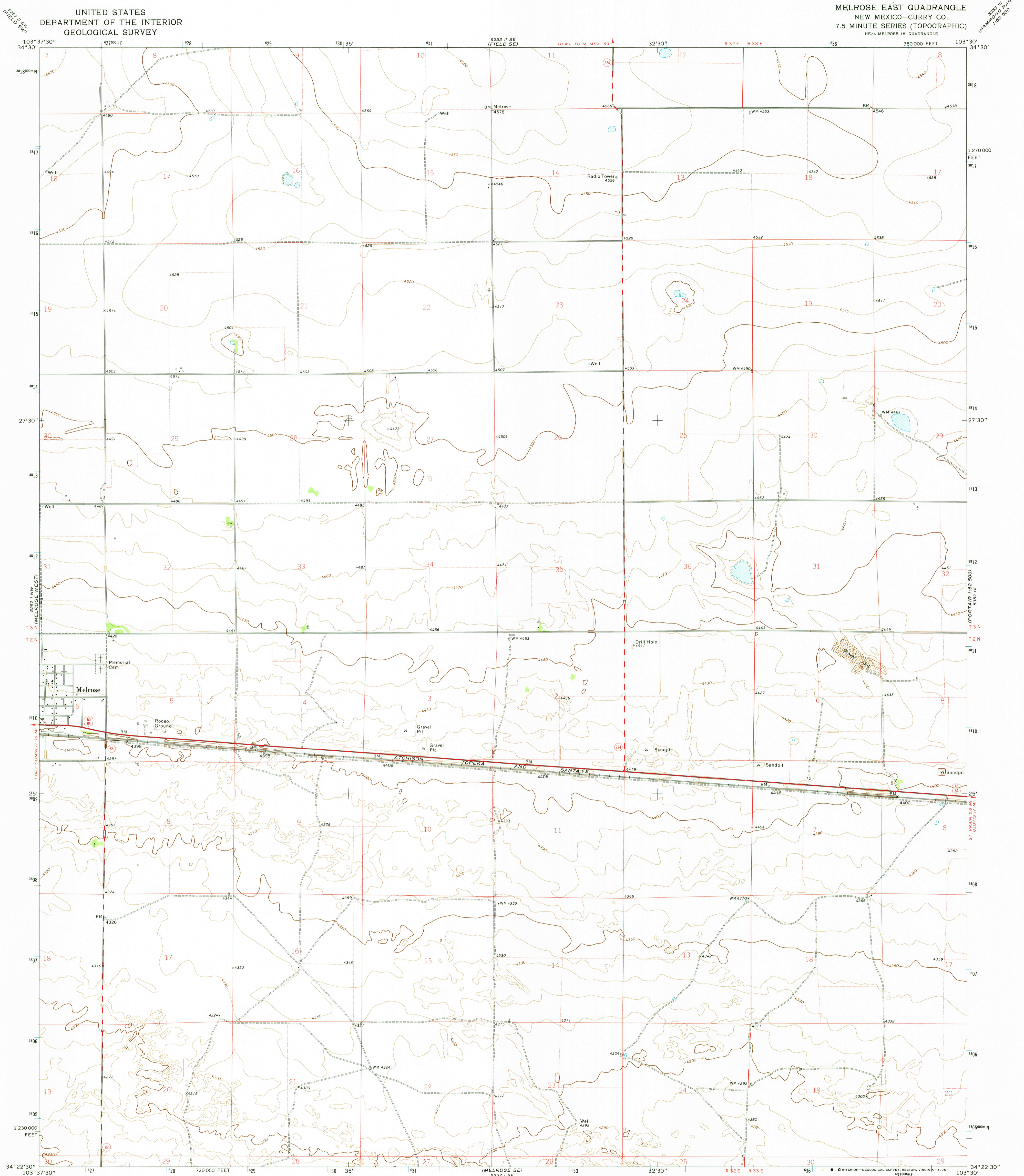

Mapped, edited, and published by the Geological Survey

Control by USGS and USC&GS

Topography by photogrammetric methods from aerial photographs taken 1972. Field checked 1972

Projection and 10,000-foot grid ticks: New Mexico coordinate system, east zone (transverse Mercator) 1000-metre Universal Transverse Mercator grid ticks, zone 13, shown in blue. 1927 North American datum

Fine red dashed lines indicate selected fence lines

Land lines, in part, are based on cultural developments and are not reflected in the original land survey

Certain land lines are omitted because of insufficient data

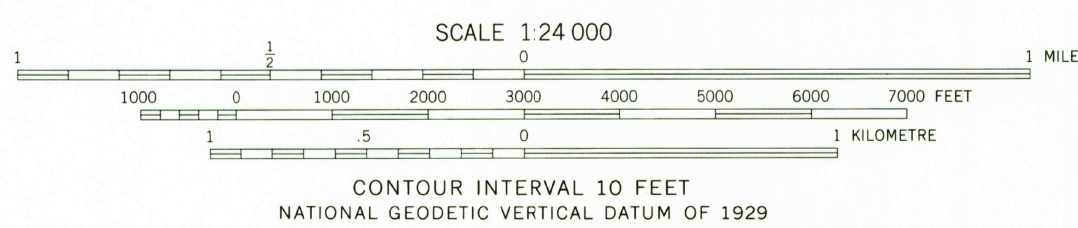
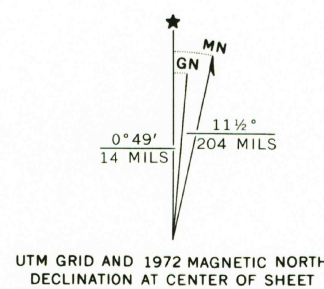

ROAD CLASSIFICATION

Primary highway, hard surface	Light duty road, hard or improved surface
Secondary highway, hard surface	Unimproved road
Interstate Route	U. S. Route
	State Route

USGS  
HISTORICAL FILE  
TOPOGRAPHIC DIVISION

MELROSE EAST, N. MEX.

NE 1/4 MELROSE 15' QUADRANGLE  
N 3422.5—W 10330/7.5

1972

AMS 5252 1 NE—SERIES V881

THIS MAP COMPLIES WITH NATIONAL MAP ACCURACY STANDARDS  
FOR SALE BY U.S. GEOLOGICAL SURVEY, DENVER, COLORADO 80225, OR RESTON, VIRGINIA 22092  
A FOLDER DESCRIBING TOPOGRAPHIC MAPS AND SYMBOLS IS AVAILABLE ON REQUEST

JAN 0 2 1976