

565 1/2' E
104°00' 103°55' W

UNITED STATES
DEPARTMENT OF THE INTERIOR
GEOLOGICAL SURVEY

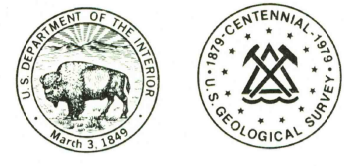

PRESLER LAKE QUADRANGLE
NEW MEXICO—CHAVES CO.
7.5 MINUTE SERIES (TOPOGRAPHIC)

565 1/2' E
103°52' 30" W

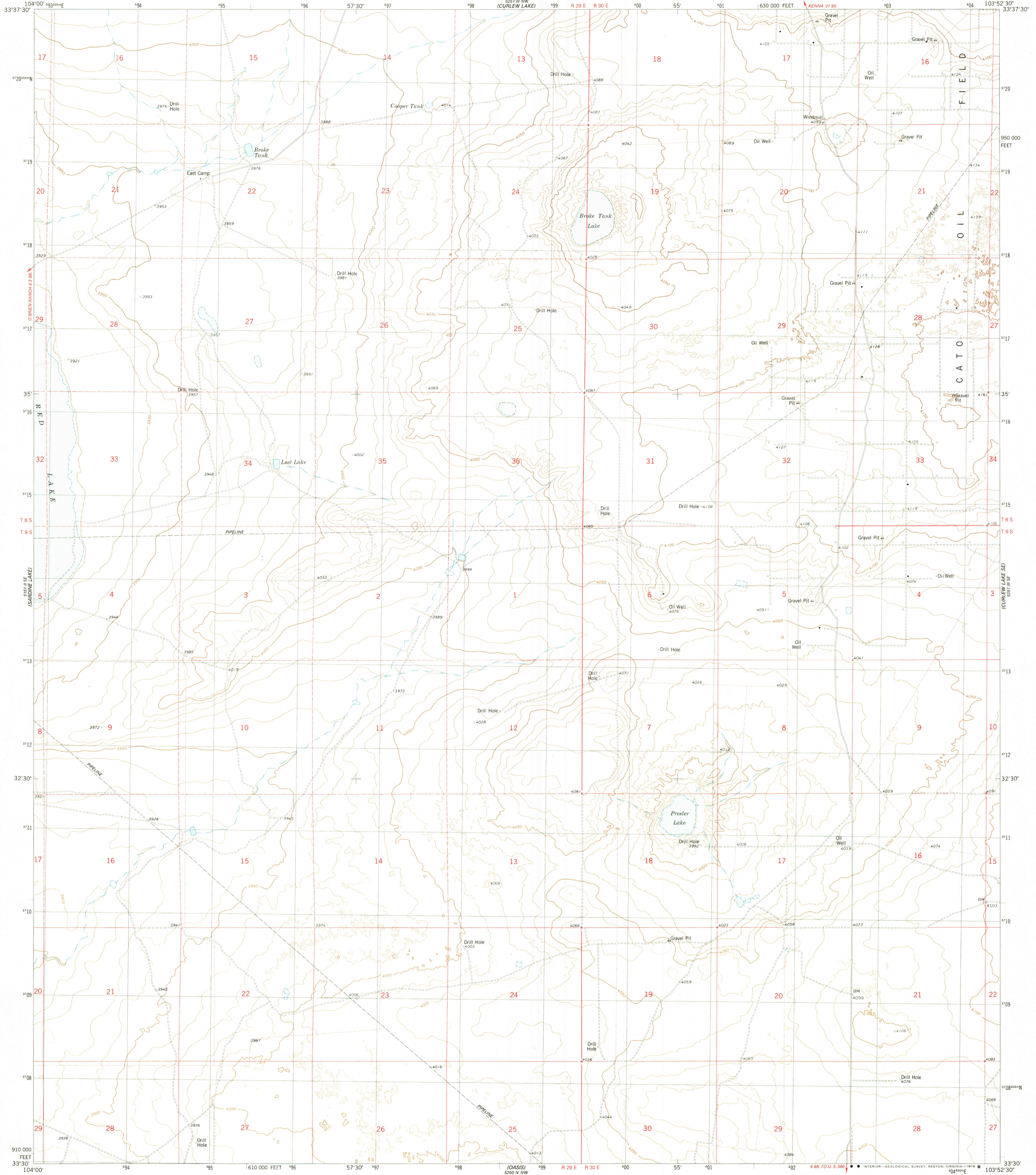

Mapped, edited, and published by the Geological Survey

Control by USGS and NOS/NOAA
Topography by photogrammetric methods from aerial photographs taken 1974. Field checked 1975. Map edited 1978
Projection and 10,000-foot grid ticks: New Mexico coordinate system, east zone (transverse Mercator) 1000-meter Universal Transverse Mercator grid, zone 13 1927 North American datum
Fine red dashed lines indicate selected fence lines

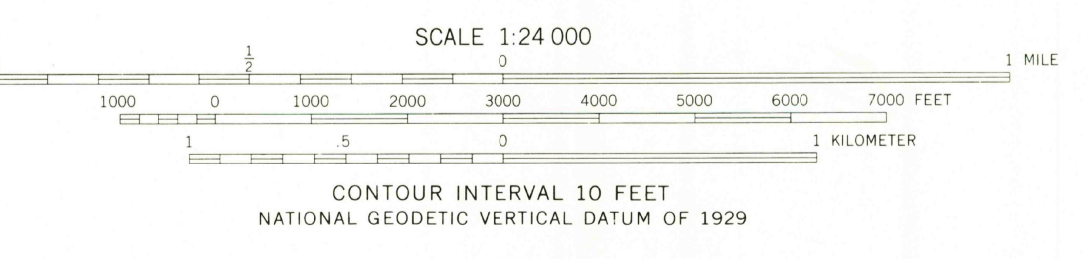
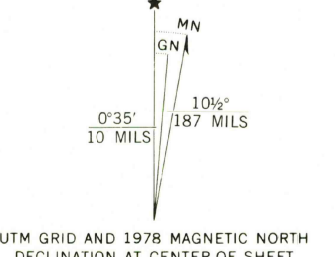

ROAD CLASSIFICATION

Primary highway, hard surface	Light-duty road, hard or improved surface
Secondary highway, hard surface	Unimproved road
Interstate Route	U. S. Route
	State Route

USGS
Historical File
Topographic Division
JUN 28 1979

PRESLER LAKE, N. MEX.
N3330-W10352.5/7.5

THIS MAP COMPLIES WITH NATIONAL MAP ACCURACY STANDARDS
FOR SALE BY U. S. GEOLOGICAL SURVEY, DENVER, COLORADO 80225, OR RESTON, VIRGINIA 22092
A FOLDER DESCRIBING TOPOGRAPHIC MAPS AND SYMBOLS IS AVAILABLE ON REQUEST

1978
AMS 5251 III SW—SERIES V81

2150