

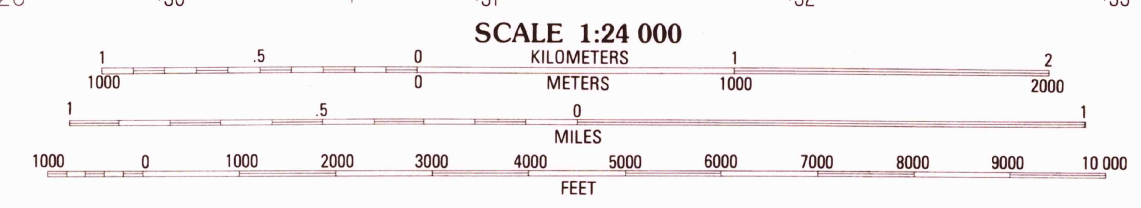

Produced by the United States Geological Survey
Control by USGS and NOS/NOAA
Compiled from aerial photographs taken 1987
Field checked 1989. Map edited 1992
North American Datum of 1927 (NAD 27). Projection and
10 000-foot grid ticks: New Mexico Coordinate System,
west zone (Transverse Mercator)
1000-meter Universal Transverse Mercator grid, zone 12
The difference between NAD 27 and North American Datum of
1983 (NAD 83) for 7.5 minute intersections is given in USGS
Bulletin 1875. The NAD 83 is shown by dashed corner ticks
There may be private inholdings within the boundaries of the
National or State reservations shown on this map
Fine red dashed lines indicate selected fence and field lines where
generally visible on aerial photographs. This information is
unchecked
Where omitted, land lines have not been established

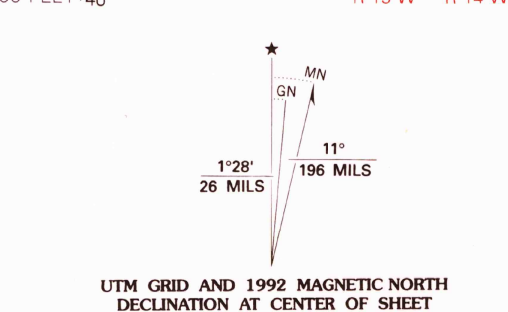

CONTOUR INTERVAL 20 FEET
NATIONAL GEODETIC VERTICAL DATUM OF 1929
TO CONVERT FEET TO METERS MULTIPLY BY 0.3048
TO CONVERT METERS TO FEET MULTIPLY BY 3.2808

THIS MAP COMPLIES WITH NATIONAL MAP ACCURACY STANDARDS
FOR SALE BY U.S. GEOLOGICAL SURVEY
DENVER, COLORADO 80225 OR RESTON, VIRGINIA 22092
A FOLDER DESCRIBING TOPOGRAPHIC MAPS AND SYMBOLS IS AVAILABLE ON REQUEST

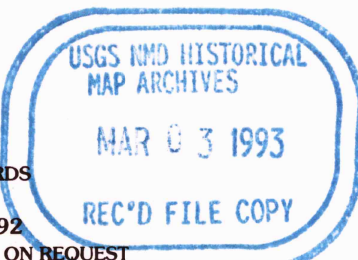

ROAD CLASSIFICATION

Primary highway, hard surface
Secondary highway, hard surface
Light-duty road, hard or improved surface
Unimproved road

Interstate Route U. S. Route State Route

1	2	3
4	5	6
7	8	

1 Canyon Hill
2 Granby Mountain
3 Copperas Peak
4 Dorsey Ranch
5 Twin Sisters
6 Circle Mesa
7 Silver City
8 Fort Bayard

READING MOUNTAIN, N. MEX.
32108-H3-TF-024
1992
DMA 4349 IV NE-SERIES V881