

UNITED STATES  
DEPARTMENT OF THE INTERIOR  
GEOLOGICAL SURVEY

RILEY CAMP QUADRANGLE  
NEW MEXICO—QUAY CO.  
7.5 MINUTE SERIES (TOPOGRAPHIC)

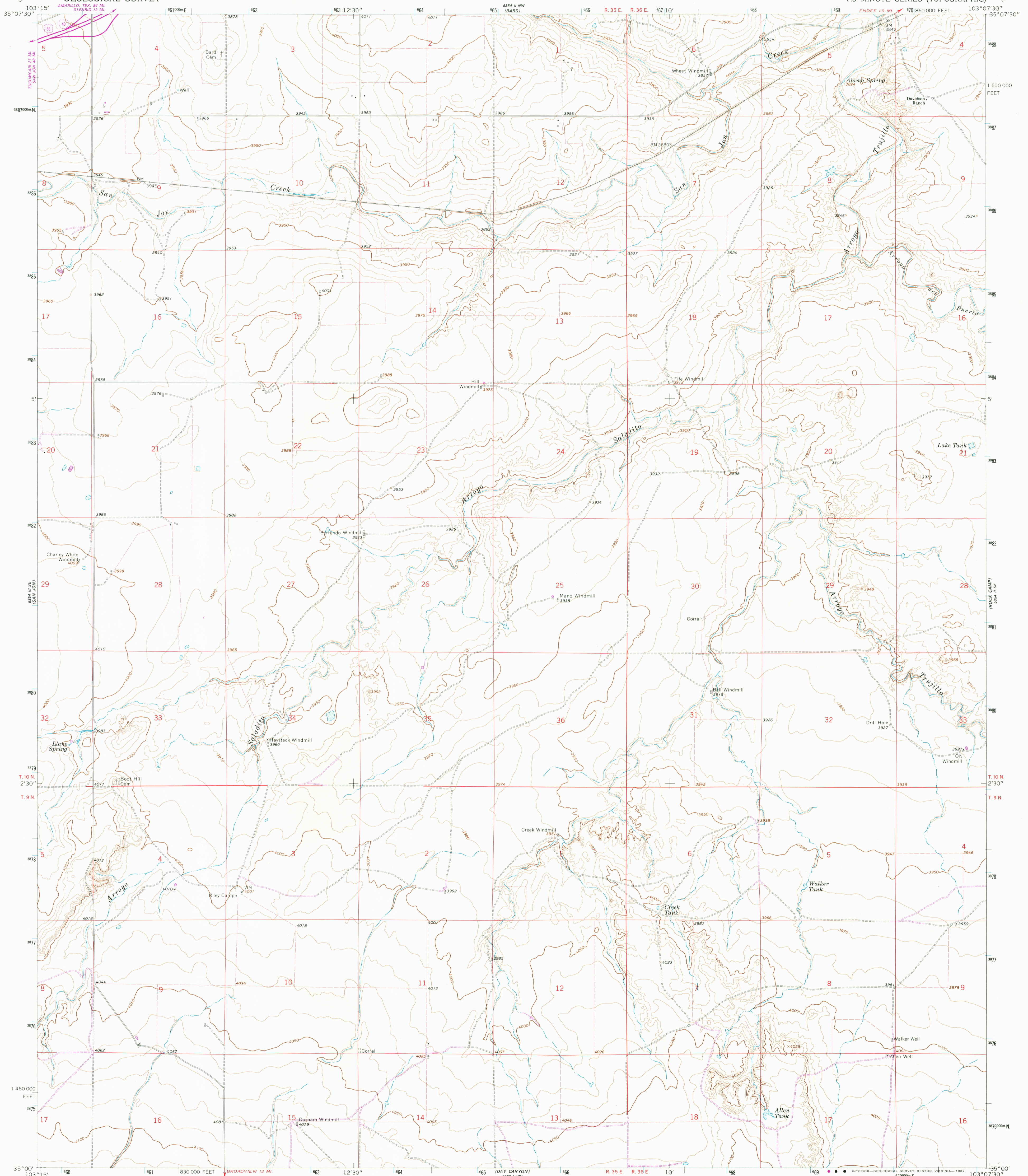

Mapped, edited, and published by the Geological Survey  
Control by USGS and NOS/NOAA

Topography by photogrammetric methods from aerial photographs taken 1967. Field checked 1968  
Polyconic projection. 10,000-foot grid ticks based on New Mexico coordinate system, east zone 1000-meter Universal Transverse Mercator grid ticks, zone 13, shown in blue. 1927 North American Datum To place on the predicted North American Datum 1983 move the projection lines 3 meters south and 44 meters east as shown by dashed corner ticks  
Fine red dashed lines indicate selected fence lines  
Revisions shown in purple and woodland compiled from aerial photographs taken 1979 and other sources. This information not field checked. Map edited 1981

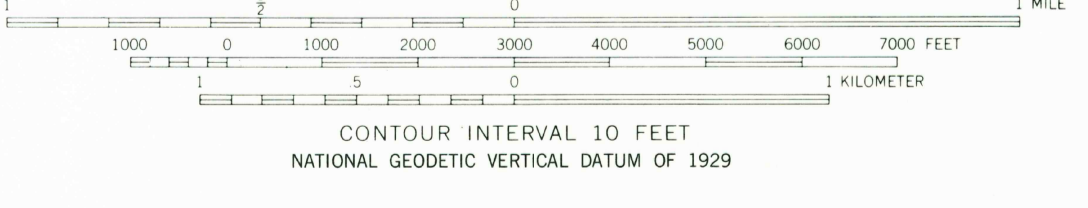
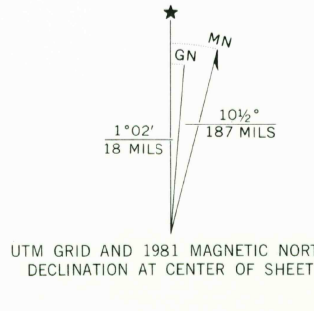

ROAD CLASSIFICATION

Primary highway, hard surface	Light duty road, hard or improved surface
Secondary highway, hard surface	Unimproved road
Interstate Route	U. S. Route
	State Route

THIS MAP COMPLIES WITH NATIONAL MAP ACCURACY STANDARDS  
FOR SALE BY U. S. GEOLOGICAL SURVEY, DENVER, COLORADO 80225, OR RESTON, VIRGINIA 22092  
A FOLDER DESCRIBING TOPOGRAPHIC MAPS AND SYMBOLS IS AVAILABLE ON REQUEST

RETURN TO:  
USGS NHD HISTORICAL MAP ARCHIVES

RILEY CAMP, N. MEX.  
N3500—W10307.5/7.5  
1968  
PHOTOREVISED 1981  
5354 II SW—SERIES V881

APR 23 1982

2211