

U.S.G.S.
FILE COPY
Inspection and Editing.

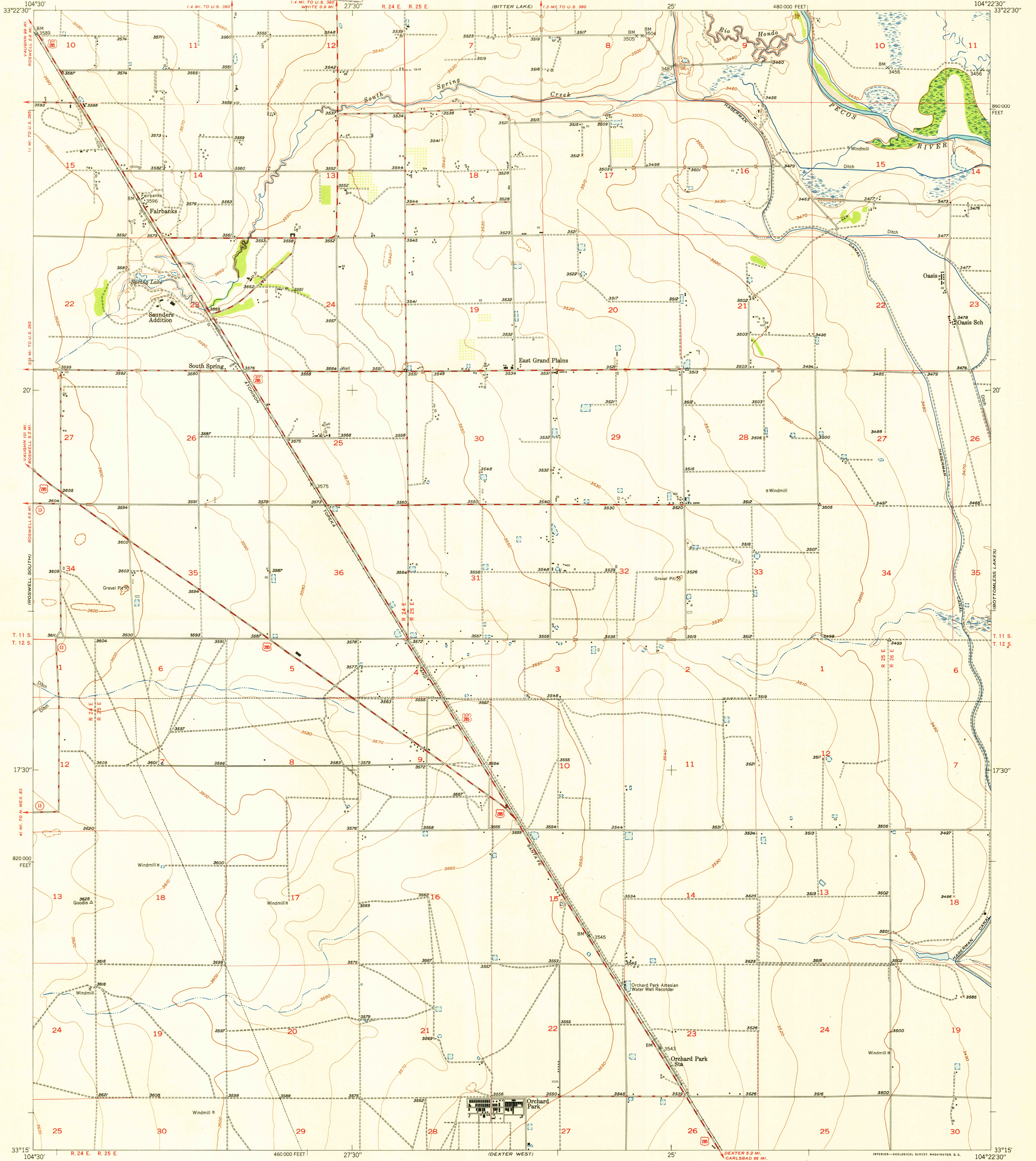

Maped, edited, and published by the Geological Survey
Control by USGS and USC&GS
Culture and drainage in part compiled from
aerial photographs taken March 1947
Topography by plane-table methods 1949-1950
Polyconic projection. 1927 North American datum
10,000-foot grid based on New Mexico coordinate system,
east zone

TRUE NORTH
MAGNETIC NORTH
APPROXIMATE MEAN
DECLINATION, 1950

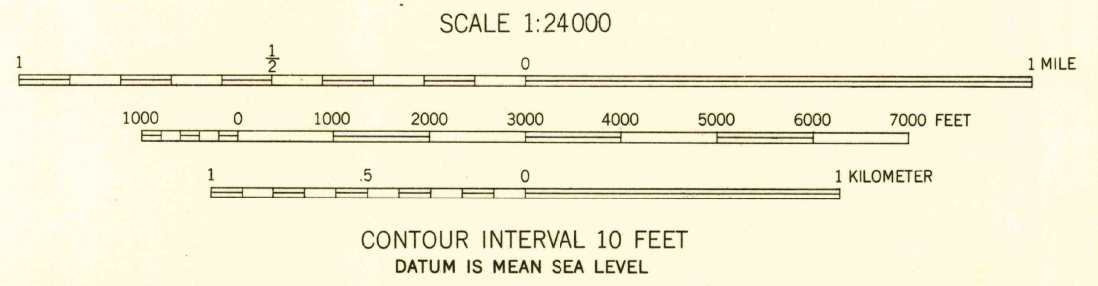

USGS
Historical File
Topographic Division

ROAD CLASSIFICATION
HEAVY-DUTY ALL WEATHER ROADS
Medium-duty - 2 LANE IS LANE
Loose-surface, graded, or narrow hard-surface -
U. S. Route
DRY WEATHER ROADS
Improved dirt
Unimproved dirt
State Route

U.S.G.S.
FILE COPY
Inspection and Editing.

THIS MAP COMPLIES WITH NATIONAL MAP ACCURACY STANDARDS
FOR SALE BY U. S. GEOLOGICAL SURVEY, FEDERAL CENTER, DENVER, COLORADO OR WASHINGTON 25, D. C.
A FOLDER DESCRIBING TOPOGRAPHIC MAPS AND SYMBOLS IS AVAILABLE ON REQUEST

SOUTH SPRING, N. MEX.
N3315-W10422.5/7.5
EDITION OF 1950