

U. S. G. S.
FILE COPY
Inspection and Editing.

U. S. G. S.
FILE COPY
Inspection and Editing.

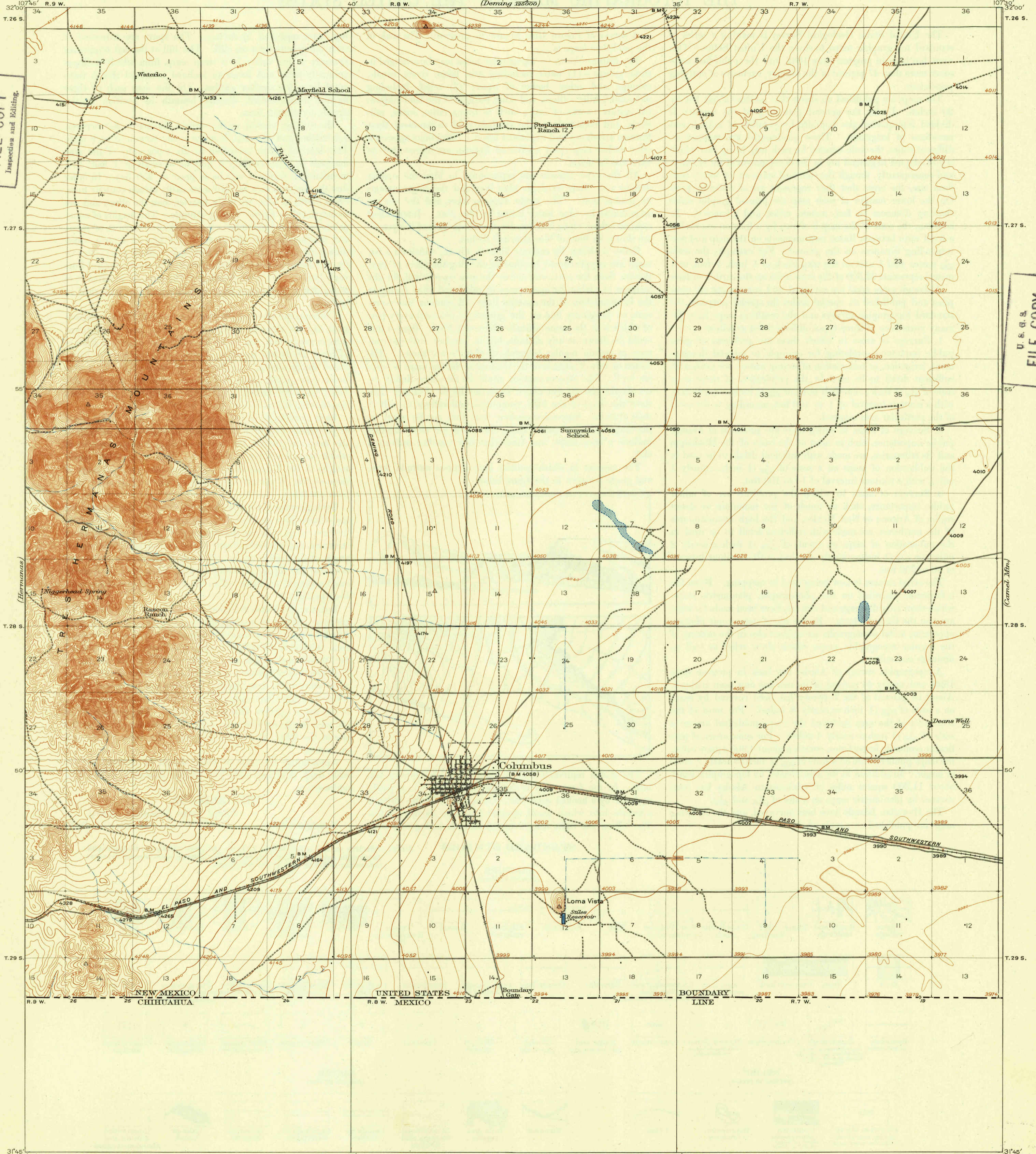

R.B. Marshall, Chief Geographer.
T.G. Gardine, Geographer in charge.
Glenn S. Smith, Topographic Engineer in charge Military Surveys.
Topography by J.G. Staack, R.H. Reineck, H.L. McDonald, and J.L. Lewis.
Control by International Boundary Commission,
C.L. Nelson, R.B. Steele, and R.W. Burchard.
Surveyed in 1917.

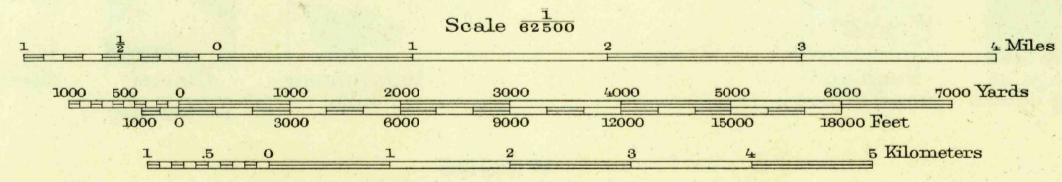
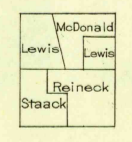

Contour interval 10 feet
Datum is mean sea level

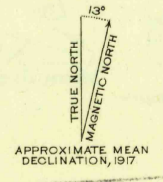

Edition of 1920.
(First published in 1917)
reprinted 1948
Polyconic projection. North American datum

COLUMBUS, N. MEX.
N3145-W10730/15

U. S. G. S.
Historical DIV
Topographic Division
Inspection and Editing.

SEP 24 1948

2085