

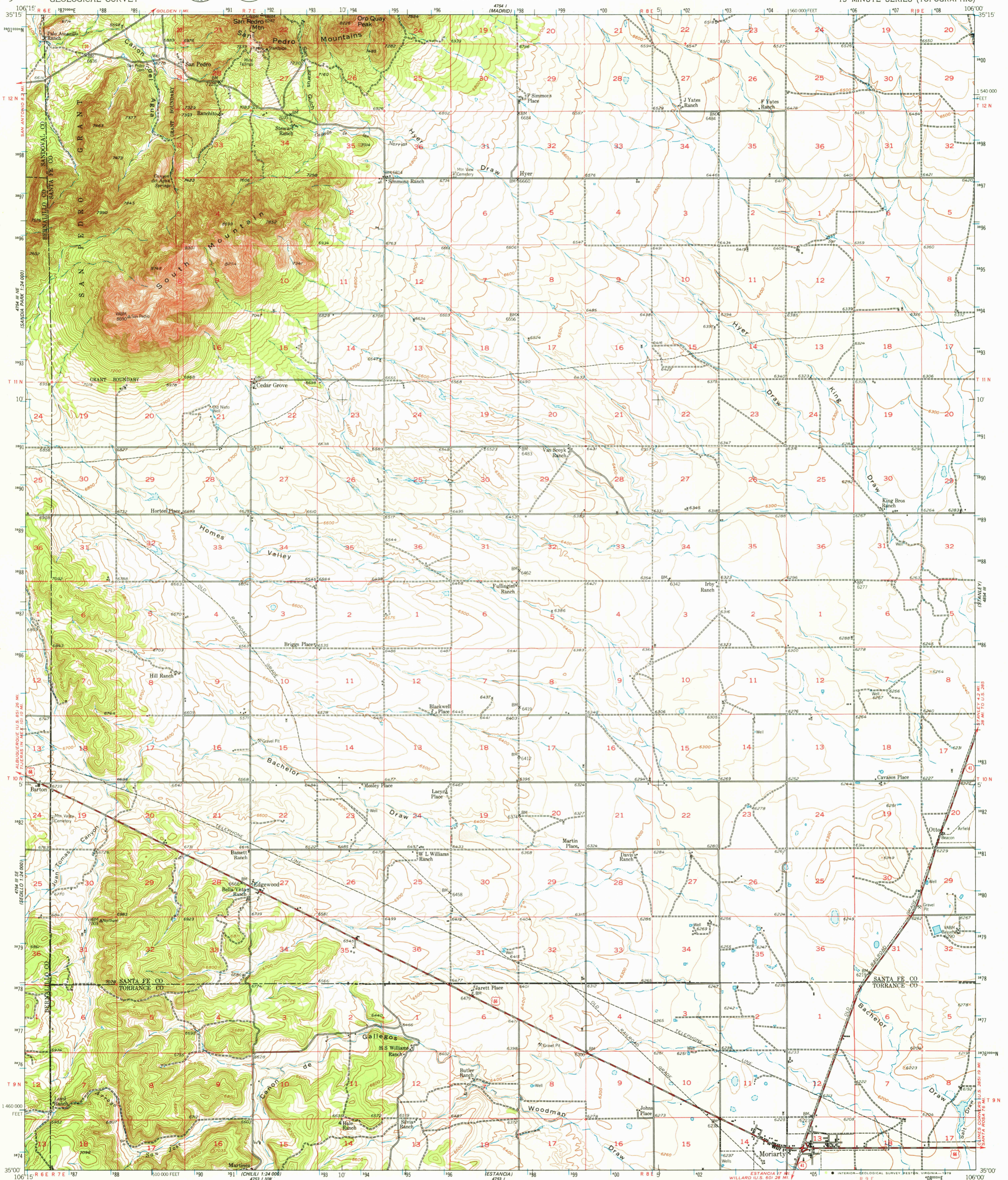

4754 (MADRID)
1:24,000

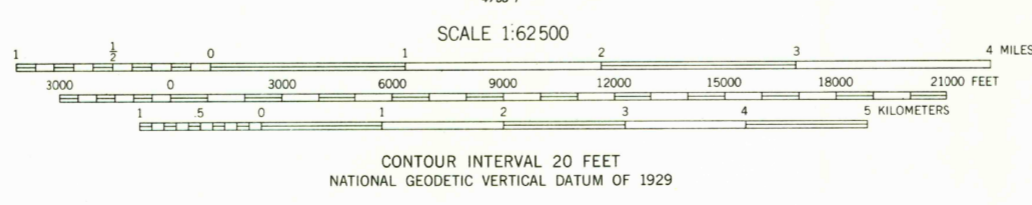

Mapped, edited, and published by the Geological Survey
Control by USGS and USC&GS
Topography from 1:24 000 scale maps of the San Pedro
and Edgewood 7.5 minute quadrangles, surveyed 1954,
and from aerial photographs by multiplex methods and by
planetable surveys 1956. Aerial photographs taken 1953
Polyconic projection. 1927 North American datum
10,000-foot grid based on New Mexico coordinate system,
central zone
1000-meter Universal Transverse Mercator grid ticks,
zone 13, shown in blue
Unchecked elevations are shown in brown

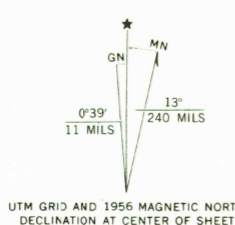

CLASSIFICATION
Medium duty ——— Light duty ———
Unimproved dirt ———
U. S. Route ——— State Route ———
The west half of this area is also covered by 1:24 000
scale maps of San Pedro and Edgewood 7.5 min
quadrangles, surveyed 1954

EDGEWOOD, N. MEX.
N3500—W10600/15

1956

AMS 4754 I—SERIES V781

THIS MAP COMPLIES WITH NATIONAL MAP ACCURACY STANDARDS
FOR SALE BY U. S. GEOLOGICAL SURVEY, DENVER, COLORADO 80225, OR RESTON, VIRGINIA 22092
A FOLDER DESCRIBING TOPOGRAPHIC MAPS AND SYMBOLS IS AVAILABLE ON REQUEST