

UNITED STATES
DEPARTMENT OF THE INTERIOR
GEOLOGICAL SURVEY

EDGEWOOD QUADRANGLE
NEW MEXICO
15 MINUTE SERIES (TOPOGRAPHIC)

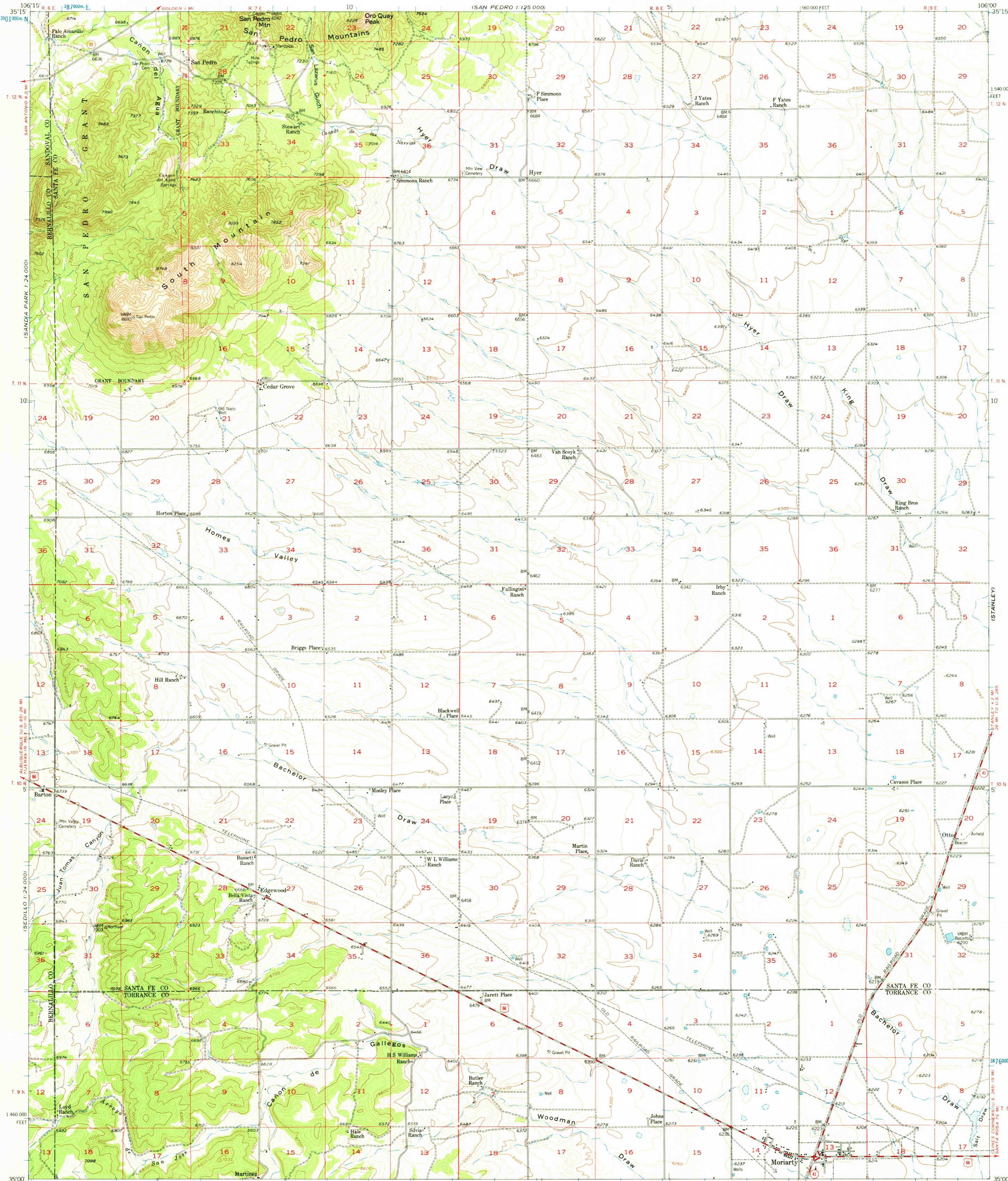

Mapped, edited, and published by the Geological Survey
Control by USGS and USC&GS
Topography from 1:24 000 scale maps of the San Pedro
and Edgewood 7.5 minute quadrangles, surveyed 1954,
and from aerial photographs by multiple methods and by
planetable surveys 1956. Aerial photographs taken 1953
Polyconic projection. 1927 North American datum
10,000-foot grid based on New Mexico coordinate system,
central zone
1000-meter Universal Transverse Mercator grid ticks,
zone 13, shown in blue
Unchecked elevations are shown in brown

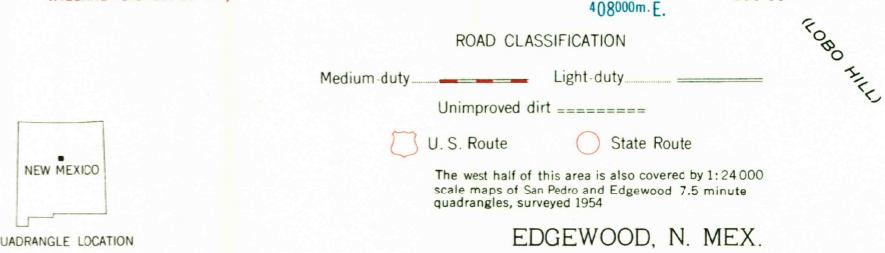
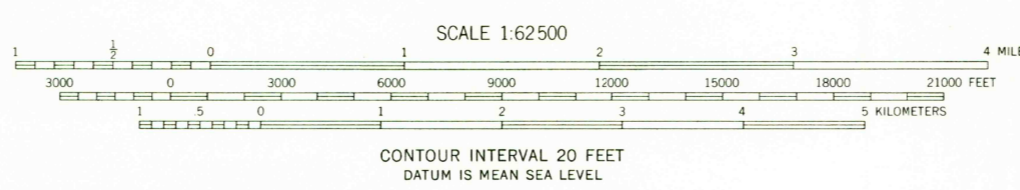

EDGEWOOD, N. MEX.
N3500—W10600/15

THIS MAP COMPLIES WITH NATIONAL MAP ACCURACY STANDARDS
FOR SALE BY U. S. GEOLOGICAL SURVEY, DENVER 25, COLORADO OR WASHINGTON 25, D. C.
A FOLDER DESCRIBING TOPOGRAPHIC MAPS AND SYMBOLS IS AVAILABLE ON REQUEST

1956