

UNITED STATES  
DEPARTMENT OF THE INTERIOR  
GEOLOGICAL SURVEY

MONUMENT QUADRANGLE  
NEW MEXICO-LEA CO.  
15 MINUTE SERIES (TOPOGRAPHIC)

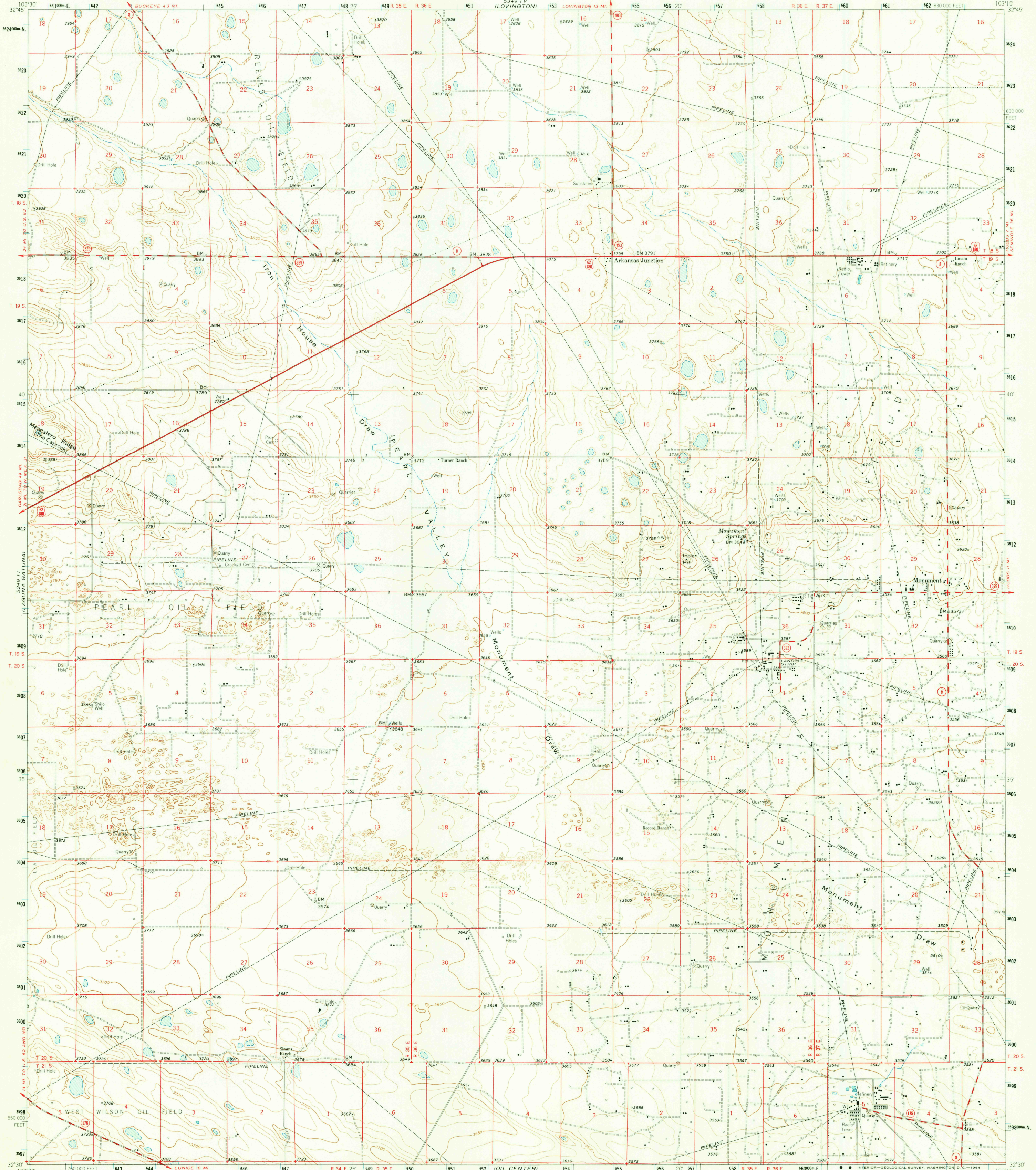

Mapped, edited, and published by the Geological Survey  
Control by USGS and USC&GS  
Planimetry by photogrammetric methods from aerial photographs  
taken 1957 Topography by planimetric surveys 1963  
Polyconic projection. 1927 North American datum  
10,000-foot grid based on New Mexico coordinate system, east zone  
1000-meter Universal Transverse Mercator grid ticks,  
zone 13, shown in blue

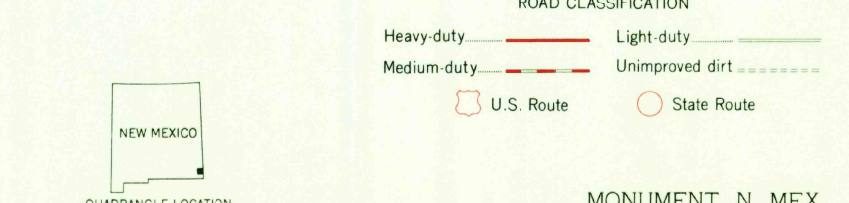
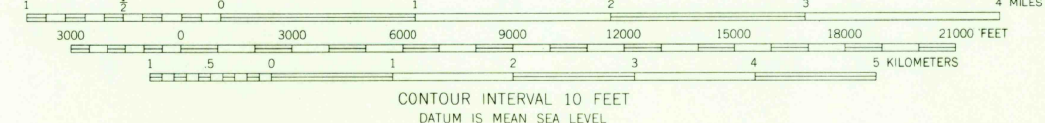
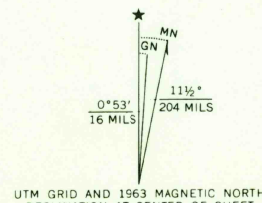

THIS MAP COMPLIES WITH NATIONAL MAP ACCURACY STANDARDS  
FOR SALE BY U.S. GEOLOGICAL SURVEY, DENVER 25, COLORADO OR WASHINGTON 25, D.C.  
A FOLDER DESCRIBING TOPOGRAPHIC MAPS AND SYMBOLS IS AVAILABLE ON REQUEST

MONUMENT, N. MEX.  
N3230-W10315/15  
1963  
AMS 5349 111-SERIES V781