



1460 000 YARDS
114° 30'

Topography by City of Los Angeles
Control by U. S. Geological Survey, U.S. Reclamation Service and
City of Los Angeles
Surveyed in 1926

USGS Library
Reston, VA.
Topo Archive

TRUE NORTH
MAGNETIC NORTH
APPROXIMATE MEAN
DECLINATION, 1926

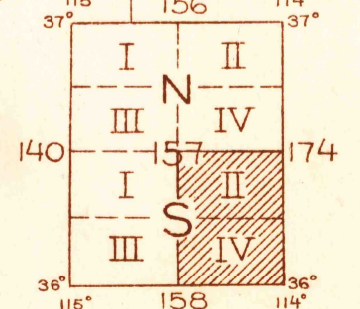
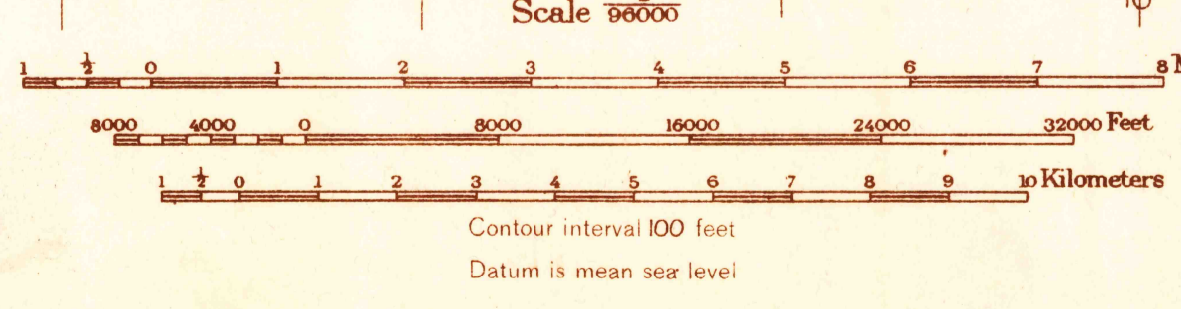

Polyconic projection. North American datum
5000 yard grid based upon U. S. zone system, F
Township lines added from General Land Office
notes, few corners having been found.
USGS
Historical File
Topographic Division
BONELLI, NEV.-ARIZ.