

(SCHENECTADY)

NEW YORK
SCALE 1:31,680

WAR DEPARTMENT
CORPS OF ENGINEERS, U. S. ARMY

HARPERSFIELD QUADRANGLE
7½-MINUTE SERIES

(SUMMIT)

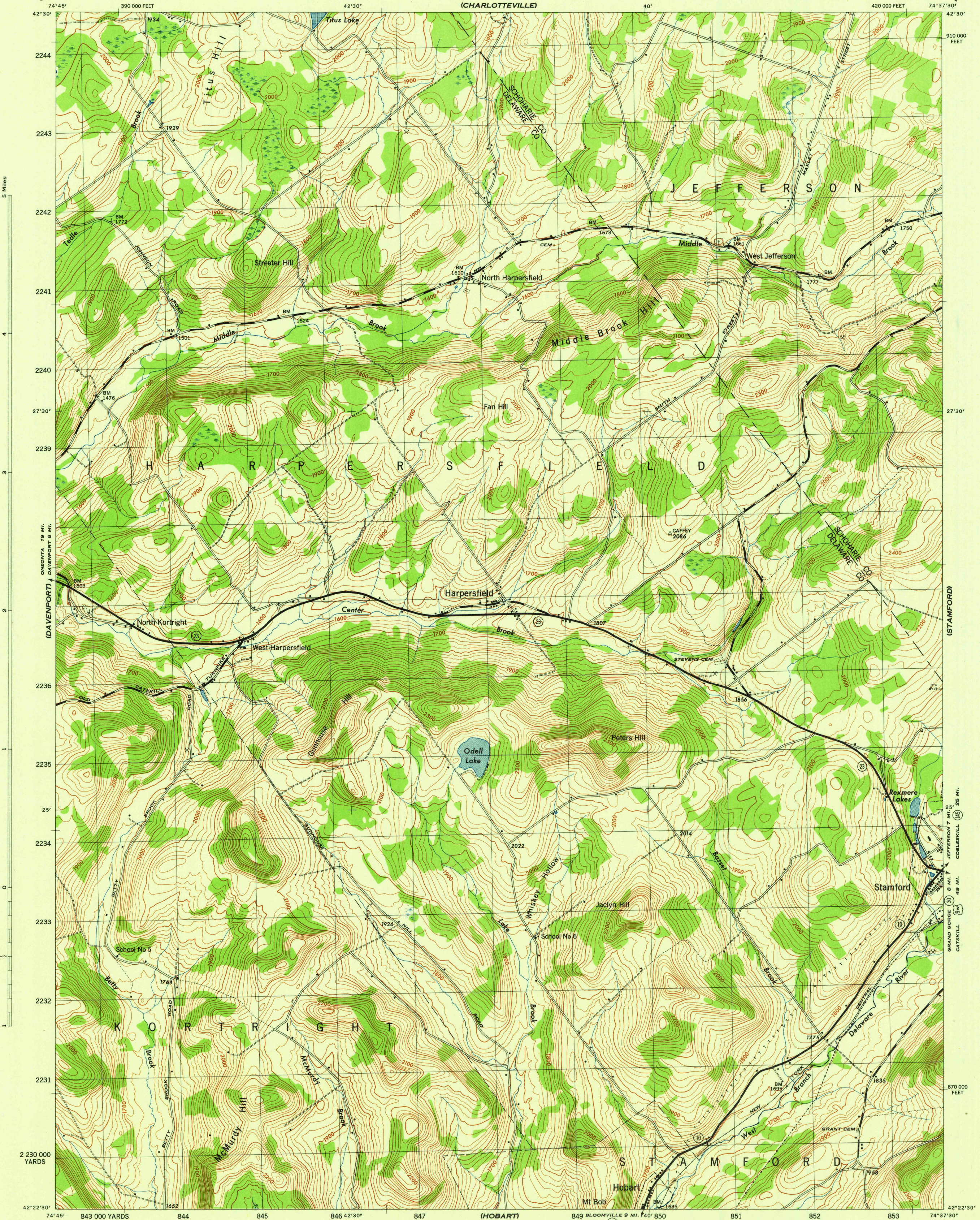

5 Miles

DAVENPORT

KORTRIGHT

(BLOOMVILLE)

Mapped by Tennessee Valley Authority under direction of the Chief of Engineers, U. S. Army, 1945.
Control by USCGS and TVA.
Topography by U. S. Geological Survey and Tennessee Valley Authority by Stereophotogrammetric methods (Multiplex).
Field completion surveys by TVA, 1941, 1942, and 1943.
Wide-angle photography for TVA, 1941, 1942, and 1943.
Polyconic projection, 1927 North American datum.

ROAD CLASSIFICATION
1945

Dependable hard-surface, heavy-duty road. ——— U. S. Route 29
Secondary hard-surface, all-weather road. ——— State Route 23
Loose-surface graded, dry-weather road. ———
Dirt road. ———
More than two lanes indicated by note along road with tick at point of change. 3 LANE 4 LANE

THIS MAP COMPLIES WITH THE NATIONAL STANDARD MAP ACCURACY REQUIREMENTS.

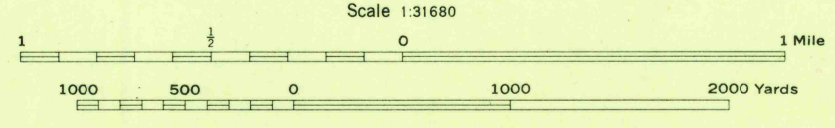

CONTOUR INTERVAL 20 FEET
DATUM IS MEAN SEA LEVEL

ONE THOUSAND YARD GRID COMPUTED FROM "GRID SYSTEM FOR PROGRESSIVE MAPS IN THE U. S." ZONE A, U. S. C. & G. S. SPECIAL PUBLICATION NO. 95. THE LAST THREE DIGITS OF THE GRID NUMBERS ARE OMITTED.

TEN THOUSAND FOOT GRID BASED ON NEW YORK PLANE COORDINATE SYSTEM, EASTERN ZONE.

NOTE: OFFICERS USING THIS MAP WILL FIND NEW CORRECTIONS AND ADJUSTMENTS WHICH ONE TO THEIR ATTENTION AND MAIL DIRECT TO THE ARMY MAP SERVICE, WASHINGTON, D. C.

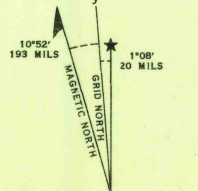

U. S. G. S.
FILE COPY
INSPECTION AND EDITING

USCS
Historical File
Topographic Division

HARPERSFIELD, N. Y.
N4222.5-7437.5/7.5
EDITION OF 1946

STAMFORD

JEFFERSON 7 MI. COBLESKILL 16 MI.

GRAND GEORGE 8 MI. CATSKILL 17 MI.

(ROXBURY)