

NEW YORK 1:31,680
(ONONDAGA COUNTY)

WAR DEPARTMENT
CORPS OF ENGINEERS, U. S. ARMY

SOUTH ONONDAGA QUADRANGLE
7 1/2 - MINUTE SERIES

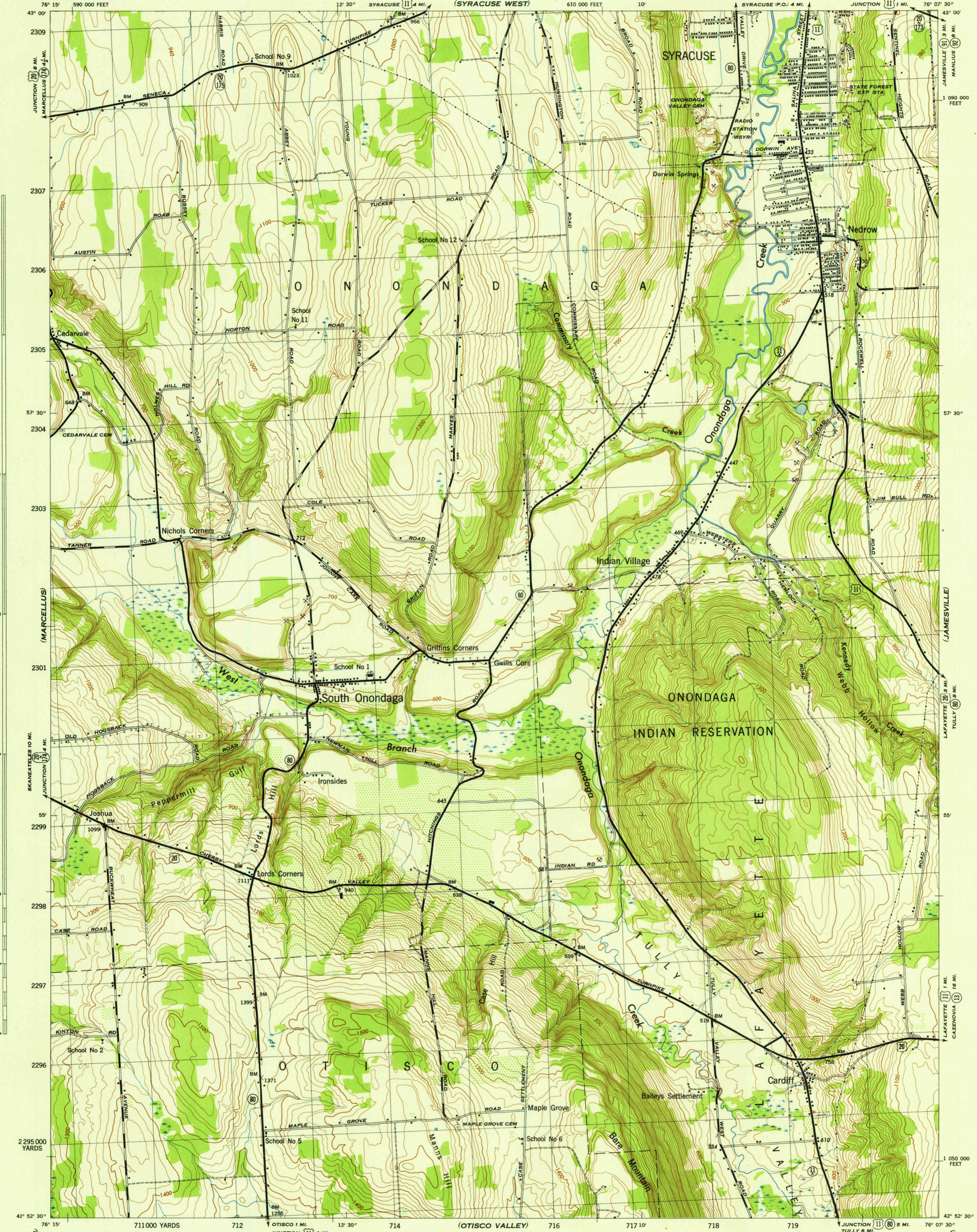

Mapped by Tennessee Valley Authority under direction of the Chief of Engineers, U. S. Army, 1943.
Control by USC&GS and TVA.
Topography by U. S. Geological Survey and Tennessee Valley Authority by Stereophotogrammetric methods (Multiplex).
Field completion surveys by TVA.
Wide-angle photography for TVA, 1942.
Polyconic projection. 1927 North American datum.

ROAD CLASSIFICATION
1943
Dependable hard-surface, all-weather road. Loose-surface graded, heavy-duty road. U. S. Route 88
Secondary, hard-surface, all-weather road. Dirt road. State Route 92
More than two lanes indicated by note along road with tick at point of change. 3 LANE 4 LANE

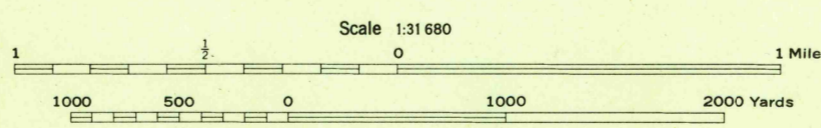

CONTOUR INTERVAL 20 FEET
DATUM IS MEAN SEA LEVEL

ONE THOUSAND YARD GRID COMPUTED FROM "GRID SYSTEM FOR PROGRESSIVE MAPS IN THE U. S. ZONE A, U. S. C. & S. SPECIAL PUBLICATION NO. 19"
THE LAST THREE DIGITS OF THE GRID NUMBERS ARE OMITTED
TEN THOUSAND FOOT GRID BASED ON NEW YORK PLANE COORDINATE SYSTEM, CENTRAL ZONE
NOTE: OFFICERS USING THIS MAP WILL MAKE NECESSARY CORRECTIONS AND ADJUSTMENTS WHICH COME TO THEIR ATTENTION AND MAIL THEM TO THE CHIEF OF ENGINEERS, WASHINGTON, D. C.

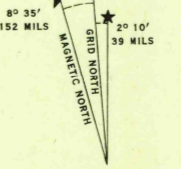

SOUTH ONONDAGA, N. Y.
N4252.5-W7607.5/7.5
EDITION OF 1943

USGS
Historical File
Topographic Division