

NEW YORK 1:31,680

WAR DEPARTMENT
CORPS OF ENGINEERS, U. S. ARMY

TRUMANSBURG QUADRANGLE

7 1/2 - MINUTE SERIES

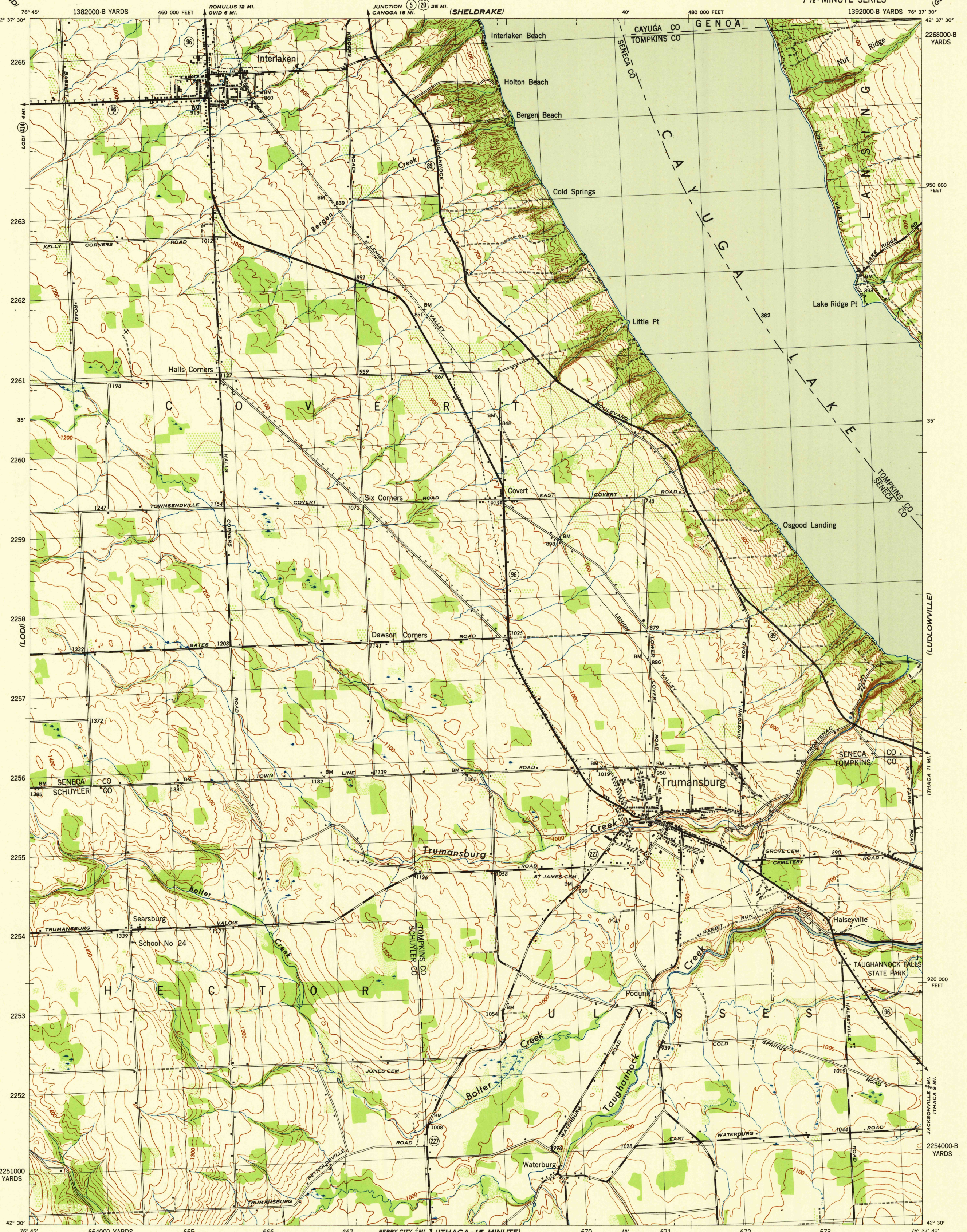

Mapped by Tennessee Valley Authority under direction of the Chief of Engineers, U. S. Army, 1942.
Control by USC&GS, and TVA.
Topography by U. S. Geological Survey and Tennessee Valley Authority by Stereophotogrammetric methods (Multiplex).
Field completion surveys by TVA.
Wide-angle photography for TVA, 1942.
Polyconic projection. 1927 North American datum.

ROAD CLASSIFICATION

Dependable hard-surface, heavy-duty road. Loose-surface graded, dry weather road. U. S. Route (10)

Secondary, hard surface, all-weather road. Dirt road. State Route (89)

More than two lanes indicated by note along road with tick at point of change. 3 LANE 4 LANE

Scale 1:31,680

1000 500 0 1000 2000 Yards

1 Mile

CONTOUR INTERVAL 20 FEET
DATUM IS MEAN SEA LEVEL

ONE THOUSAND YARD GRID COMPUTED FROM "GRID SYSTEM FOR PROGRESSIVE MAPS IN THE U. S." ZONE A, U. S. C. & G. S. SPECIAL PUBLICATION NO. 59

THE "A" LINE IS INDICATED BY THESE TICKS

THE LAST THREE DIGITS OF THE GRID NUMBERS ARE OMITTED

TEN THOUSAND FOOT GRID BASED ON NEW YORK PLANE COORDINATE SYSTEM, CENTRAL ZONE

NOTE: OFFICERS USING THIS MAP WILL MARK REVISION CORRECTIONS AND ADDITIONS WHICH COME TO THEIR ATTENTION AND MAIL SHEET TO "THE CHIEF OF ENGINEERS, WASHINGTON, D. C."

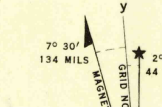

WOODLAND CLASSIFICATION

Dense woodland

Dense brush

Scattered brush and trees

Orchard

Vineyard

USGS
Historical File
Topographic Division

TRUMANSBURG, N. Y.
N4230-W7637.5/7.5
EDITION OF 1943