

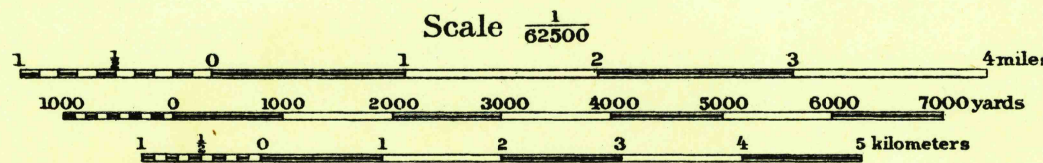

Base map from U. S. G. S. engravings, surveyed in 1903.
Additional field work and compilation under the direction
of Col. W. M. Black, Corps of Engineers, U. S. A.,
Department Engineer, Eastern Division.
Additional field work by 2nd Lieut. Walter H. Frank, 5th
Infantry, U. S. Army, June-July 1911.
Soundings expressed in feet and referred to mean low
water are from U. S. C. & G. S. Charts Nos. 115 & 118.



Contour Interval 20 feet
Datum is mean sea level

FIVE THOUSAND YARD GRID COMPUTED FROM "GRID SYSTEM FOR PROGRESSIVE MAPS
IN THE U. S." ZONE A, U. S. C. & G. S. SPECIAL PUBLICATION NO. 59.
(THE LAST THREE DIGITS OF THE GRID NUMBERS ARE OMITTED)

NOTE: OFFICERS USING THIS MAP WILL MARK HEREON CORRECTIONS AND ADDITIONS WHICH COME
TO THEIR ATTENTION AND MAIL DIRECT TO "THE CHIEF OF ENGINEERS, WASHINGTON, D. C."

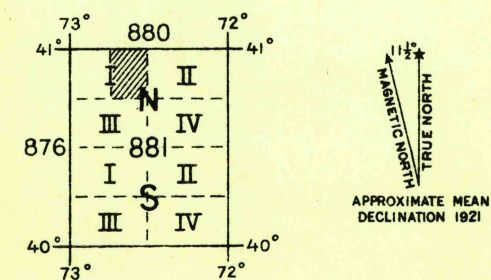

RIVERHEAD