

TOLEDO (CHERRY STREET BRIDGE) 3 1/2 MI.
UNITED STATES
DEPARTMENT OF THE INTERIOR
GEOLOGICAL SURVEY

OHIO
WALBRIDGE QUADRANGLE
STATE HIGHWAY NO. 2 1 MI.

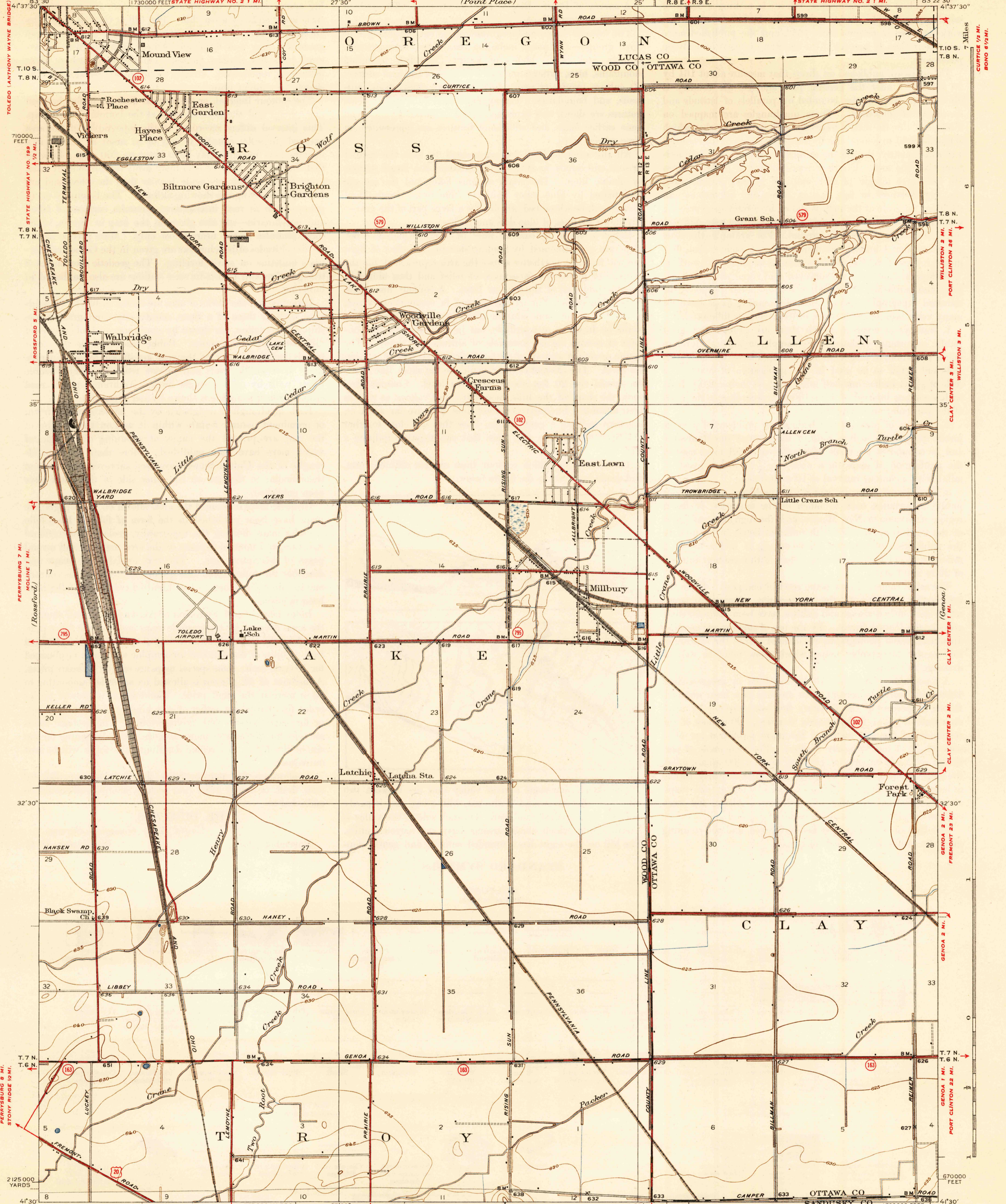

Topography by G.F. Westinghouse and R.L. Marx
Surveyed in 1935

Scale 1:50,000
1 Mile
5000 Feet

Polyconic projection, 1927 North American datum
5000 yard grid based on U.S. zone system, B
10000 foot grid based on Ohio (North)
rectangular coordinate system

WALBRIDGE, OHIO
Edition of 1938

12 UNITED STATES ROUTE NUMBER
12 STATE ROUTE NUMBER

Contour interval 5 feet
Datum is mean sea level

APPROXIMATE MEAN DECLINATION 1935