

U.S.G.S. FILE COPY  
Inspection and Editing.

TOLEDO (CHERRY STREET BRIDGE) 3 1/2 MI.  
UNITED STATES  
DEPARTMENT OF THE INTERIOR  
GEOLOGICAL SURVEY

OHIO  
WALBRIDGE QUADRANGLE  
SOUTH SHORE PARK 5 MI.  
BOOTH (STATE HIGHWAY NO. 2) 1 MI.  
R.8.E.4.R.9.E.  
STATE HIGHWAY NO. 2 1 MI.

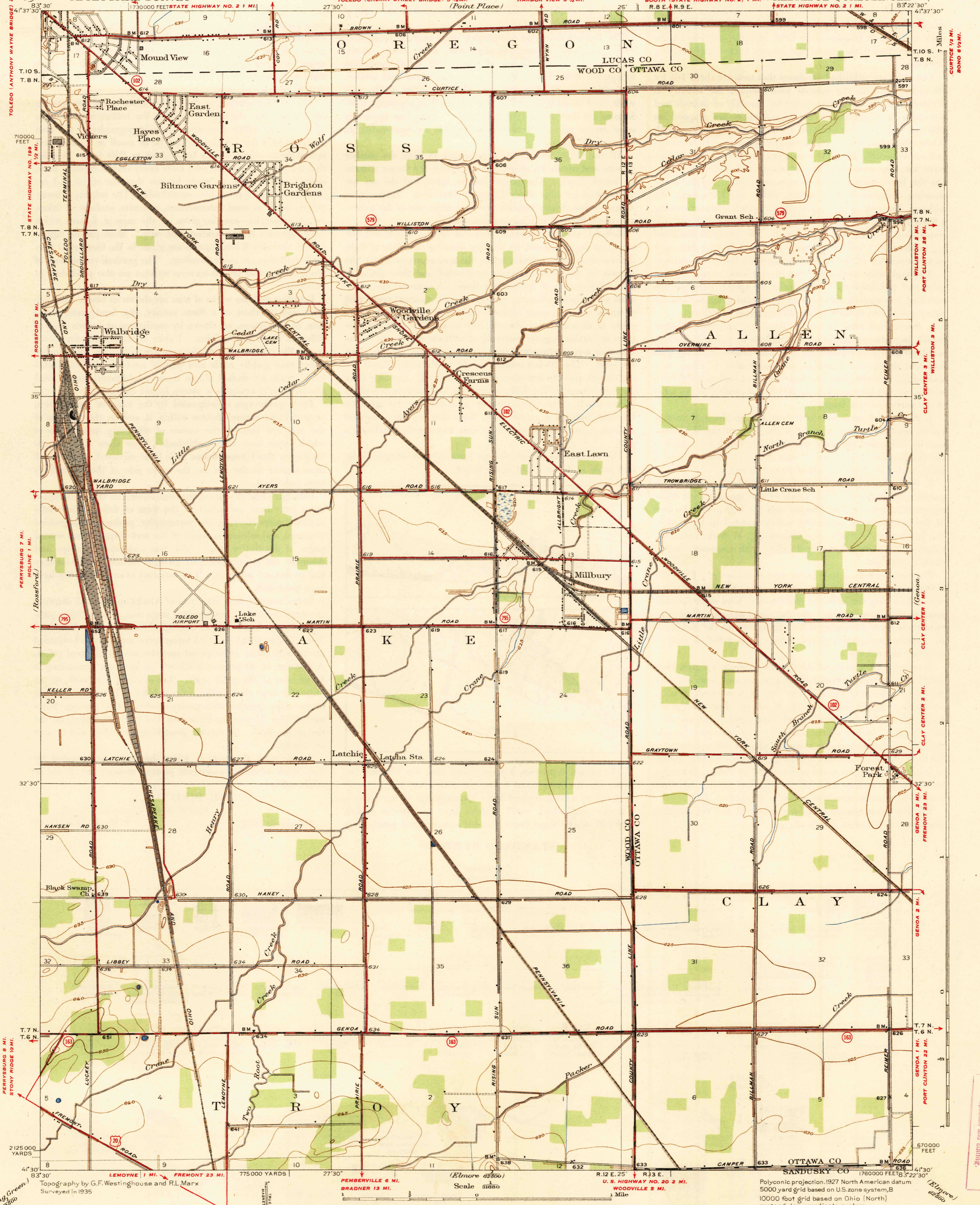

Topography by G.F. Westinghouse and R.L. Marx  
Surveyed in 1935

Scale 1:62,500  
1 Mile  
5000 2500 0 2500 5000 Feet  
Contour interval 5 feet  
Datum is mean sea level

Polyconic projection, 1927 North American datum  
5000 yard grid based on U.S. zone system, B  
10000 foot grid based on Ohio (North)  
rectangular coordinate system

USGS  
Historical File  
Topographic Division

12 UNITED STATES ROUTE NUMBER  
12 STATE ROUTE NUMBER

WALBRIDGE, OHIO  
Edition of 1938  
2645:1600/24:

U.S.G.S. FILE COPY  
Inspection and Editing.