

U. S. G. S.
FILE COPY
Inspection and Editing.

Part of Norman 15¹
S.W. corner

(Chickasha)

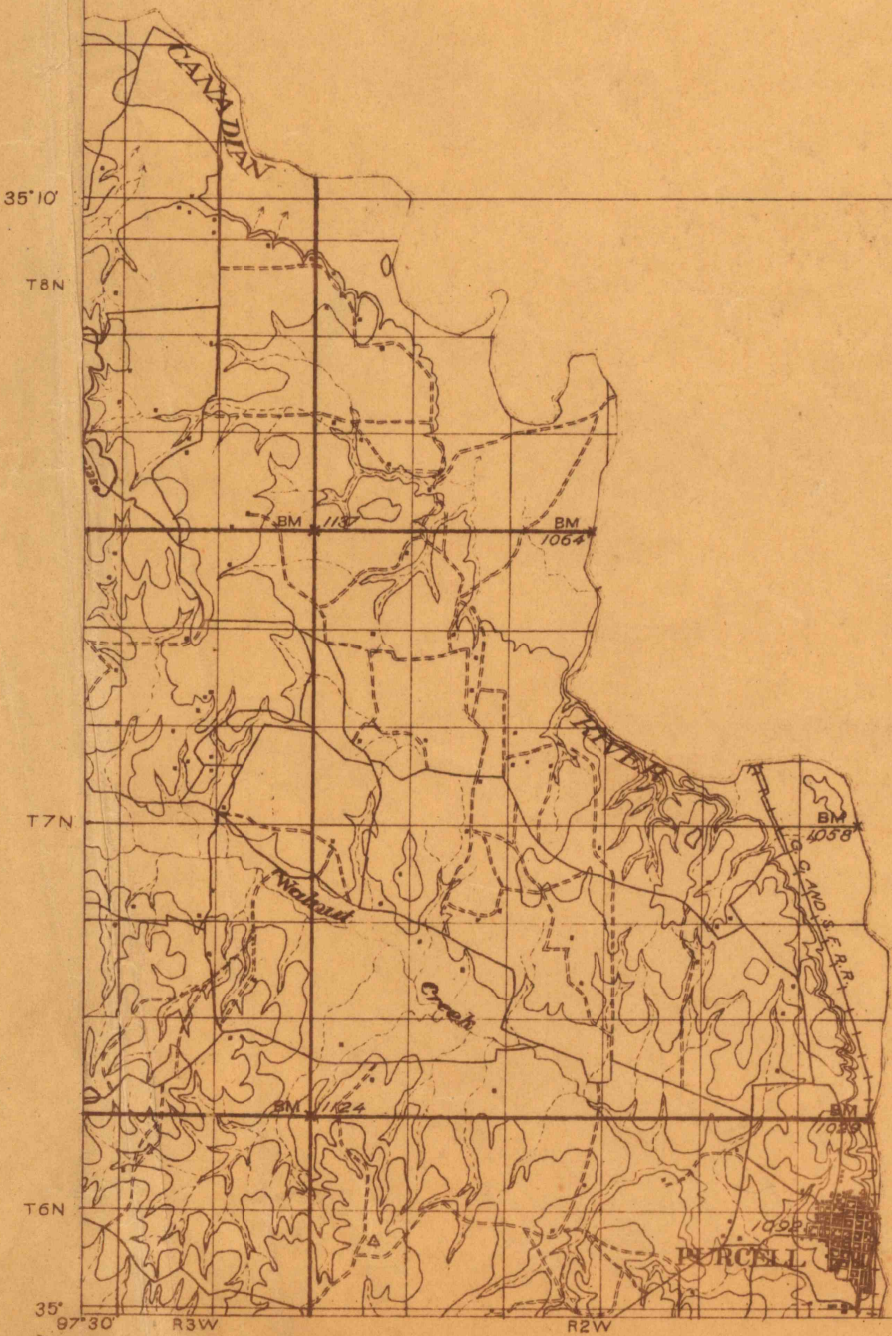

(Bash Springs)

C.H. Fitch, Topographer in charge.
Van H. Manning, Topographer, Assistant in charge.
Triangulation by C.F. Unquhart.
Topography by R.A. Farmer.
Surveyed in 1898.



COMPILED AND DRAWN BY R.H. SARGENT

USGS
Historical File
Topographic Division

Purcell, Okla.
NORMAN