

CLEAR LAKE QUADRANGLE  
OREGON  
7.5 MINUTE SERIES (TOPOGRAPHIC)

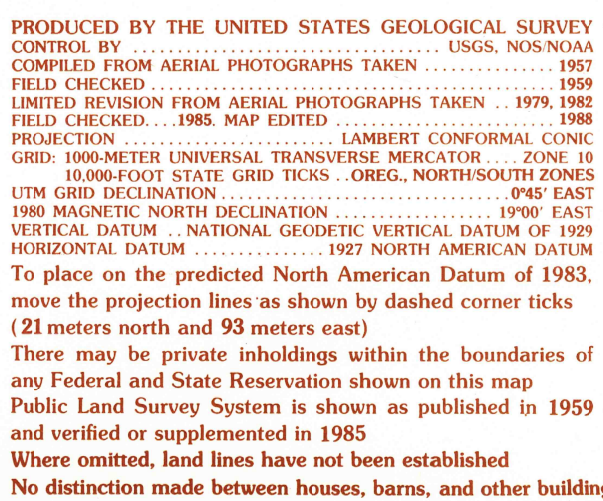

**SCALE 1:24 000**

The graphic scale bar is divided into four units: Kilometers, Meters, Miles, and Feet. The Kilometers scale ranges from 0 to 2, with major ticks every 1 kilometer and minor ticks every 0.5 kilometers. The Meters scale ranges from 0 to 1000, with major ticks every 1000 meters and minor ticks every 500 meters. The Miles scale ranges from 0 to 1, with major ticks every 1 mile and minor ticks every 0.5 miles. The Feet scale ranges from 0 to 10,000, with major ticks every 1000 feet and minor ticks every 500 feet.

**CONTOUR INTERVAL 40 FEET**

To convert meters to feet multiply by 3.2808  
To convert feet to meters multiply by 0.3048

**FOR SALE BY U. S. GEOLOGICAL SURVEY, DENVER, COLORADO 80225, OR RESTON, VIRGINIA 22092**

ADJOINING 7.5' QUADRANGLE NAMES

CLEAR LAKE, OREG.  
PROVISIONAL EDITION 1988

44121-C8-TF-024

USGS NMD HISTORICAL MAP.  
MAR 23 1969  
REC'D FILE COPY