

DEVILS PEAK QUADRANGLE
OREGON—KLAMATH CO.
7.5 MINUTE SERIES (TOPOGRAPHIC)

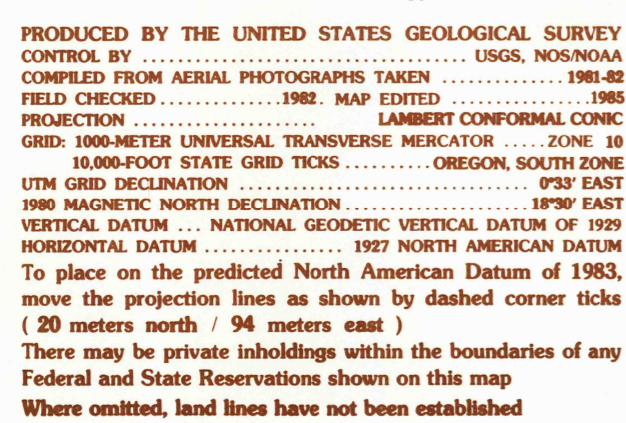

THIS MAP COMPLIES WITH NATIONAL MAP ACCURACY STANDARDS
FOR SALE BY U. S. GEOLOGICAL SURVEY, DENVER, COLORADO 80225, OR RESTON, VIRGINIA 22092

The diagram displays four horizontal number lines, each representing a different unit of length. The top line is labeled 'KILOMETERS' and ranges from 0 to 2, with major tick marks at 0, 1, and 2, and minor tick marks at 0.5. The second line is labeled 'METERS' and ranges from 0 to 2000, with major tick marks at 0, 1000, and 2000, and minor tick marks at 500. The third line is labeled 'MILES' and ranges from 0 to 1, with major tick marks at 0 and 1, and minor tick marks at 0.5. The bottom line is labeled 'FEET' and ranges from 0 to 10000, with major tick marks every 1000 units and minor tick marks every 500 units.

CONTROL ELEVATIONS SHOWN TO THE NEAREST 0.1 FOOT
OTHER ELEVATIONS SHOWN TO THE NEAREST FOOT

To convert meters to feet multiply by 3.2808
To convert feet to meters multiply by 0.3048

THIS MAP COMPLIES WITH NATIONAL MAP ACCURACY STANDARDS
FOR SALE BY U. S. GEOLOGICAL SURVEY, DENVER, COLORADO 80225, OR RESTON, VIRGINIA 22092

Improved Road.....
Unimproved Road.....
Trail.....

 Interstate Route  U.S. Route  State Route

DEVILS PEAK, OREG.
PROVISIONAL EDITION 1985

42122-F2-TF-024

RETURN TO:
USGS NHD HISTORICAL MAP ARCHIVES