

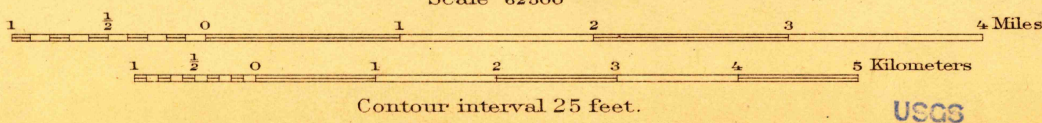

ENGRAVED 1917 BY U.S.G.S.
R. B. Marshall, Chief Geographer.
T. G. Gerdine, Geographer in charge.
Topography by C. L. Sadler, Fred Graff, Jr.
and S. G. Lunde.
Control by Corps of Engineers U.S. Army,
U.S. Coast and Geodetic Survey, L. F. Biggs,
and E. M. Bandli.
Surveyed in 1915.

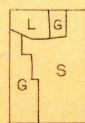

Contour interval 25 feet.
Datum is mean sea level.

USGS
Historical File
Topographic Division

APPROXIMATE MEAN
DECLINATION 1918.

Edition of 1918, reprinted 1920.

FEB 10 1921 2575.

HILLSBORO, OREG.-WASH.

U. S. G. S.
FILE COPY
Ed. Div. Topographic Maps.

HISTORICAL

2575