

124° 15' 43.45"

R. 12 W. (Siltcoos Lake)

R. 11 W. 124° 00' 43.45"

T. 21 S.  
15  
14  
13  
12  
11  
10  
9  
8  
7  
6  
5  
4  
3  
2  
1  
T. 22 S.  
T. 23 S.  
T. 24 S.

U. S. G. S.  
FILE COPY  
Inspection and Editing.

U. S. G. S.  
FILE COPY  
Inspection and Editing.



124° 15' R. 13 W. 715 000 YARDS ENGRAVED 1922 BY U.S.G.S.  
C.H. Birdseye, Chief Topographic Engineer.  
Geo. R. Davis, Division Topographic Engineer.  
Topography by C.A. Ecklund and Bishop Moorhead.  
Shore line by U.S. Coast and Geodetic Survey.  
Control by W.T. Griswold, F.J. McMaugh, and L.F. Biggs.  
Surveyed in 1919 and 1921.

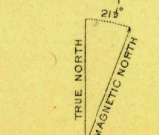
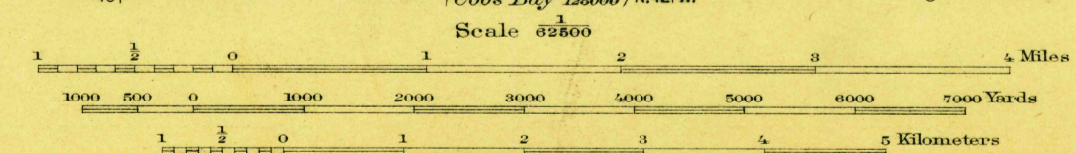
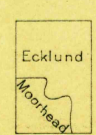

Polyconic projection. North American datum.  
5000 yard grid based upon U.S. zone system. G.  
Shore line is the margin of water at mean high tide, 6 feet above mean lower low water at Gardiner.

SURVEYED IN COOPERATION WITH THE WAR DEPARTMENT.

Contour interval 50 feet.  
Datum is mean sea level.

USGS  
Historical File  
Topographic Division  
JUL 10 1923  
3575

REEDSPORT, OREG.  
Edition of 1923.

3575