

CONTROLLED  
RECONNAISSANCE SHEET  
24-N-1-W/2

*with map of  
USSS in 1923*

WASHINGTON - OREGON  
ST. HELENS QUADRANGLE  
GRID ZONE "G"

CORPS OF ENGINEERS, U. S. ARMY  
TACTICAL MAP

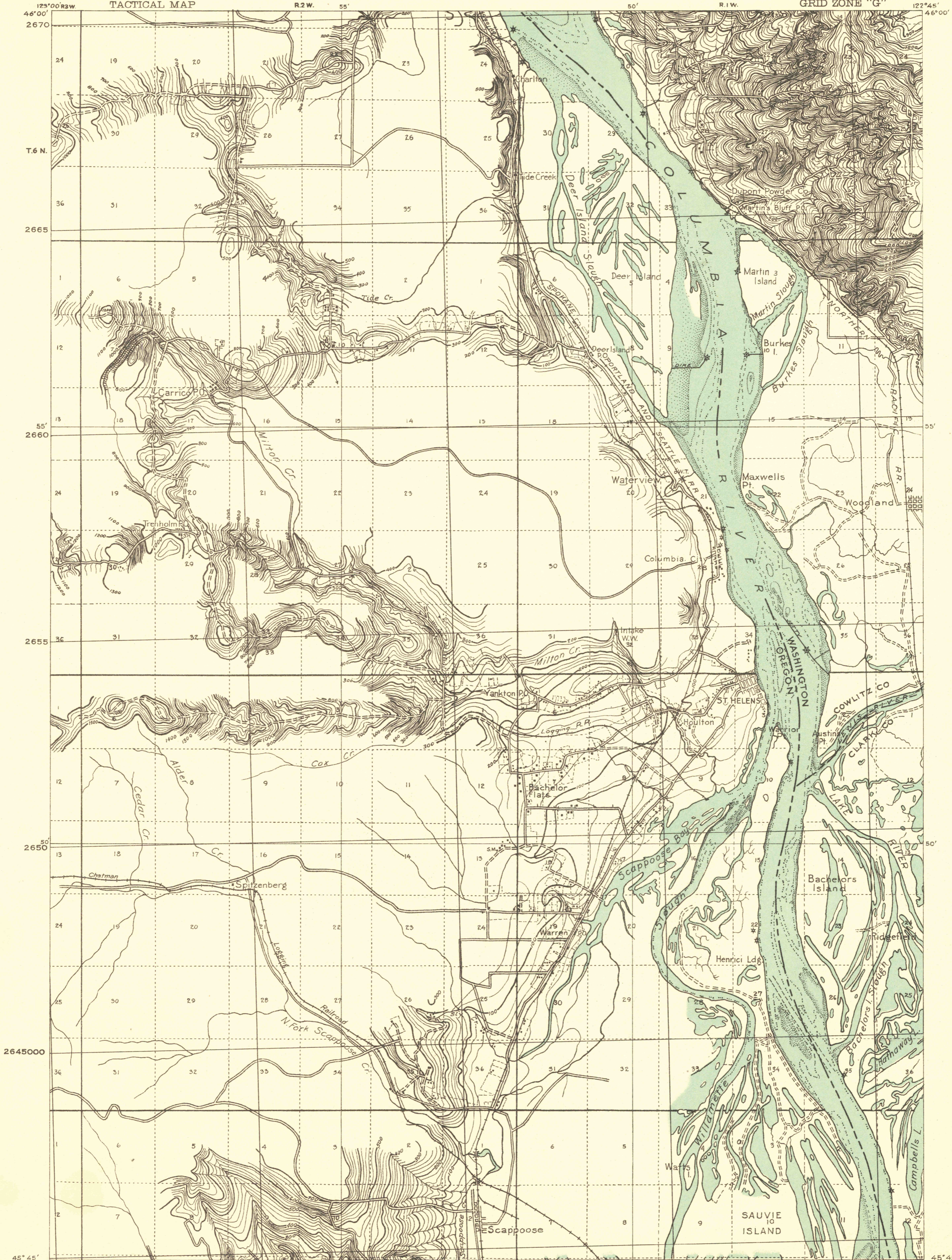

Compilation under the direction of Major A.R. Ehrnbeck,  
Corps of Engineers, U. S. A., Engineer, 9th Corps Area,  
1922.  
Military Surveys 1909. U. S. C. & G. Survey, S. P. & S.  
and N. P. R. R. Alignments, Columbia Co. Map.

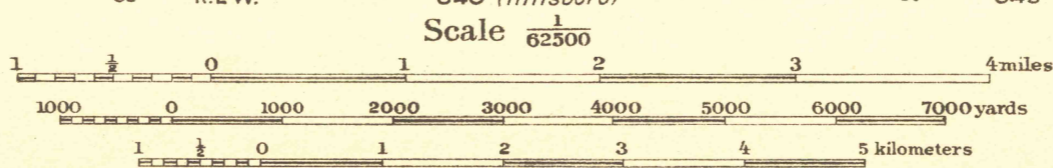

FIVE THOUSAND YARD GRID COMPUTED FROM "GRID SYSTEM FOR PROGRESSIVE MAPS  
IN THE U. S." ZONE C, U. S. C. & G. S. SPECIAL PUBLICATION NO. 59.  
(THE LAST THREE DIGITS OF THE GRID NUMBERS ARE OMITTED)

NOTE: OFFICERS USING THIS MAP WILL MARK HEREON CORRECTIONS AND ADDITIONS WHICH COME  
TO THEIR ATTENTION AND MAIL DIRECT TO "THE CHIEF OF ENGINEERS, WASHINGTON, D. C."

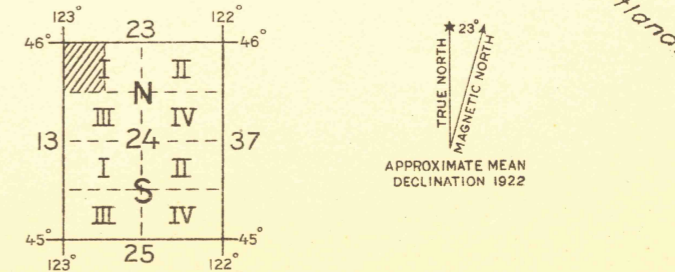

ST. HELENS, Ore.-Wash

Engineer Reproduction Plant, U. S. Army, Washington Barracks, D. C.  
1922

OREGON