

Mapped, edited, and published by the Geological Survey
Control by USGS, USC&GS, and Pennsylvania Department of Highways
Topography from aerial photographs by multiplex methods
Aerial photographs taken 1945. Field check 1948
Polyconic projection. 1927 North American datum
10,000-foot grid based on Pennsylvania coordinate system,
north zone
Civil division boundaries are indefinite
1000-meter Universal Transverse Mercator grid ticks,
zone 17, shown in blue
Revisions shown in purple compiled in cooperation with State of
Pennsylvania agencies from aerial photographs taken 1971. This
information not field checked

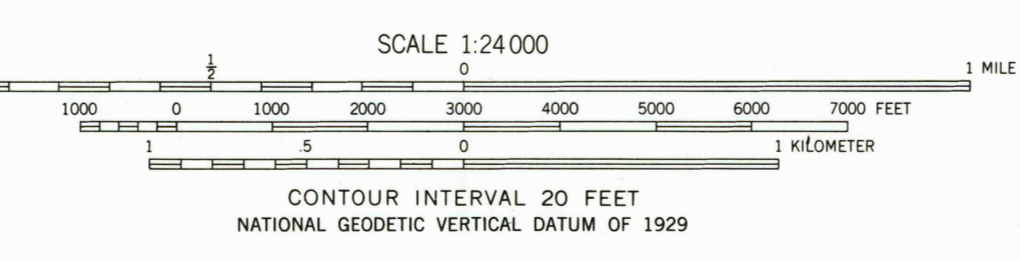

CONTOUR INTERVAL 20 FEET
NATIONAL GEODETIC VERTICAL DATUM OF 1929
THIS MAP COMPLIES WITH NATIONAL MAP ACCURACY STANDARDS
FOR SALE BY U.S. GEOLOGICAL SURVEY, P.O. BOX 25286, DENVER, COLORADO 80225
A FOLDER DESCRIBING TOPOGRAPHIC MAPS AND SYMBOLS IS AVAILABLE ON REQUEST

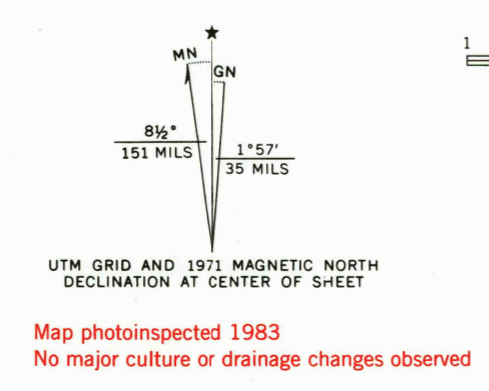
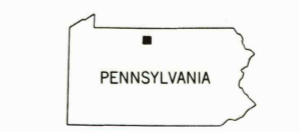

QUADRANGLE LOCATION
To place on the predicted North American Datum 1983,
move the projection lines 3 meters south and
23 meters west as shown by dashed corner ticks

ROAD CLASSIFICATION
HARD-SURFACE ALL WEATHER ROADS DRY WEATHER ROADS
Heavy-duty Improved dirt...
Medium-duty Unimproved dirt...
Loose-surface, graded, or narrow hard-surface...
U. S. Route State Route
APR 21 2002
AUSTIN, PA.
NE/4 EMPORIUM 15' QUADRANGLE
41078-F1-TF-024
PHOTOINSPECTED 1983
1948
PHOTOREVISED 1971
DMA 5367 II NE—SERIES V851

ISBN 040744002-4
9 780607 460025
USGS LIBRARY - RESTON
3 1818 00503366 5