

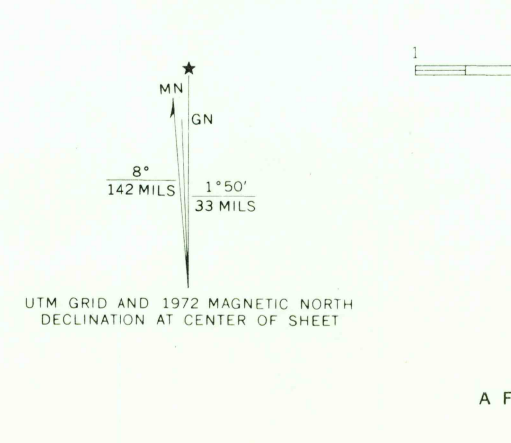

Mapped, edited, and published by the Geological Survey
Control by USGS and USC&GS
Topography by photogrammetric methods from aerial photographs
taken 1962. Field checked 1963
Polyconic projection. 1927 North American datum
10,000-foot grids based on Pennsylvania coordinate system,
south and north zones
1000 meter Universal Transverse Mercator grid ticks,
zone 18, shown in blue
Fine red dashed lines indicate selected fence and field lines where
generally visible on aerial photographs. This information is unchecked
Revisions shown in purple compiled in cooperation with
State of Pennsylvania agencies from aerial photographs
taken 1972. This information not field checked



SCALE 1:24,000
CONTOUR INTERVAL 20 FEET
DATUM IS MEAN SEA LEVEL
THIS MAP COMPLIES WITH NATIONAL MAP ACCURACY STANDARDS
FOR SALE BY U.S. GEOLOGICAL SURVEY, WASHINGTON, D.C. 20242
A FOLDER DESCRIBING TOPOGRAPHIC MAPS AND SYMBOLS IS AVAILABLE ON REQUEST

ROAD CLASSIFICATION
Heavy duty ——— Light duty ———
Medium duty - - - - - Unimproved dirt - - - - -
○ State Route

MC ALEVYS FORT, PA.
N4037.5—W7745.7.5
1963
PHOTOREVISED 1972
AMS 5465 III NE—SERIES V831

UTM GRID AND 1972 MAGNETIC NORTH DECLINATION AT CENTER OF SHEET

PENNSYLVANIA
QUADRANGLE LOCATION

5450